

SWITCHES

2026

BATTERY MAIN SWITCHES



F-N-R SWITCHES



TOGGLE SWITCHES



PUSH BUTTON SWITCHES



SNAP-ACTION SWITCHES



FOOT DIMMER SWITCHES





 **COBO** 

	pagina <i>page</i>
INTERRUTTORI STACCABATTERIA5 - 9
BATTERY MAIN SWITCHES	
DEVIATORI A LEVA10 - 19
TOGGLE SWITCHES	
DOPPI DEVIATORI A LEVA20 - 21
TWIN TOGGLE SWITCHES	
COMMUTATORI COMANDO SOLLEVATORE ELETTRONICO22 - 23
ELECTRIC LIFT CONTROL SWITCHES	
INTERRUTTORI A PULSANTE24 - 47
PUSH BUTTON SWITCHES	
INTERRUTTORI A SCATTO RAPIDO48 - 55
SNAP-ACTION SWITCHES	
COMMUTATORI A PEDALE56 - 58
FOOT DIMMER SWITCHES	
ACCESSORI60 - 63
ACCESSORIES	

SINGLE-POLE REMOTE CONTROL CURRENT ISOLATING ELECTRICAL BATTERY DISCONNECT SWITCH



Caratteristiche e vantaggi

- Corrente nominale continua di 250 A e corrente nominale di cortocircuito massima di 2000 A per 30 secondi, che consentono l'utilizzo in applicazioni ad alte correnti
- Sono disponibili diverse configurazioni con tensione nominale massima di 32 V CC o 16 V CC
- Il disconnettore della batteria a controllo remoto si attiva o disattiva tramite la chiave di accensione o un telecomando
- Protezione contro polvere, spruzzi d'acqua e getti ad alta pressione e temperatura secondo gli standard IP65, IPX4K e IPX9K
- Il relè della batteria è disponibile con disconnessione positiva, disconnessione negativa o entrambe
- Circuito unipolare a singola via (SPST)
- Le opzioni di tensione della bobina includono 12 V CC e 24 V CC
- Disponibile con contatto ausiliario

Features and Benefits

- Continuous current rating of 250 A and a maximum short-circuit current rating of 2000 A for 30 seconds, allowing for use in high-current applications.
- Various configurations are available with a maximum voltage rating of 32 V DC or 16 V DC.
- The remote-controlled battery disconnect is activated or deactivated via the ignition key or a remote control.
- Protection against dust, water splashes, and high-temperature, high-pressure jets according to IP65, IPX4K, and IPX9K standards.
- The battery relay is available with positive disconnect, negative disconnect, or both.
- Single-pole, single-throw (SPST) circuit.
- Coil voltage options include 12 V DC and 24 V DC.
- Available with auxiliary contact.

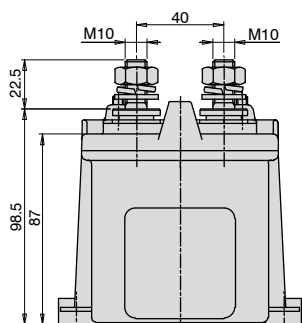
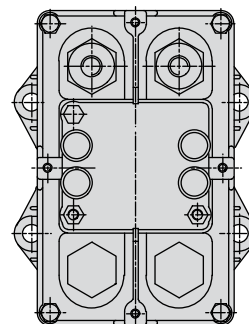
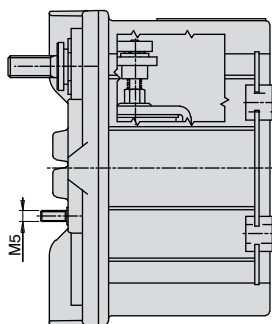
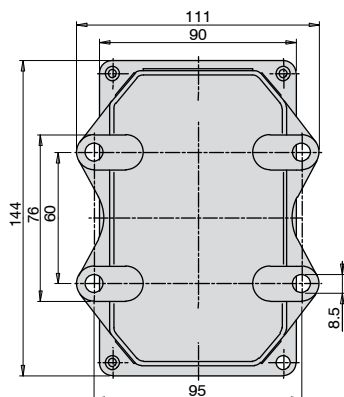

Schema Elettrico
Wiring diagram

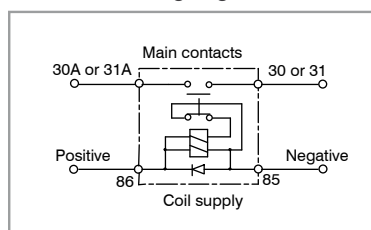

P/N	Q.ta Q.ty	TENSIONE NOMINALE NOMINAL VOLTAGE	CORRENTE CONTINUA DIRECT CURRENT	CIRCUITO CIRCUITRY	BOBINA DI STRAPPO TEAR COIL	BOBINA DI TENUTA SEAL COIL	CORRENTE DI PICCO PEAK CURRENT	RESISTENZA DI ISOLAMENTO INSULATION RESISTANCE	CADUTA DI TENSIONE VOLTAGE DROP	GRADO DI PROTEZIONE SEALING	TEMPERATURA DI FUNZIONAMENTO OPERATING TEMPERATURE
1020355 13-0013-0000	1	24 V	250 A	SPST	3.4 A	0.3 A	2000 A / 30s	10MΩ	<300 mV	IP 65	- 30° C ÷ + 65°C
1020357 13-0014-0000	1	12 V	250 A	SPST	4.4 A	0.4 A	2000 A / 30s	10MΩ	<300 mV	IP 65	- 30° C ÷ + 65°C

BATTERY MAIN SWITCHES

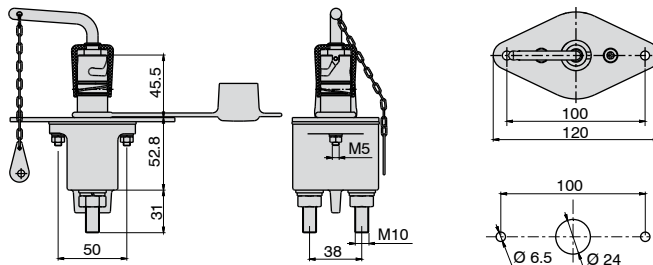

Schema Elettrico
Wiring diagram

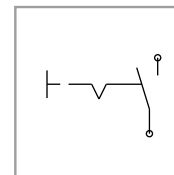

P/N	Q.ta Q.ty	TENSIONE NOMINALE NOMINAL VOLTAGE	CORRENTE CONTINUA DIRECT CURRENT	CONTATTO CADUTA TENSIONE CONTACT DROP IN VOLTAGE	CORRENTE DI PICCO PEAK CURRENT	GRADO DI PROTEZIONE SEALING	TEMPERATURA DI FUNZIONAMENTO OPERATING TEMPERATURE
1107779 1109495 13-0027-0000	1 20	12 - 24 V	250 A	≤ 120 mv	2500 A / 3s 1000 A / 30s	IP 65	- 40° C ÷ + 85°C

BATTERY MAIN SWITCHES | *single pole*

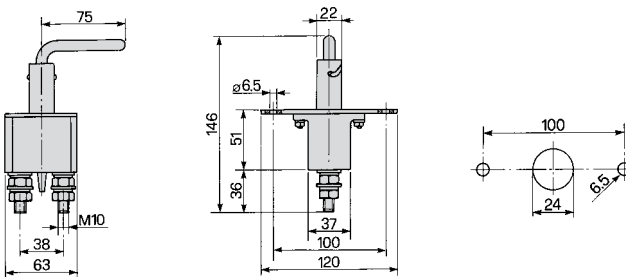

Schema Elettrico
Wiring diagram

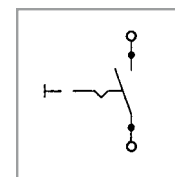

Leva estraibile, vedi accessori pag. 63 - Removable handle, see accessories page 63

P/N	Q.ta Q.ty	TENSIONE NOMINALE NOMINAL VOLTAGE	CORRENTE CONTINUA DIRECT CURRENT	CONTATTO CADUTA TENSIONE CONTACT DROP IN VOLTAGE	CORRENTE DI PICCO PEAK CURRENT	GRADO DI PROTEZIONE SEALING	TEMPERATURA DI FUNZIONAMENTO OPERATING TEMPERATURE
1091309 13-0002-0000	1	12 - 24 V	250 A	< 120 mv	2500 A / 3s 1000 A / 30s	IP 65	- 40° C ÷ + 85°C

BATTERY MAIN SWITCHES | *single pole*

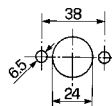
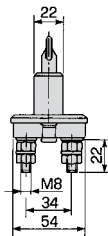
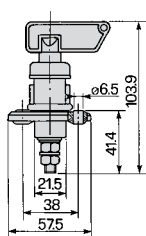

Schema Elettrico
Wiring diagram

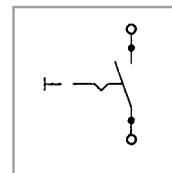

P/N	Q.ta Q.ty	TENSIONE NOMINALE NOMINAL VOLTAGE	CORRENTE CONTINUA DIRECT CURRENT	CONTATTO CADUTA TENSIONE CONTACT DROP IN VOLTAGE	CORRENTE DI PICCO PEAK CURRENT	GRADO DI PROTEZIONE SEALING	TEMPERATURA DI FUNZIONAMENTO OPERATING TEMPERATURE
1107781 1109493 13-0029-0000	1 80	12 - 24 V	100 A	≤ 120 mv	500 A / 30s	IP 43	- 40° C ÷ + 50°C

BATTERY MAIN SWITCHES | *single pole*

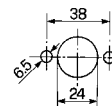
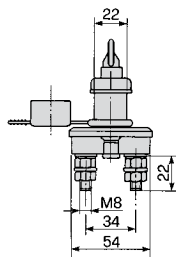
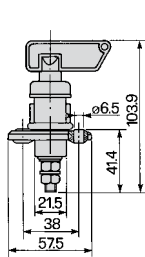

Schema Elettrico
Wiring diagram

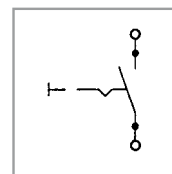

Leva estraibile, vedi accessori pag. 63 - Removable handle, see accessories page 63

P/N	Q.ta Q.ty	TENSIONE NOMINALE NOMINAL VOLTAGE	CORRENTE CONTINUA DIRECT CURRENT	CONTATTO CADUTA TENSIONE CONTACT DROP IN VOLTAGE	CORRENTE DI PICCO PEAK CURRENT	GRADO DI PROTEZIONE SEALING	TEMPERATURA DI FUNZIONAMENTO OPERATING TEMPERATURE
1107782 13-0030-0000	1	12 - 24 V	100 A	≤ 120 mv	500 A / 30s	IP 43	- 40° C ÷ + 50°C

BATTERY MAIN SWITCHES | *single pole*

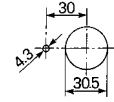
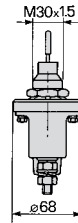
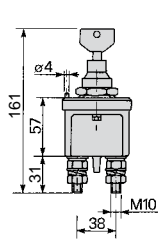

Schema Elettrico
Wiring diagram

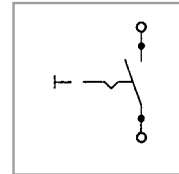

P/N	Q.ta Q.ty	TENSIONE NOMINALE NOMINAL VOLTAGE	CORRENTE CONTINUA DIRECT CURRENT	CONTATTO CADUTA TENSIONE CONTACT DROP IN VOLTAGE	CORRENTE DI PICCO PEAK CURRENT	GRADO DI PROTEZIONE SEALING	TEMPERATURA DI FUNZIONAMENTO OPERATING TEMPERATURE
1110414 13-0031-0000	1	12 - 24 V	250 A	≤ 120 mv	2500 A / 3s 1000 A / 30s	IP 65	- 40° C ÷ + 85°C

BATTERY MAIN SWITCHES | *single pole*

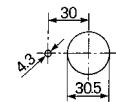
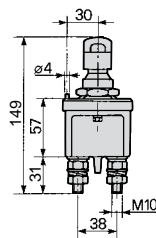
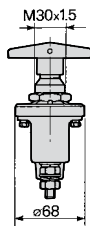

Schema Elettrico
Wiring diagram

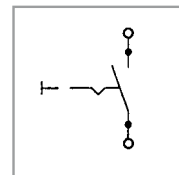

P/N	Q.ta Q.ty	TENSIONE NOMINALE NOMINAL VOLTAGE	CORRENTE CONTINUA DIRECT CURRENT	CONTATTO CADUTA TENSIONE CONTACT DROP IN VOLTAGE	CORRENTE DI PICCO PEAK CURRENT	GRADO DI PROTEZIONE SEALING	TEMPERATURA DI FUNZIONAMENTO OPERATING TEMPERATURE
1107780 1109494 13-0028-0000	1 20	12 - 24 V	250 A	≤ 120 mv	2500 A / 3s 1000 A / 40s	IP 65	- 40° C ÷ + 85°C

MASTER CURRENT SWITCH

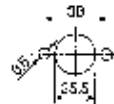
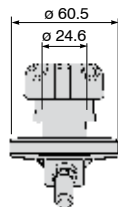
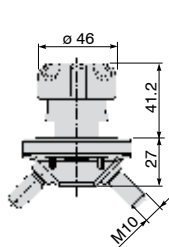

Schema Elettrico
Wiring diagram

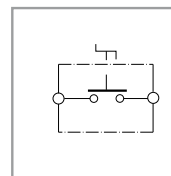

P/N	Q.ta Q.ty	TENSIONE NOMINALE NOMINAL VOLTAGE	CORRENTE CONTINUA DIRECT CURRENT	CONTATTO CADUTA TENSIONE CONTACT DROP IN VOLTAGE	CORRENTE DI PICCO PEAK CURRENT	GRADO DI PROTEZIONE SEALING	TEMPERATURA DI FUNZIONAMENTO OPERATING TEMPERATURE
1020363 13-0017-0000	1	12 - 24 V	150 A	-	1200 A / 5s	IP 65	- 30° C ÷ + 60°C

BATTERY MAIN SWITCHES HEAVY DUTY

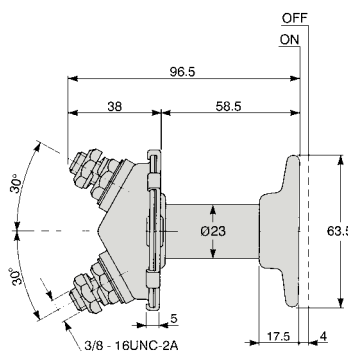
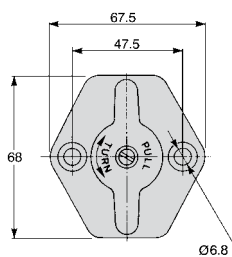

Schema Elettrico
Wiring diagram

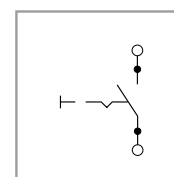

P/N	Q.ta Q.ty	TENSIONE MAX DI ESERCIZIO MAX OPERATING VOLTAGE	CORRENTE INDUTTIVA MAX MAX INDUCTIVE CURRENT	CORRENTE RESISTIVA MAX MAX RESISTIVE CURRENT	GRADO DI PROTEZIONE SEALING	VERSIONE SCRITTA IN INGLESE WRITTEN VERSION IN ENGLISH
1001884 0M56276000	1	30 V	150 A	300 A	IP 67	PULL TURN

F-N-R SWITCHES | REED TECHNOLOGY

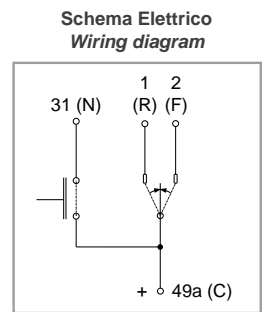
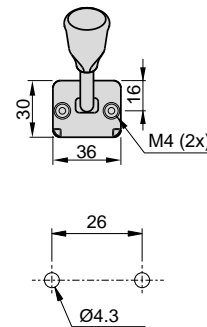
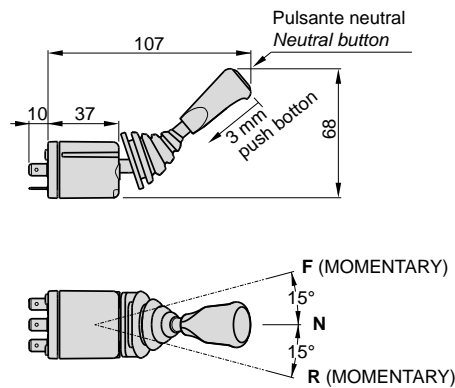

P/N	Q.ta Q.ty	TENS. NOMINALE NOMINAL VOLTAGE	CARICHI ELETTRICI ELECTRICAL LOAD	N° CICLI N° LIFE CYCLES	N° CONTATTI N° CONTACTS	GRADO DI PROT. SEALING	TEMP. DI FUNZ. OPERATING TEMP.	FUNZIONI FUNCTIONS
1095276	1	12 V	Pulsante: 4,5 A induttivi Button: 4,5 A inductive	500.000	5	IP 20	- 40° C ÷ + 85° C	F Marcia avanti - Forward gear N Neutro- Neutral R Marcia indietro - Reverse gear
1095277 15-0191-0000	35	12 V - 24 V - 48 V	Uscita F-R: 500 mA induttivi Pin Out F-R: 500 mA inductive	500.000	5	IP 20	- 40° C ÷ + 85° C	

TOGGLE SWITCHES | a tre linee / three-line

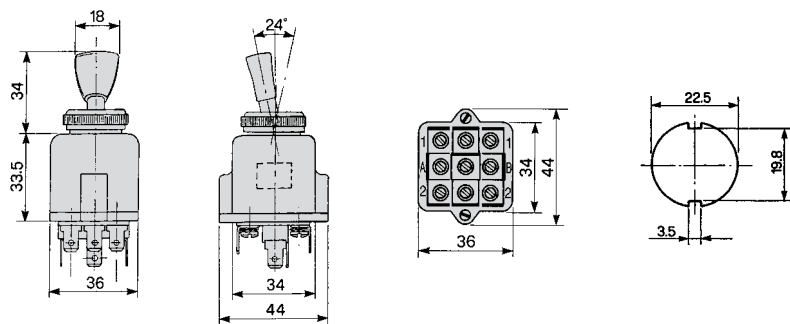

Schema Elettrico
Wiring diagram

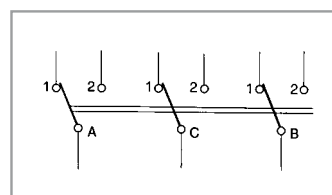

P/N	Q.ta Q.ty	TENS. NOMINALE NOMINAL VOLTAGE	CORRENTE MAX MAX CURRENT	N° CICLI N° LIFE CYCLES	N° CONTATTI N° CONTACTS	GRADO DI PROT. SEALING	TEMP. DI FUNZ. OPERATING TEMP.	FUNZIONI FUNCTIONS
1023912 16-214-000	2	12 V	8,5 A induttivi / inductive	-	6	IP 53	- 20° C ÷ + 40° C	
		24 V	5 A induttivi / inductive	-	6	IP 53	- 20° C ÷ + 40° C	

TOGGLE SWITCHES

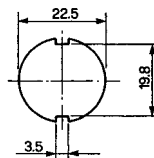
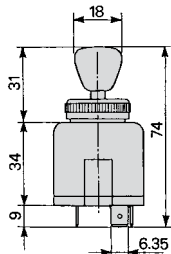

Schema Elettrico
Wiring diagram

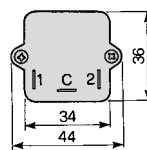
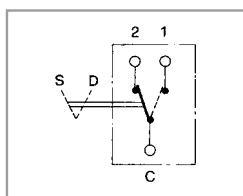

P/N	Q.ta Q.ty	TENS. NOMINALE NOMINAL VOLTAGE	CORRENTE MAX MAX CURRENT	N° CICLI N° LIFE CYCLES	N° CONTATTI N° CONTACTS	GRADO DI PROT. SEALING	TEMP. DI FUNZ. OPERATING TEMP.	FUNZIONI FUNCTIONS
1021520 15-112-000	1	12 V	8,5 A induttivi / inductive	50.000	3	IP 53	- 20° C ÷ + 40°C	↔
		24 V	5 A induttivi / inductive	50.000	3	IP 53	- 20° C ÷ + 40°C	

Schema Elettrico
Wiring diagram

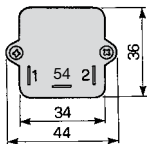
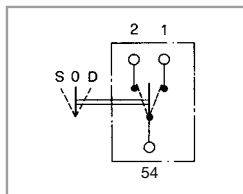

P/N	Q.ta Q.ty	TENS. NOMINALE NOMINAL VOLTAGE	CORRENTE MAX MAX CURRENT	N° CICLI N° LIFE CYCLES	N° CONTATTI N° CONTACTS	GRADO DI PROT. SEALING	TEMP. DI FUNZ. OPERATING TEMP.	FUNZIONI FUNCTIONS
1021517 1021518 15-111-000	1 50	12 V	8,5 A induttivi / inductive	50.000	3	IP 53	- 20° C ÷ + 40°C	↔
		24 V	5 A induttivi / inductive	50.000	3	IP 53	- 20° C ÷ + 40°C	

Schema Elettrico
Wiring diagram

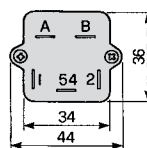
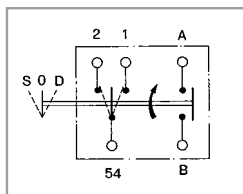

P/N	Q.ta Q.ty	TENS. NOMINALE NOMINAL VOLTAGE	CORRENTE MAX MAX CURRENT	N° CICLI N° LIFE CYCLES	N° CONTATTI N° CONTACTS	GRADO DI PROT. SEALING	TEMP. DI FUNZ. OPERATING TEMP.	FUNZIONI FUNCTIONS
1021523 15-113-000	1	12 V	8,5 A induttivi / inductive	-	5	IP 53	- 20° C ÷ + 40°C	↔ ☰
		24 V	5 A induttivi / inductive	-	5	IP 53	- 20° C ÷ + 40°C	

TOGGLE SWITCHES

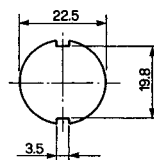
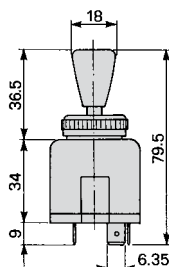

Schema Elettrico
Wiring diagram

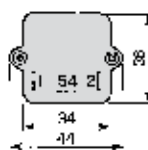
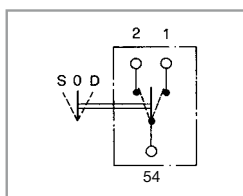

P/N	Q.ta Q.ty	TENS. NOMINALE NOMINAL VOLTAGE	CORRENTE MAX MAX CURRENT	N° CICLI N° LIFE CYCLES	N° CONTATTI N° CONTACTS	GRADO DI PROT. SEALING	TEMP. DI FUNZ. OPERATING TEMP.	FUNZIONI FUNCTIONS
1021472 15-0162-0000	50	12 V	8,5 A induttivi / <i>inductive</i>	-	3	IP 53	- 20° C ÷ + 40°C	↔
		24 V	5 A induttivi / <i>inductive</i>	-	3	IP 53	- 20° C ÷ + 40°C	

Schema Elettrico
Wiring diagram

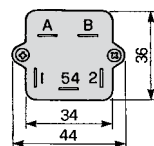
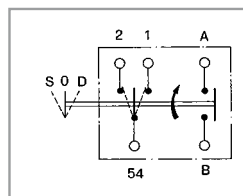

P/N	Q.ta Q.ty	TENS. NOMINALE NOMINAL VOLTAGE	CORRENTE MAX MAX CURRENT	N° CICLI N° LIFE CYCLES	N° CONTATTI N° CONTACTS	GRADO DI PROT. SEALING	TEMP. DI FUNZ. OPERATING TEMP.	FUNZIONI FUNCTIONS
1021525	1	12 V	8,5 A induttivi / <i>inductive</i>	-	5	IP 53	- 20° C ÷ + 40°C	↔
1021526 15-115-000	50	24 V	5 A induttivi / <i>inductive</i>	-	5	IP 53	- 20° C ÷ + 40°C	

TOGGLE SWITCHES

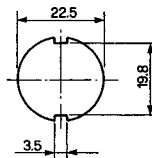
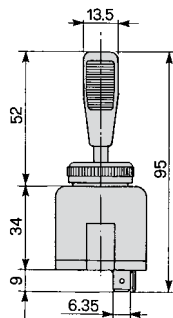

Schema Elettrico
Wiring diagram

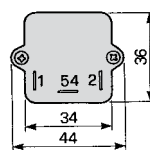
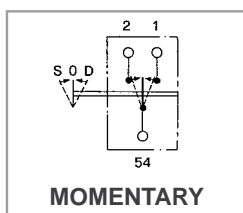

P/N	Q.ta Q.ty	TENS. NOMINALE NOMINAL VOLTAGE	CORRENTE MAX MAX CURRENT	N° CICLI N° LIFE CYCLES	N° CONTATTI N° CONTACTS	GRADO DI PROT. SEALING	TEMP. DI FUNZ. OPERATING TEMP.	FUNZIONI FUNCTIONS
1021512 15-107-000	1	12 V	8,5 A induttivi / inductive	50.000	3	IP 53	- 20° C ÷ + 40°C	↔
		24 V	5 A induttivi / inductive	50.000	3	IP 53	- 20° C ÷ + 40°C	

Schema Elettrico
Wiring diagram

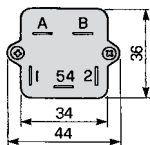
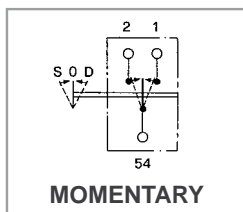

P/N	Q.ta Q.ty	TENS. NOMINALE NOMINAL VOLTAGE	CORRENTE MAX MAX CURRENT	N° CICLI N° LIFE CYCLES	N° CONTATTI N° CONTACTS	GRADO DI PROT. SEALING	TEMP. DI FUNZ. OPERATING TEMP.	FUNZIONI FUNCTIONS
1021528 15-116-000	1	12 V	8,5 A induttivi / inductive	50.000	5	IP 53	- 20° C ÷ + 40°C	← ritorno automatico in posizione 0 automatic return to position 0
		24 V	5 A induttivi / inductive	50.000	5	IP 53	- 20° C ÷ + 40°C	

Schema Elettrico
Wiring diagram

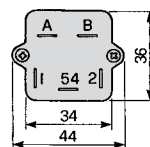
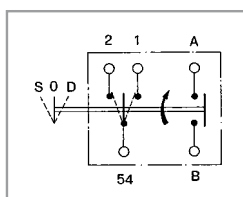

P/N	Q.ta Q.ty	TENS. NOMINALE NOMINAL VOLTAGE	CORRENTE MAX MAX CURRENT	N° CICLI N° LIFE CYCLES	N° CONTATTI N° CONTACTS	GRADO DI PROT. SEALING	TEMP. DI FUNZ. OPERATING TEMP.	FUNZIONI FUNCTIONS
1021502 1021503 15-104-000	1	12 V	8,5 A induttivi / inductive	-	5	IP 53	- 20° C ÷ + 40°C	↔ ⇄
	50	24 V	5 A induttivi / inductive	-	5	IP 53	- 20° C ÷ + 40°C	

TOGGLE SWITCHES

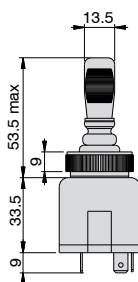
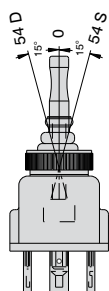

Type A

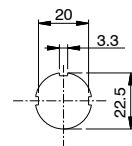
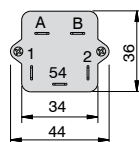

Schema Elettrico
Wiring diagram

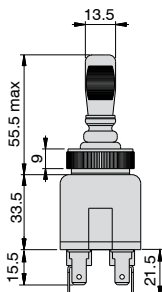
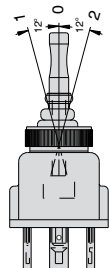
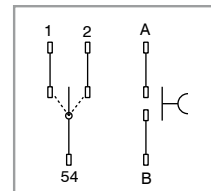

Type B

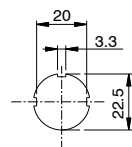
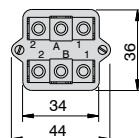

Schema Elettrico
Wiring diagram

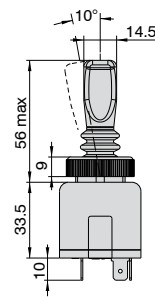
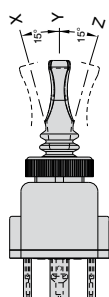
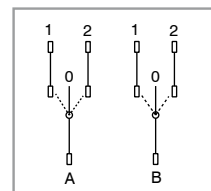

Type C

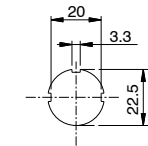
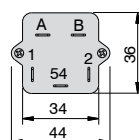

Schema Elettrico
Wiring diagram

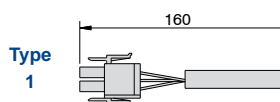
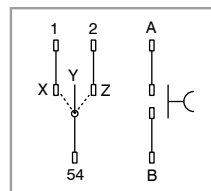

MALE CONNECTOR UNIVERSAL 6 pins

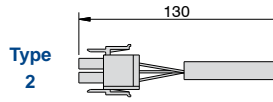

MALE CONNECTOR UNIVERSAL 6 pins

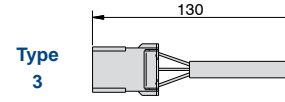

CONNECTOR AMP MULTILOCK 6 pins

P/N	Q.ta Q.ty	TYPE	TENS. NOMINALE NOMINAL VOLTAGE	CORRENTE MAX MAX CURRENT	N° CONTATTI N° CONTACTS	GRADO DI PROT. SEALING	TEMP. DI FUNZ. OPERATING TEMP.	TYPE CONNESSIONE CONNECTION TYPE	FUNZIONI FUNCTIONS
1021576 15-144-000	1	A	12 V	8,5 A induttivi / inductive	5	IP 55	-20° C ÷ +40° C	1	↔ ↻
			24 V	5 A induttivi / inductive	5	IP 55	-20° C ÷ +40° C		
1021579 15-145-000	1	B	12 V	8,5 A induttivi / inductive	6	IP 55	-20° C ÷ +40° C	2	↔ ↻
			24 V	5 A induttivi / inductive	6	IP 55	-20° C ÷ +40° C		
1021484 1021485 15-0172-0000	1	C	12 V	8,5 A induttivi / inductive	5	IP 55	-20° C ÷ +40° C	3	↔ ↻
	50		24 V	5 A induttivi / inductive	5	IP 55	-20° C ÷ +40° C		

TOGGLE SWITCHES

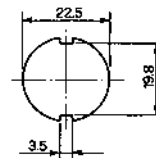
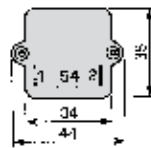
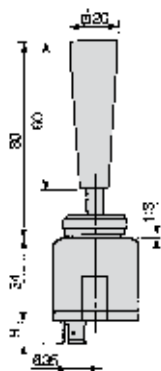

Schema Elettrico
Wiring diagram

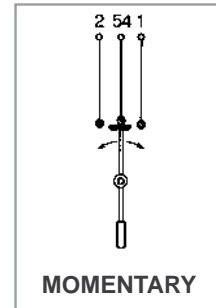

P/N	Q.ta Q.ty	TENS. NOMINALE NOMINAL VOLTAGE	CORRENTE MAX MAX CURRENT	N° CICLI N° LIFE CYCLES	N° CONTATTI N° CONTACTS	GRADO DI PROT. SEALING	TEMP. DI FUNZ. OPERATING TEMP.	FUNZIONI FUNCTIONS
1021602 15-155-000	4	12 V	8,5 A induttivi / inductive	50.000	3	IP 53	-20° C ÷ +40°C	
		24 V	5 A induttivi / inductive	50.000	3	IP 53	-20° C ÷ +40°C	

TOGGLE SWITCHES

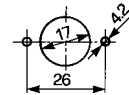
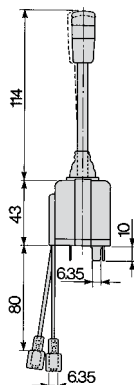

Schema Elettrico
Wiring diagram

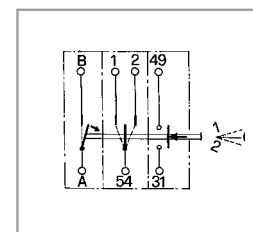

P/N	Q.ta Q.ty	TENS. NOMINALE NOMINAL VOLTAGE	CORRENTE MAX MAX CURRENT	N° CICLI N° LIFE CYCLES	N° CONTATTI N° CONTACTS	GRADO DI PROT. SEALING	TEMP. DI FUNZ. OPERATING TEMP.	FUNZIONI FUNCTIONS
1021538 15-121-000	5	12 V	8,5 A induttivi / inductive	-	5	IP 53	-20° C ÷ +40°C	
		24 V	5 A induttivi / inductive	-	5	IP 53	-20° C ÷ +40°C	

TOGGLE SWITCHES

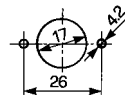
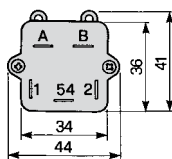
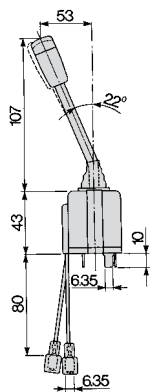

Schema Elettrico
Wiring diagram

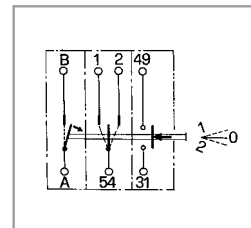

P/N	Q.ta Q.ty	TENS. NOMINALE NOMINAL VOLTAGE	CORRENTE MAX MAX CURRENT	N° CICLI N° LIFE CYCLES	N° CONTATTI N° CONTACTS	GRADO DI PROT. SEALING	TEMP. DI FUNZ. OPERATING TEMP.	FUNZIONI FUNCTIONS
1021536 15-119-000	4	12 V	8,5 A induttivi / inductive	50.000	5	IP 53	- 20° C ÷ + 40° C	
		24 V	5 A induttivi / inductive	50.000	5	IP 53	- 20° C ÷ + 40° C	

TOGGLE SWITCHES

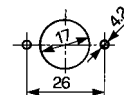
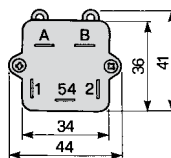
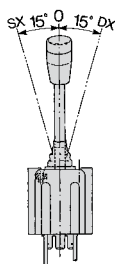
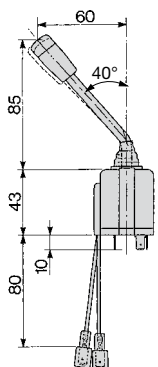

Schema Elettrico
Wiring diagram

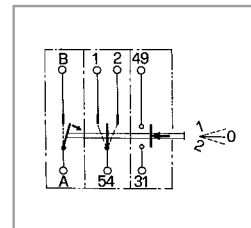

P/N	Q.ta Q.ty	TENS. NOMINALE NOMINAL VOLTAGE	CORRENTE MAX MAX CURRENT	N° CICLI N° LIFE CYCLES	N° CONTATTI N° CONTACTS	GRADO DI PROT. SEALING	TEMP. DI FUNZ. OPERATING TEMP.	FUNZIONI FUNCTIONS
1021557 15-131-000	4	12 V	8,5 A induttivi / inductive	50.000	5	IP 53	- 20° C ÷ + 40° C	
		24 V	5 A induttivi / inductive	50.000	5	IP 53	- 20° C ÷ + 40° C	

TOGGLE SWITCHES

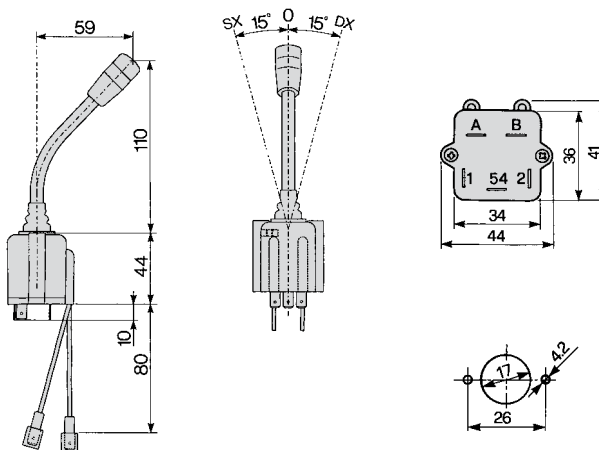

Schema Elettrico
Wiring diagram

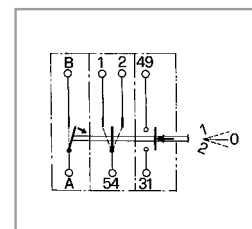

P/N	Q.ta Q.ty	TENS. NOMINALE NOMINAL VOLTAGE	CORRENTE MAX MAX CURRENT	N° CICLI N° LIFE CYCLES	N° CONTATTI N° CONTACTS	GRADO DI PROT. SEALING	TEMP. DI FUNZ. OPERATING TEMP.	FUNZIONI FUNCTIONS
1021483 15-0171-0000	30	12 V	8,5 A induttivi / inductive	50.000	5	IP 53	- 20° C ÷ + 40°C	
		24 V	5 A induttivi / inductive	50.000	5	IP 53	- 20° C ÷ + 40°C	

TOGGLE SWITCHES

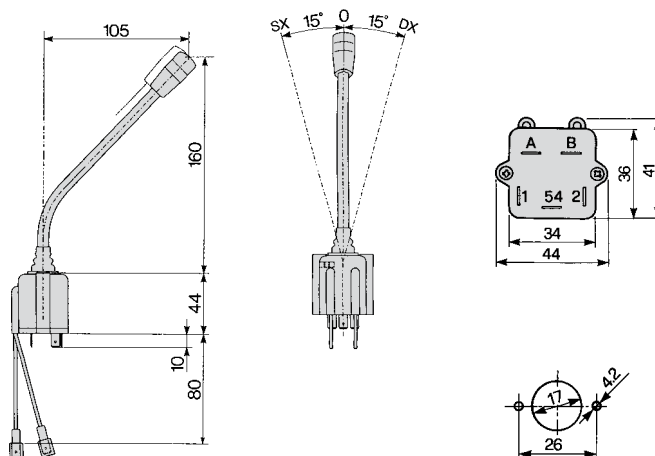

Schema Elettrico
Wiring diagram

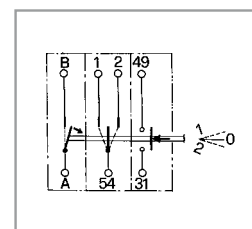

P/N	Q.ta Q.ty	TENS. NOMINALE NOMINAL VOLTAGE	CORRENTE MAX MAX CURRENT	N° CICLI N° LIFE CYCLES	N° CONTATTI N° CONTACTS	GRADO DI PROT. SEALING	TEMP. DI FUNZ. OPERATING TEMP.	FUNZIONI FUNCTIONS
1021569 15-137-000	1	12 V	8,5 A induttivi / inductive	50.000	3	IP 53	- 20° C ÷ + 40°C	
		24 V	5 A induttivi / inductive	50.000	3	IP 53	- 20° C ÷ + 40°C	

TOGGLE SWITCHES / CHANGEOVER SWITCHES / SWITCHES

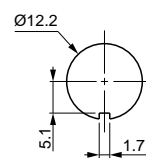
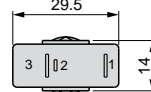
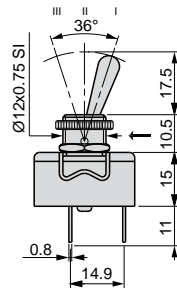

Schema Elettrico
Wiring diagram

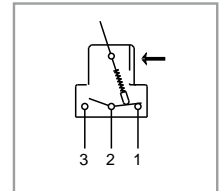

Coppia di serraggio - Tightening torque: 1.50 Nm
Max spessore pannello - Max panel thickness: 4.5 mm

P/N	Q.ta Q.ty	DESCRIZIONE DESCRIPTION	TENS. NOMINALE NOMINAL VOLTAGE	CORRENTE MAX MAX CURRENT	N° CICLI N° LIFE CYCLES	N° CONTATTI N° CONTACTS	GRADO DI PROT. SEALING	TEMP. DI FUNZ. OPERATING TEMP.
1030261 30-34-10300	1	Commutatore a 1 posizione Insatabile ON-OFF	12 V	10 A resistivi / resistive	10.000	2	IP 53	- 20° C ÷ + 40°C
		1-position changeover switch Momentary ON-OFF	24 V	5 A resistivi / resistive	10.000	2	IP 53	- 20° C ÷ + 40°C
1030250 30-34-08956	1	Interruttore ON-OFF	12 V	10 A resistivi / resistive	10.000	2	IP 53	- 20° C ÷ + 40°C
		ON-OFF Switch	24 V	5 A resistivi / resistive	10.000	2	IP 53	- 20° C ÷ + 40°C

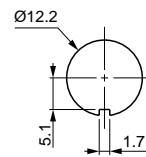
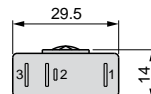
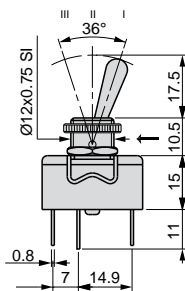

Schema Elettrico
Wiring diagram

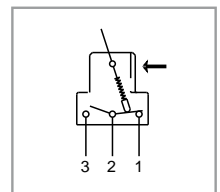

Coppia di serraggio - Tightening torque: 1.50 Nm
Max spessore pannello - Max panel thickness: 4.5 mm

P/N	Q.ta Q.ty	DESCRIZIONE DESCRIPTION	TENS. NOMINALE NOMINAL VOLTAGE	CORRENTE MAX MAX CURRENT	N° CICLI N° LIFE CYCLES	N° CONTATTI N° CONTACTS	GRADO DI PROT. SEALING	TEMP. DI FUNZ. OPERATING TEMP.
1030262 30-34-10301	1	Deviatore ON-ON	12 V	10 A resistivi / resistive	10.000	3	IP 53	- 20° C ÷ + 40°C
		Toggle Switch ON-ON	24 V	5 A resistivi / resistive	10.000	3	IP 53	- 20° C ÷ + 40°C
1030263 30-34-10302	1	Commutatore ON-OFF-ON	12 V	10 A resistivi / resistive	10.000	3	IP 53	- 20° C ÷ + 40°C
		Changeover Switch ON-OFF-ON	24 V	5 A resistivi / resistive	10.000	3	IP 53	- 20° C ÷ + 40°C
1030251 30-34-08957	1	Interruttore a 2 posizioni Insatabile ON-OFF-ON	12 V	10 A resistivi / resistive	10.000	3	IP 53	- 20° C ÷ + 40°C
		2-position Switch Momentary ON-OFF-ON	24 V	5 A resistivi / resistive	10.000	3	IP 53	- 20° C ÷ + 40°C

TOGGLE SWITCHES / CHANGEOVER SWITCHES / SWITCHES

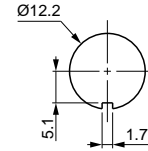
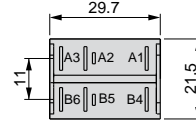
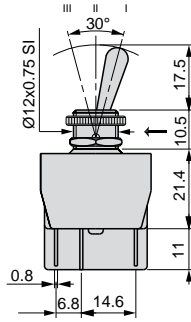

Schema Elettrico
Wiring diagram

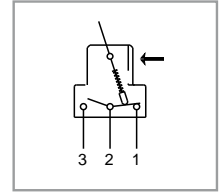

Coppia di serraggio - Tightening torque: 1.50 Nm
Max spessore pannello - Max panel thickness: 4.5 mm

P/N	Q.ta Q. ty	DESCRIZIONE DESCRIPTION	TENS. NOMINALE NOMINAL VOLTAGE	CORRENTE MAX MAX CURRENT	N° CICLI N° LIFE CYCLES	N° CONTATTI N° CONTACTS	GRADO DI PROT. SEALING	TEMP. DI FUNZ. OPERATING TEMP.
1030264 30-34-10303	1	Deviatore ON-ON Toggle Switch ON-ON	12 V	10 A resistivi / resistive	10.000	6	IP 53	- 20° C ÷ + 40°C
			24 V	5 A resistivi / resistive	10.000	6	IP 53	- 20° C ÷ + 40°C
1030265 30-34-10304	1	Commutatore a 2 posizioni Insatabile ON-OFF-ON 2-positions changeover switch Momentary ON-OFF-ON	12 V	10 A resistivi / resistive	10.000	6	IP 53	- 20° C ÷ + 40°C
			24 V	5 A resistivi / resistive	10.000	6	IP 53	- 20° C ÷ + 40°C
1030266 30-34-10305	1	Commutatore a 1 posizione Insatabile ON-OFF-ON 1-position changeover switch Momentary ON-OFF-ON	12 V	10 A resistivi / resistive	10.000	6	IP 53	- 20° C ÷ + 40°C
			24 V	5 A resistivi / resistive	10.000	6	IP 53	- 20° C ÷ + 40°C
1030267 30-34-10306	1	Commutatore ON-OFF-ON Changeover Switch ON-OFF-ON	12 V	10 A resistivi / resistive	10.000	6	IP 53	- 20° C ÷ + 40°C
			24 V	5 A resistivi / resistive	10.000	6	IP 53	- 20° C ÷ + 40°C

TWIN TOGGLE SWITCHES

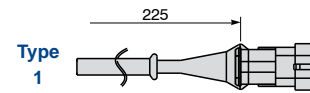
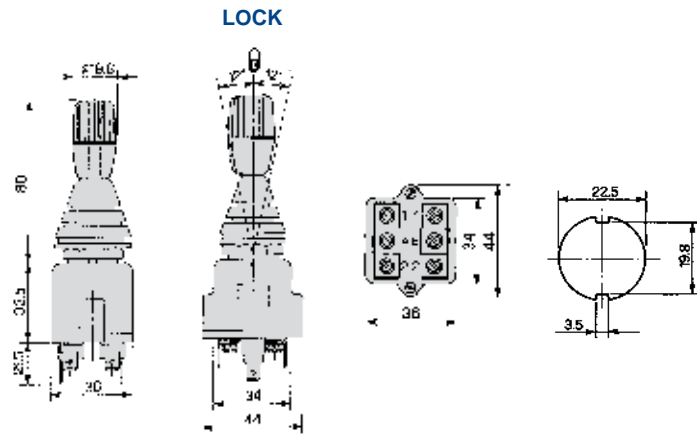

FEMALE CONNECTOR AMP S/SEAL 3 pins

Schema Elettrico
Wiring diagram

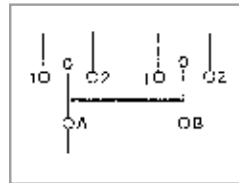

P/N	Q.ta Q.ty	TENS. NOMINALE NOMINAL VOLTAGE	CORRENTE MAX MAX CURRENT	N° CONTATTI N° CONTACTS	GRADO DI PROT. SEALING	TEMP. DI FUNZ. OPERATING TEMP.	CONTATTI CONTACTS	TYPE CONNESSIONE CONNECTION TYPE	FUNZIONI FUNCTIONS
1021631 16-0237-0000	1	12 V	8,5 A induttivi / inductive	6	IP 53	- 20° C ÷ + 40°C	ARGENTATI SILVER	-	
		24 V	5 A induttivi / inductive	6	IP 53	- 20° C ÷ + 40°C			
1023940 16-235-000	100	12 V	2,5 mA induttivi / inductive	6	IP 53	- 20° C ÷ + 40°C	DORATI GOLDEN	-	
		-	-	-	-	-			
1021633 16-0240-0000	1	12 V	8,5 A induttivi / inductive	6	IP 53	- 20° C ÷ + 40°C	ARGENTATI SILVER	1	
		24 V	5 A induttivi / inductive	6	IP 53	- 20° C ÷ + 40°C			

TWIN TOGGLE SWITCHES

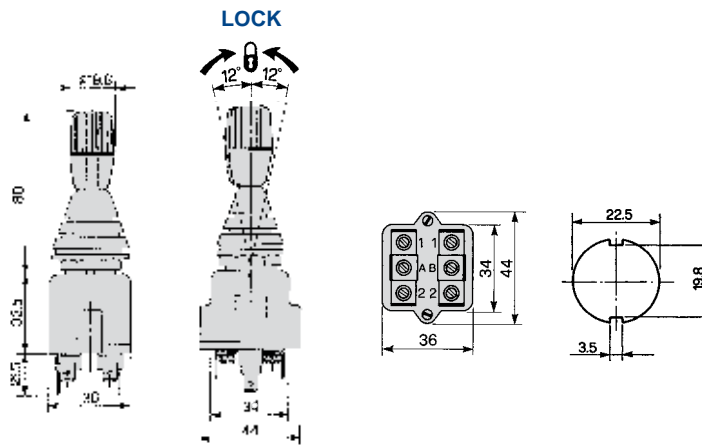

Schema Elettrico
Wiring diagram

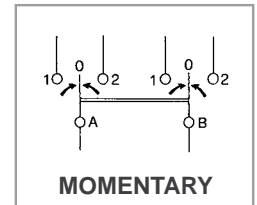

P/N	Q.ta Q.ty	TENS. NOMINALE NOMINAL VOLTAGE	CORRENTE MAX MAX CURRENT	N° CONTATTI N° CONTACTS	GRADO DI PROT. SEALING	TEMP. DI FUNZ. OPERATING TEMP.	CONTATTI CONTACTS	TYPE CONNESSIONE CONNECTION TYPE	FUNZIONI FUNCTIONS
1023898 16-200-000	1	12 V	8,5 A induttivi / inductive	6	IP 53	-20° C ÷ +40° C	ARGENTATI SILVER	-	
		24 V	5 A induttivi / inductive	6	IP 53	-20° C ÷ +40° C			

TWIN TOGGLE SWITCHES

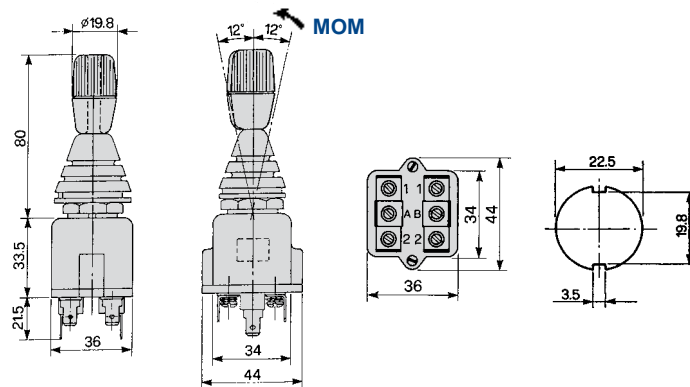

Schema Elettrico
Wiring diagram

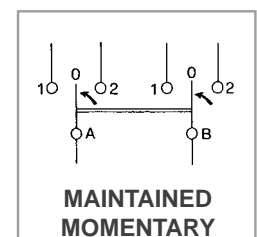

P/N	Q.ta Q.ty	TENS. NOMINALE NOMINAL VOLTAGE	CORRENTE MAX MAX CURRENT	N° CONTATTI N° CONTACTS	GRADO DI PROT. SEALING	TEMP. DI FUNZ. OPERATING TEMP.	CONTATTI CONTACTS	TYPE CONNESSIONE CONNECTION TYPE	FUNZIONI FUNCTIONS
1023900 16-203-000	100	12 V	8,5 A induttivi / inductive	6	IP 53	-20° C ÷ +40° C	ARGENTATI SILVER	-	-
		24 V	5 A induttivi / inductive	6	IP 53	-20° C ÷ +40° C			
1023938 16-234-000	1	12 V	2,5 mA induttivi / inductive	6	IP 53	-20° C ÷ +40° C	DORATI GOLDEN	-	-

ELECTRIC LIFT CONTROL SWITCHES

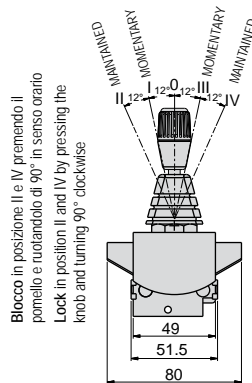
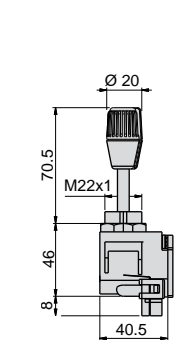

Blocco in posizione II e IV premendo il pomello e ruotandolo di 90° in senso orario
Lock in position II and IV by pressing the knob and turning 90° clockwise

Schema Elettrico
Wiring diagram

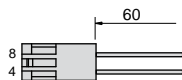
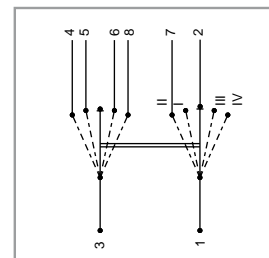

CONNECTOR PACKARD 2 pins

P/N	Q.ta Q.ty	TENS. NOMINALE NOMINAL VOLTAGE	CORRENTE MAX MAX CURRENT	N° CICLI N° LIFE CYCLES	N° CONTATTI N° CONTACTS	GRADO DI PROT. SEALING	TEMP. DI FUNZ. OPERATING TEMP.	FUNZIONI FUNCTIONS
1023821 16-189-000	1	12 V	4 A induttivi / inductive	-	6	IP 53	-20° C ÷ +40° C	
		24 V	2 A induttivi / inductive	-	6	IP 53	-20° C ÷ +40° C	

ELECTRIC LIFT CONTROL SWITCHES

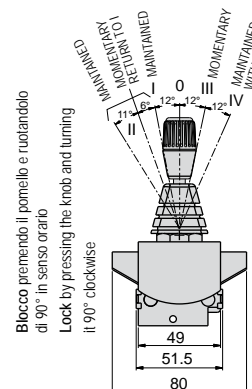
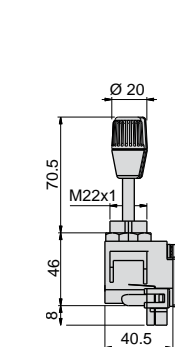

Blocco premendo il pomello e ruotandolo di 90° in senso orario
Lock by pressing the knob and turning it 90° clockwise

Schema Elettrico
Wiring diagram

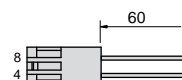
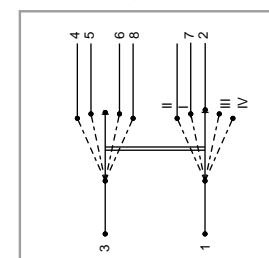

CONNECTOR PACKARD 2 pins

P/N	Q.ta Q.ty	TENS. NOMINALE NOMINAL VOLTAGE	CORRENTE MAX MAX CURRENT	N° CICLI N° LIFE CYCLES	N° CONTATTI N° CONTACTS	GRADO DI PROT. SEALING	TEMP. DI FUNZ. OPERATING TEMP.	FUNZIONI FUNCTIONS
1023886	1	12 V	4 A induttivi / inductive	-	6	IP 53	-20° C ÷ +40° C	
1023887	25	24 V	2 A induttivi / inductive	-	6	IP 53	-20° C ÷ +40° C	

ELECTRIC LIFT CONTROL SWITCHES

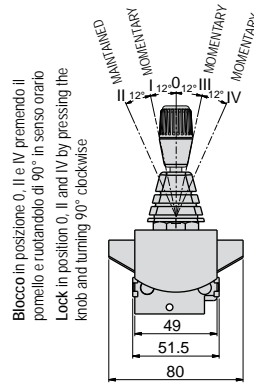
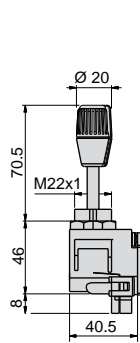

Blocco in posizione 0, II e IV premendo il pomello e ruotandolo di 90° in senso orario
Lock in position 0, II and IV by pressing the knob and turning 90° clockwise

Schema Elettrico
Wiring diagram

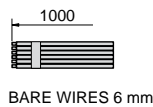
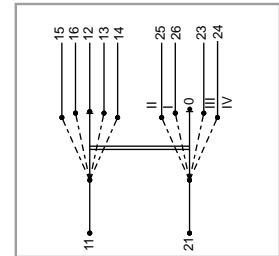

BARE WIRES 6 mm

P/N	Q.ta Q.ty	TENS. NOMINALE NOMINAL VOLTAGE	CORRENTE MAX MAX CURRENT	N° CICLI N° LIFE CYCLES	N° CONTATTI N° CONTACTS	GRADO DI PROT. SEALING	TEMP. DI FUNZ. OPERATING TEMP.	FUNZIONI FUNCTIONS
1023907 16-211-000	25	12 V	4 A induttivi / inductive	-	6	IP 53	-20° C ÷ +40° C	
		24 V	2 A induttivi / inductive	-	6	IP 53	-20° C ÷ +40° C	

ELECTRIC LIFT CONTROL SWITCHES

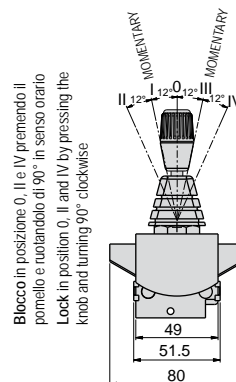
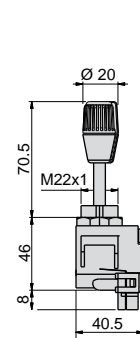

Blocco in posizione 0, II e IV premendo il pomello e ruotandolo di 90° in senso orario
Lock in position 0, II and IV by pressing the knob and turning 90° clockwise

Schema Elettrico
Wiring diagram

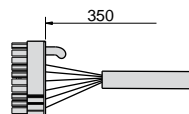
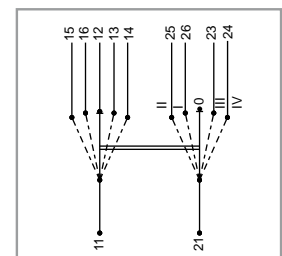

CONNECTOR MOLEX 20 pins

P/N	Q.ta Q.ty	TENS. NOMINALE NOMINAL VOLTAGE	CORRENTE MAX MAX CURRENT	N° CICLI N° LIFE CYCLES	N° CONTATTI N° CONTACTS	GRADO DI PROT. SEALING	TEMP. DI FUNZ. OPERATING TEMP.	FUNZIONI FUNCTIONS
1098379 16-0582-0000	10	12 V	4 A induttivi / inductive	-	6	IP 53	-20° C ÷ +40° C	
		24 V	2 A induttivi / inductive	-	6	IP 53	-20° C ÷ +40° C	

PUSH BUTTON SWITCHES | avviamento motori starting engines

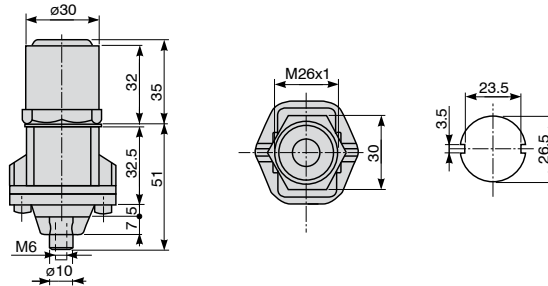

Schema Elettrico
Wiring diagram

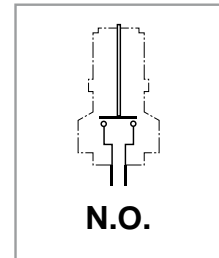

P/N	Q.ta Q.ty	TENS. NOMINALE NOMINAL VOLTAGE	CORRENTE MAX MAX CURRENT	CARICO CHIUSURA CONTATTI LOAD CONTACT CLOSURE	CARICO FINE CORSA LOAD AT END OF STROKE	GRADO DI PROT. SEALING	FILETTATURA THREADNG
1003687 AV-17-0003	1	12 V	35 A induttivi / <i>inductive</i>	18 N	80 N	IP 65	M26x1
		24 V	15 A induttivi / <i>inductive</i>	18 N	80 N	IP 65	

PUSH BUTTON SWITCHES

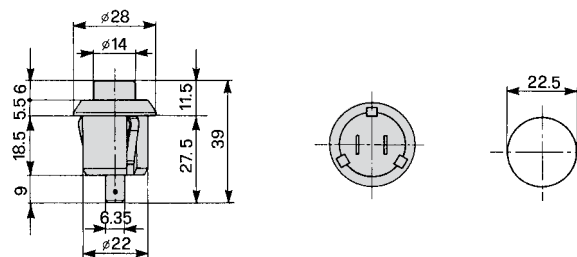

Schema Elettrico
Wiring diagram

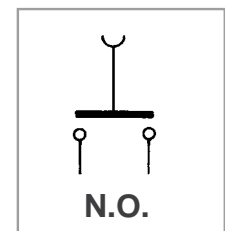

P/N	Q.ta Q.ty	TENS. NOMINALE NOMINAL VOLTAGE	CORRENTE MAX MAX CURRENT	N° CICLI N° LIFE CYCLES	N° CONTATTI N° CONTACTS	GRADO DI PROT. SEALING	TEMP. DI FUNZ. OPERATING TEMP.	COLORE CAPPUCIO CAP COLOR
1026089 17-105-000	10	12 V	25 A resistivi / <i>resistive</i>	100.000	2	IP 40	- 20° C ÷ + 40°C	
		24 V	15 A resistivi / <i>resistive</i>	100.000	2	IP 40	- 20° C ÷ + 40°C	

PUSH BUTTON SWITCHES



Type A

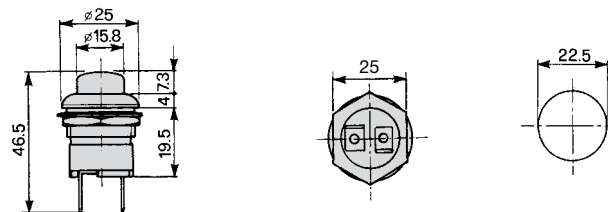

Type B

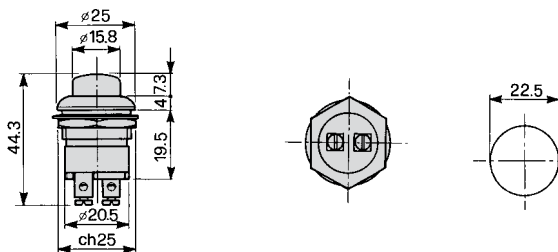

Schema Elettrico
Wiring diagram

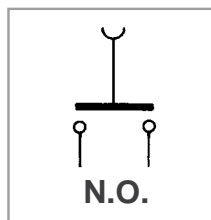



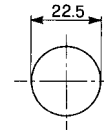
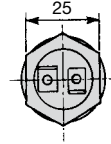
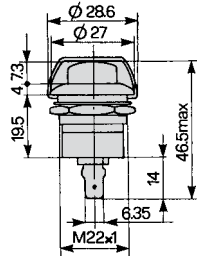

P/N	Q.ta Q.ty	TYPE	TENS. NOMINALE NOMINAL VOLTAGE	CORRENTE MAX MAX CURRENT	N° CICLI N° LIFE CYCLES	N° CONTATTI N° CONTACTS	GRADO DI PROT. SEALING	TEMP. DI FUNZ. OPERATING TEMP.	HOUSING MATERIAL	SIMBOLO ICONS
1026151 17-130-000	10	A	12 V	25 A induttivi / inductive	10.000	2	IP 40	- 20° C ÷ + 40°C	Black ABS	-
			24 V	25 A induttivi / inductive	10.000	2	IP 40	- 20° C ÷ + 40°C		
1026145 17-126-000	10	B	12 V	25 A induttivi / inductive	10.000	2	IP 40	- 20° C ÷ + 40°C	Black ABS	-
			24 V	25 A induttivi / inductive	10.000	2	IP 40	- 20° C ÷ + 40°C		
1026163 17-134-000	10	A	12 V	25 A induttivi / inductive	10.000	2	IP 40	- 20° C ÷ + 40°C	Chromed ABS	
			24 V	25 A induttivi / inductive	10.000	2	IP 40	- 20° C ÷ + 40°C		
1025412 17-0263-0000	200	A	12 V	25 A induttivi / inductive	10.000	2	IP 40	- 20° C ÷ + 40°C	Black ABS	
			24 V	25 A induttivi / inductive	10.000	2	IP 40	- 20° C ÷ + 40°C		
1025427 17-0279-0000	10	A	12 V	25 A induttivi / inductive	10.000	2	IP 40	- 20° C ÷ + 40°C	Black ABS	
			24 V	25 A induttivi / inductive	10.000	2	IP 40	- 20° C ÷ + 40°C		
1111790 1111791 17-0606-0000	5 50	A	12 V	25 A induttivi / inductive	10.000	2	IP 40	- 20° C ÷ + 40°C	Black ABS	
			24 V	25 A induttivi / inductive	10.000	2	IP 40	- 20° C ÷ + 40°C		

PUSH BUTTON SWITCHES

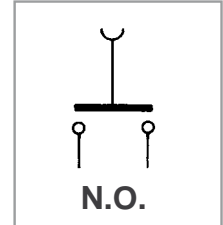

Schema Elettrico
Wiring diagram



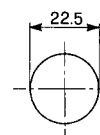
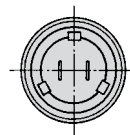
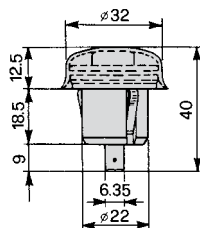

P/N	Q.ta Q.ty	TENS. NOMINALE NOMINAL VOLTAGE	CORRENTE MAX MAX CURRENT	N° CICLI N° LIFE CYCLES	N° CONTATTI N° CONTACTS	GRADO DI PROT. SEALING	TEMP. DI FUNZ. OPERATING TEMP.	COLORE CAPPUCCIO CAP COLOR
1026240 1026241 17-153-000	10 100	12 V	25 A resistivi / resistive	-	2	IP 40	- 20° C ÷ + 40°C	
		24 V	15 A resistivi / resistive	-	2	IP 40	- 20° C ÷ + 40°C	
1025428 17-0283-0000	10	12 V	25 A induttivi / inductive	-	4	IP 40	- 20° C ÷ + 40°C	
		24 V	15 A induttivi / inductive	-	4	IP 40	- 20° C ÷ + 40°C	
1026358 17-208-000	1	12 V	25 A resistivi / resistive	-	2	IP 40	- 20° C ÷ + 40°C	
		24 V	15 A resistivi / resistive	-	2	IP 40	- 20° C ÷ + 40°C	

PUSH BUTTON SWITCHES

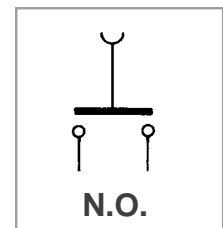

Schema Elettrico
Wiring diagram



P/N	Q.ta Q.ty	TENS. NOMINALE NOMINAL VOLTAGE	CORRENTE MAX MAX CURRENT	N° CICLI N° LIFE CYCLES	N° CONTATTI N° CONTACTS	GRADO DI PROT. SEALING	TEMP. DI FUNZ. OPERATING TEMP.	COLORE CAPPUCCIO CAP COLOR
1026139 17-124-000	5	12 V	25 A resistivi / resistive	-	2	IP 40	- 20° C ÷ + 40°C	
		24 V	15 A resistivi / resistive	-	2	IP 40	- 20° C ÷ + 40°C	

PUSH BUTTON SWITCHES

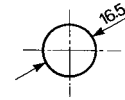
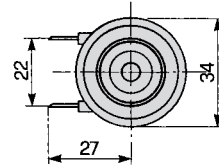
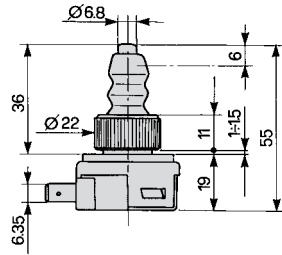

Schema Elettrico
Wiring diagram

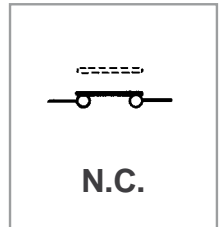

P/N	Q.ta Q.ty	TENS. NOMINALE NOMINAL VOLTAGE	CORRENTE MAX MAX CURRENT	N° CICLI N° LIFE CYCLES	N° CONTATTI N° CONTACTS	GRADO DI PROT. SEALING	TEMP. DI FUNZ. OPERATING TEMP.	NOTE
1026288 17-169-000	10	12 V	4 A resistivi / resistive	50.000	2	IP 66	- 20° C ÷ + 40° C	
		24 V	2 A resistivi / resistive	50.000	2	IP 66	- 20° C ÷ + 40° C	

PUSH BUTTON SWITCHES | per comando luce retromarcia for reversing light control

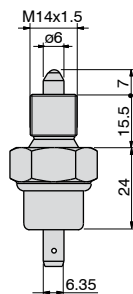

Schema Elettrico
Wiring diagram

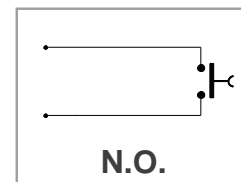

P/N	Q.ta Q.ty	TENS. NOMINALE NOMINAL VOLTAGE	CORRENTE MAX MAX CURRENT	N° CICLI N° LIFE CYCLES	N° CONTATTI N° CONTACTS	GRADO DI PROT. SEALING	TEMP. DI FUNZ. OPERATING TEMP.	FILETTATURA THREADING
1026131 17-120-000	50	12 V	8 A resistivi / resistive	100.000	2	IP 67	- 20° C ÷ + 40° C	M14x1,5 6g
		24 V	4 A resistivi / resistive	100.000	2	IP 67	- 20° C ÷ + 40° C	

PUSH BUTTON SWITCHES | per comando luce retromarcia

for reversing light control

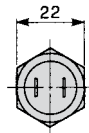
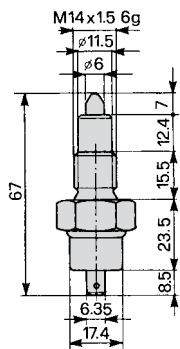

Schema Elettrico
Wiring diagram

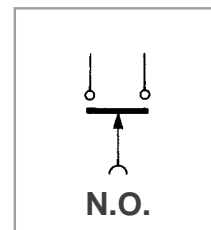

P/N	Q.ta Q.ty	TENS. NOMINALE NOMINAL VOLTAGE	CORRENTE MAX MAX CURRENT	N° CICLI N° LIFE CYCLES	N° CONTATTI N° CONTACTS	GRADO DI PROT. SEALING	TEMP. DI FUNZ. OPERATING TEMP.	FILETTATURA THREADNG
1026142	5	12 V	8 A resistivi / resistive	100.000	2	IP 67	- 20° C ÷ + 40°C	M14x1,5 6g
1026143 17-125-000	50	24 V	4 A resistivi / resistive	100.000	2	IP 67	- 20° C ÷ + 40°C	

PUSH BUTTON SWITCHES

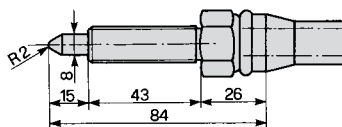
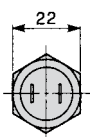

Schema Elettrico
Wiring diagram

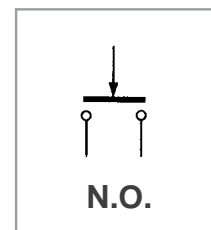

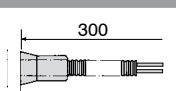
P/N	Q.ta Q.ty	TENS. NOMINALE NOMINAL VOLTAGE	CORRENTE MAX MAX CURRENT	N° CONTATTI N° CONTACTS	GRADO DI PROT. SEALING	TEMP. DI FUNZ. OPERATING TEMP.	FILETTATURA THREADNG	CONNESSIONE CONNECTION
1026338	100	12 V	6 A resistivi / resistive	2	IP 67	- 20° C ÷ + 40°C	M14x1,5 6g	
17-193-000		24 V	3 A resistivi / resistive	2	IP 67	- 20° C ÷ + 40°C		

PUSH BUTTON SWITCHES

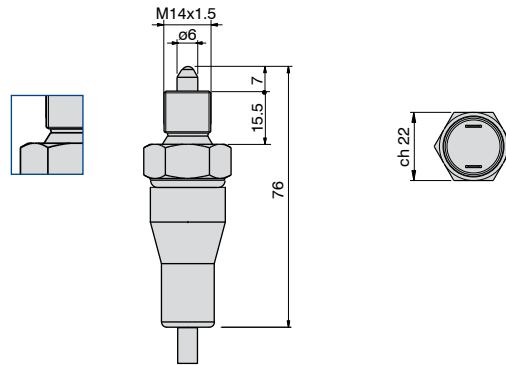

Tubo corrugato / Convuluted tubing

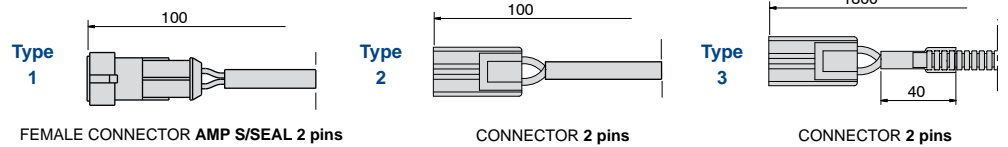

Schema Elettrico
Wiring diagram

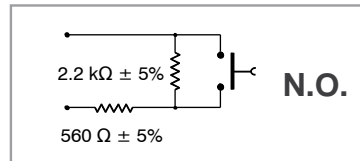

P/N	Q.ta Q.ty	TENS. NOMINALE NOMINAL VOLTAGE	CORRENTE MAX MAX CURRENT	N° CICLI N° LIFE CYCLES	N° CONTATTI N° CONTACTS	GRADO DI PROT. SEALING	TEMP. DI FUNZ. OPERATING TEMP.	TYPE	COLORE CONNETTORE COLOR CONNECTOR
1025398 17-0253-0000	40	5 V	0,5 A resistivi / resistive	200.000	2	IP 67	- 40° C ÷ + 105°C	1	GRIGIO - GREY AMP S/SEAL 2 pins P/N AMP 282104-2 P/N COBO 3009208
		-	-	-	-	-	-		
1025400 17-0255-0000	1	5 V	0,5 A resistivi / resistive	200.000	2	IP 67	- 40° C ÷ + 105°C	2	NERO - BLACK AMP 2 pins P/N AMP 344274-1 P/N COBO 30-16-06112
		-	-	-	-	-	-		
1025402 17-0256-0000	80	5 V	0,5 A resistivi / resistive	200.000	2	IP 67	- 40° C ÷ + 105°C	2	ROSSO - RED AMP 2 pins P/N AMP 344274-2 P/N COBO 30-16-06113
		-	-	-	-	-	-		
1025403 1025404 17-0257-0000	1 20	5 V	0,5 A resistivi / resistive	200.000	2	IP 67	- 40° C ÷ + 105°C	3	NERO - BLACK AMP 2 pins P/N AMP 344274-1 P/N COBO 30-16-06112
		-	-	-	-	-	-		

Schema Elettrico
Wiring diagram

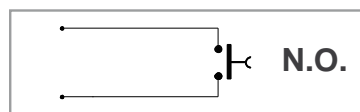

P/N	Q.ta Q.ty	TENS. NOMINALE NOMINAL VOLTAGE	CORRENTE MAX MAX CURRENT	N° CICLI N° LIFE CYCLES	N° CONTATTI N° CONTACTS	GRADO DI PROT. SEALING	TEMP. DI FUNZ. OPERATING TEMP.	TYPE	COLORE CONNETTORE COLOR CONNECTOR
1025417 17-0269-0000	20	5 V	0,5 A resistivi / resistive	200.000	2	IP 67	- 40° C ÷ + 105°C	3	NERO - BLACK AMP 2 pins P/N AMP 344274-1 P/N COBO 30-16-06112
		-	-	-	-	-	-		

PUSH BUTTON SWITCHES

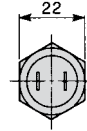
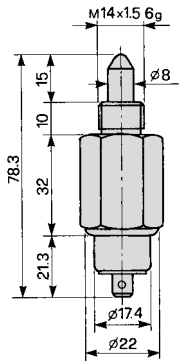
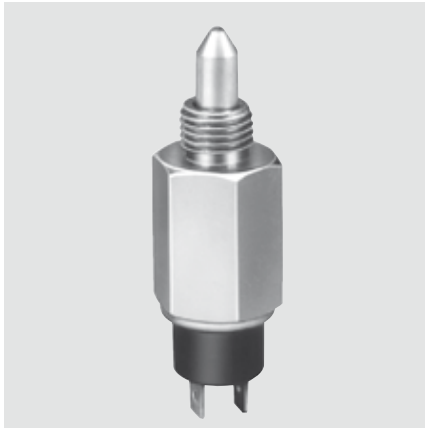

Schema Elettrico
Wiring diagram

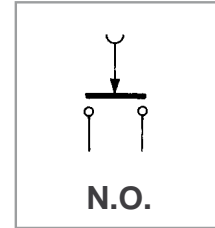

P/N	Q.ta Q.ty	TENS. NOMINALE NOMINAL VOLTAGE	CORRENTE MAX MAX CURRENT	N° CICLI N° LIFE CYCLES	N° CONTATTI N° CONTACTS	GRADO DI PROT. SEALING	TEMP. DI FUNZ. OPERATING TEMP.	FILETTATURA THREADNG
1026281 17-165-000	60	12 V	8 A resistivi / resistive	100.000	2	IP 67	- 20° C ÷ + 40° C	M14x1,5 6g
		24 V	4 A resistivi / resistive	100.000	2	IP 67	- 20° C ÷ + 40° C	

PUSH BUTTON SWITCHES

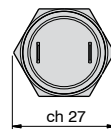
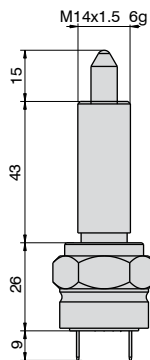

Schema Elettrico
Wiring diagram

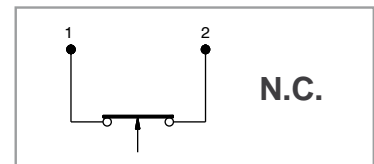

P/N	Q.ta Q.ty	TENS. NOMINALE NOMINAL VOLTAGE	CORRENTE MAX MAX CURRENT	N° CICLI N° LIFE CYCLES	N° CONTATTI N° CONTACTS	GRADO DI PROT. SEALING	TEMP. DI FUNZ. OPERATING TEMP.	FILETTATURA THREADNG
1025590 17-0492-0000	5	12 V	8 A resistivi / resistive	20.000	2	IP 65	- 40° C ÷ + 85° C	M14x1,5 6g
		24 V	4 A resistivi / resistive	20.000	2	IP 65	- 40° C ÷ + 85° C	

PUSH BUTTON SWITCHES

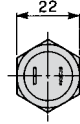
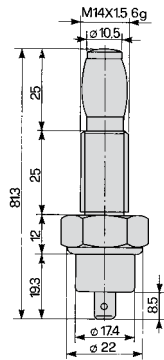

Schema Elettrico
Wiring diagram

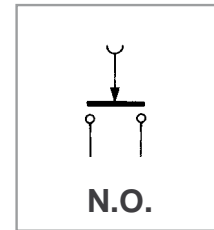

P/N	Q.ta Q.ty	TENS. NOMINALE NOMINAL VOLTAGE	CORRENTE MAX MAX CURRENT	N° CICLI N° LIFE CYCLES	N° CONTATTI N° CONTACTS	GRADO DI PROT. SEALING	TEMP. DI FUNZ. OPERATING TEMP.	FILETTATURA THREADNG
1026318 17-186-000	50	12 V	8 A resistivi / resistive	-	2	IP 67	- 20° C ÷ + 40° C	M14x1,5 6g
		24 V	4 A resistivi / resistive	-	2	IP 67	- 20° C ÷ + 40° C	

PUSH BUTTON SWITCHES

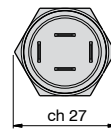
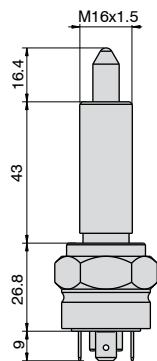

Schema Elettrico
Wiring diagram

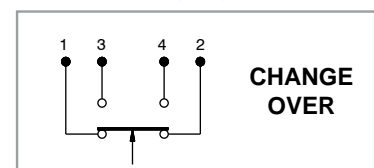

P/N	Q.ta Q.ty	TENS. NOMINALE NOMINAL VOLTAGE	CORRENTE MAX MAX CURRENT	N° CICLI N° LIFE CYCLES	N° CONTATTI N° CONTACTS	GRADO DI PROT. SEALING	TEMP. DI FUNZ. OPERATING TEMP.	FILETTATURA THREADNG
1057234 17-0576-0000	1	12 V	8 A resistivi / resistive	20.000	4	IP 65	- 40° C ÷ + 85° C	M16x1,5
		24 V	4 A resistivi / resistive	20.000	4	IP 65	- 40° C ÷ + 85° C	

PUSH BUTTON SWITCHES | per comando luce retromarcia for reversing light control

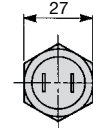
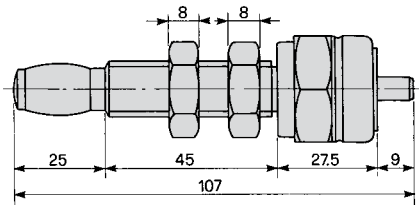

Schema Elettrico
Wiring diagram

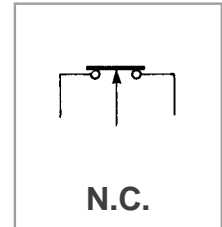

P/N	Q.ta Q.ty	TENS. NOMINALE NOMINAL VOLTAGE	CORRENTE MAX MAX CURRENT	N° CICLI N° LIFE CYCLES	N° CONTATTI N° CONTACTS	GRADO DI PROT. SEALING	TEMP. DI FUNZ. OPERATING TEMP.	FILETTATURA THREADING
1026350 17-204-000	50	12 V	10 A resistivi / resistive	-	2	IP 67	- 20° C ÷ + 40°C	M14x1,5
		24 V	5 A resistivi / resistive	-	2	IP 67	- 20° C ÷ + 40°C	

PUSH BUTTON SWITCHES | per consenso avviamento for start-up consent

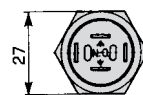
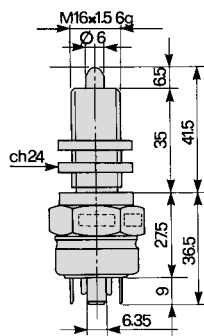

Schema Elettrico
Wiring diagram

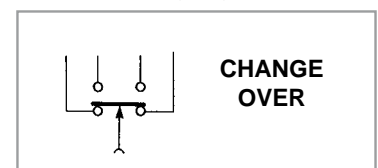

P/N	Q.ta Q.ty	TENS. NOMINALE NOMINAL VOLTAGE	CORRENTE MAX MAX CURRENT	N° CICLI N° LIFE CYCLES	N° CONTATTI N° CONTACTS	GRADO DI PROT. SEALING	TEMP. DI FUNZ. OPERATING TEMP.	FILETTATURA THREADING
1026290	5	12 V	45 A induttivi / inductive	5.000	4	IP 66	- 20° C ÷ + 40°C	M16x1,5 6g
1026291 17-170-000	50	24 V	20 A induttivi / inductive	5.000	4	IP 66	- 20° C ÷ + 40°C	

PUSH BUTTON SWITCHES

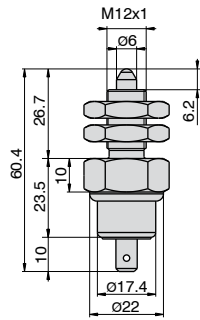

Schema Elettrico
Wiring diagram

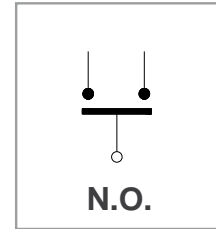

P/N	Q.ta Q.ty	TENS. NOMINALE NOMINAL VOLTAGE	CORRENTE MAX MAX CURRENT	N° CICLI N° LIFE CYCLES	N° CONTATTI N° CONTACTS	GRADO DI PROT. SEALING	TEMP. DI FUNZ. OPERATING TEMP.	FILETTATURA THREADNG
1025410 17-0261-0000	50	12 V	8 A resistivi / resistive	100.000	2	IP 67	- 40° C ÷ + 120°C	M12x1
		24 V	4 A resistivi / resistive	100.000	2	IP 67	- 40° C ÷ + 120°C	

PUSH BUTTON SWITCHES

CON CONTATTI ARGENTATI - WITH SILVER CONTACTS



FEMALE CONNECTOR
AMP S/SEAL 2 pins

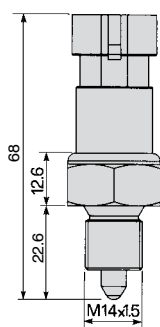

Type
A

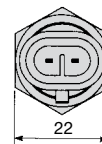

CON CONTATTI DORATI - WITH GOLD-PLATED CONTACTS



FEMALE CONNECTOR
AMP S/SEAL 2 pins

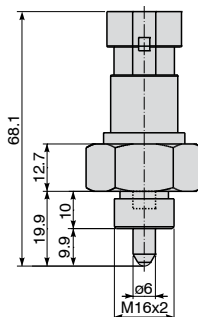

Type
B

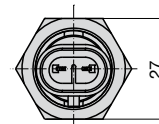

Schema Elettrico
Wiring diagram

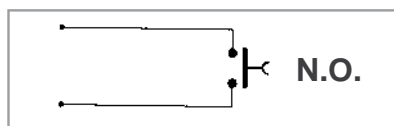

P/N	Q.ta Q.ty	TYPE	TENS. NOMINALE NOMINAL VOLTAGE	CORRENTE MAX MAX CURRENT	N° CICLI N° LIFE CYCLES	N° CONTATTI N° CONTACTS	GRADO DI PROT. SEALING	TEMP. DI FUNZ. OPERATING TEMP.	COLORE BASETTA TERMINAL BORAD COLOR
1025404 1025406 17-0258-0000	20	A	12 V	8 A resistivi / resistive	100.000	2	IP 67	- 40° C ÷ + 120°C	
	100		24 V	4 A resistivi / resistive	100.000	2	IP 67	- 40° C ÷ + 120°C	
1025407 1025408 17-0259-0000	5	A	12 V	8 A resistivi / resistive	100.000	2	IP 67	- 40° C ÷ + 120°C	
	100		24 V	4 A resistivi / resistive	100.000	2	IP 67	- 40° C ÷ + 120°C	
1088003 17-0282-0000	50	B	12 V	8 A resistivi / resistive	200.000	2	IP 66	- 40° C ÷ + 85°C	
			24 V	4 A resistivi / resistive	200.000	2	IP 66	- 40° C ÷ + 85°C	
1025391 17-0249-0000	100	A	12 V	8 A resistivi / resistive	100.000	2	IP 67	- 40° C ÷ + 120°C	
			24 V	4 A resistivi / resistive	100.000	2	IP 67	- 40° C ÷ + 120°C	

PUSH BUTTON SWITCHES

CON CONTATTI ARGENTATI - WITH SILVER CONTACTS



FEMALE CONNECTOR
AMP S/SEAL 2 pins

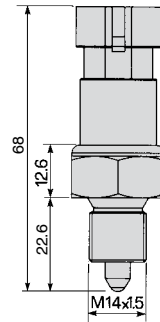

Type
A

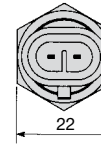

CON CONTATTI DORATI - WITH GOLD-PLATED CONTACTS



FEMALE CONNECTOR
AMP S/SEAL 2 pins

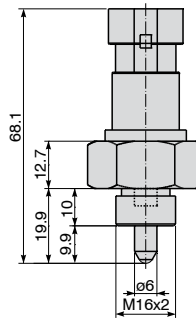

Type
B

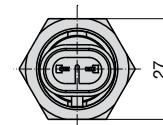

Schema Elettrico
Wiring diagram

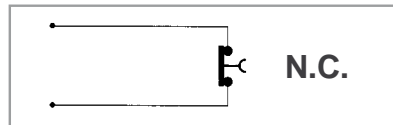

P/N	Q.ta Q.ty	TYPE	TENS. NOMINALE NOMINAL VOLTAGE	CORRENTE MAX MAX CURRENT	N° CICLI N° LIFE CYCLES	N° CONTATTI N° CONTACTS	GRADO DI PROT. SEALING	TEMP. DI FUNZ. OPERATING TEMP.	COLORE BASETTA TERMINAL BORAD COLOR
1026381 17-227-000	100	A	12 V	8 A resistivi / resistive	100.000	2	IP 67	- 40° C ÷ + 120°C	
			24 V	4 A resistivi / resistive	100.000	2	IP 67	- 40° C ÷ + 120°C	
1025419 17-0271-0000	1	B	12 V	8 A resistivi / resistive	200.000	2	IP 66	- 40° C ÷ + 85°C	
			24 V	4 A resistivi / resistive	200.000	2	IP 66	- 40° C ÷ + 85°C	

Schema Elettrico
Wiring diagram

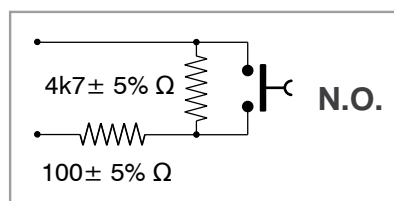

P/N	Q.ta Q.ty	TYPE	TENS. NOMINALE NOMINAL VOLTAGE	CORRENTE MAX MAX CURRENT	N° CICLI N° LIFE CYCLES	N° CONTATTI N° CONTACTS	GRADO DI PROT. SEALING	TEMP. DI FUNZ. OPERATING TEMP.	COLORE BASETTA TERMINAL BORAD COLOR
1078657 1078658 17-0587-0000	1	A	12 V	8 A resistivi / resistive	100.000	2	IP 67	- 40° C ÷ + 120°C	
	100		24 V	4 A resistivi / resistive	100.000	2	IP 67	- 40° C ÷ + 120°C	

PUSH BUTTON SWITCHES

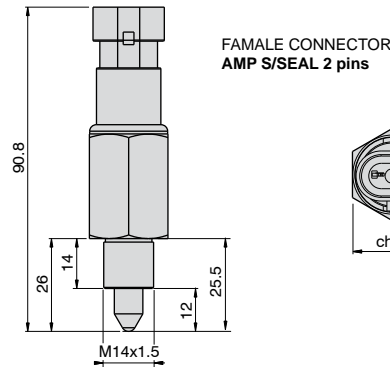

Schema Elettrico
Wiring diagram

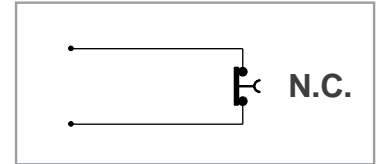

P/N	Q.ta Q.ty	TENS. NOMINALE NOMINAL VOLTAGE	CORRENTE MAX MAX CURRENT	N° CICLI N° LIFE CYCLES	N° CONTATTI N° CONTACTS	GRADO DI PROT. SEALING	TEMP. DI FUNZ. OPERATING TEMP.	FILETTATURA THREADNG
1025389	5	12 V	8 A resistivi / resistive	10.000	2	IP 66	- 40° C ÷ + 120°C	M14x1.5
1025390 17-0247-0000	50	24 V	4 A resistivi / resistive	10.000	2	IP 66	- 40° C ÷ + 120°C	

PUSH BUTTON SWITCHES

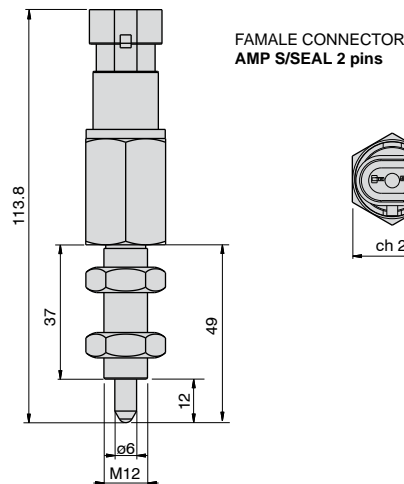

Schema Elettrico
Wiring diagram

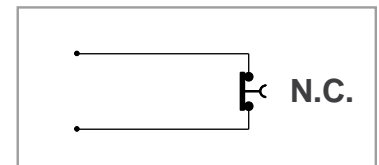

P/N	Q.ta Q.ty	TENS. NOMINALE NOMINAL VOLTAGE	CORRENTE MAX MAX CURRENT	N° CICLI N° LIFE CYCLES	N° CONTATTI N° CONTACTS	GRADO DI PROT. SEALING	TEMP. DI FUNZ. OPERATING TEMP.	FILETTATURA THREADNG
1025416	50	12 V	8 A resistivi / resistive	10.000	2	IP 66	- 40° C ÷ + 120°C	M12
17-0268-0000		24 V	4 A resistivi / resistive	10.000	2	IP 66	- 40° C ÷ + 120°C	

PUSH BUTTON SWITCHES

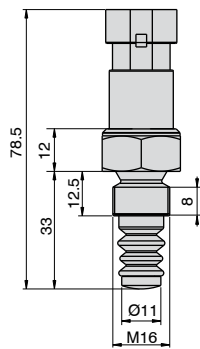

FEMALE CONNECTOR
AMP S/SEAL 2 pins



Schema Elettrico
Wiring diagram

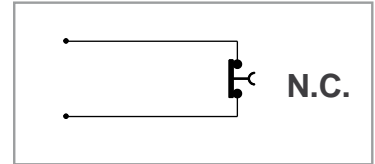

P/N	Q.ta Q.ty	TENS. NOMINALE NOMINAL VOLTAGE	CORRENTE MAX MAX CURRENT	N° CICLI N° LIFE CYCLES	N° CONTATTI N° CONTACTS	GRADO DI PROT. SEALING	TEMP. DI FUNZ. OPERATING TEMP.	FILETTATURA THREADNG
1026391	1	12 V	8 A resistivi / resistive	100.000	2	IP 66	- 40° C ÷ + 120°C	M16
1026392 17-240-000	50	24 V	4 A resistivi / resistive	100.000	2	IP 66	- 40° C ÷ + 120°C	

PUSH BUTTON SWITCHES | per consenso avviamento for start-up consent

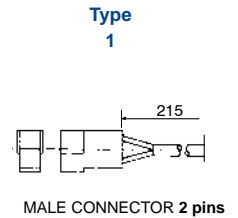
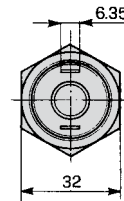
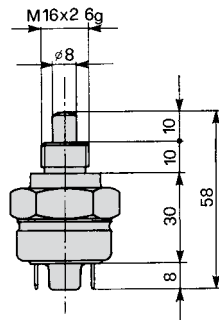

Schema Elettrico
Wiring diagram

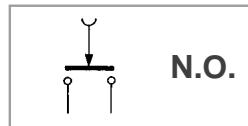

P/N	Q.ta Q.ty	TENS. NOMINALE NOMINAL VOLTAGE	CORRENTE MAX MAX CURRENT	N° CICLI N° LIFE CYCLES	N° CONTATTI N° CONTACTS	GRADO DI PROT. SEALING	TEMP. DI FUNZ. OPERATING TEMP.	FILETTATURA THREADNG	TYPE CONNESSIONE CONNECTION TYPE
1026104	5	12 V	45 A induttivi / inductive	5.000	2	IP 66	- 20° C ÷ + 40°C	M16x2 6g	-
1026105 17-111-000	50	24 V	20 A induttivi / inductive	5.000	2	IP 66	- 20° C ÷ + 40°C		
									-

Schema Elettrico
Wiring diagram

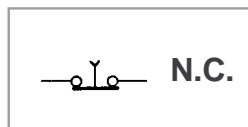

P/N	Q.ta Q.ty	TENS. NOMINALE NOMINAL VOLTAGE	CORRENTE MAX MAX CURRENT	N° CICLI N° LIFE CYCLES	N° CONTATTI N° CONTACTS	GRADO DI PROT. SEALING	TEMP. DI FUNZ. OPERATING TEMP.	FILETTATURA THREADNG	TYPE CONNESSIONE CONNECTION TYPE
2007614	5	12 V	45 A induttivi / inductive	5.000	2	IP 66	- 20° C ÷ + 40°C	M16x2 6g	-
1026118 17-113-000	50	24 V	20 A induttivi / inductive	5.000	2	IP 66	- 20° C ÷ + 40°C		
1026356 17-207-000	1	12 V	45 A induttivi / inductive	5.000	2	IP 66	- 20° C ÷ + 40°C	M16x2 6g	1
		24 V	20 A induttivi / inductive	5.000	2	IP 66	- 20° C ÷ + 40°C		

PUSH BUTTON SWITCHES

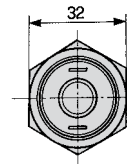
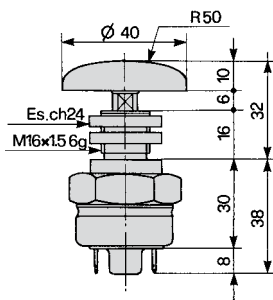

Schema Elettrico
Wiring diagram

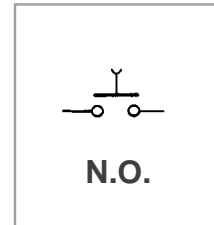

P/N	Q.ta Q.ty	TENS. NOMINALE NOMINAL VOLTAGE	CORRENTE MAX MAX CURRENT	N° CICLI N° LIFE CYCLES	N° CONTATTI N° CONTACTS	GRADO DI PROT. SEALING	TEMP. DI FUNZ. OPERATING TEMP.	FILETTATURA THREADNG
1026293	5	12 V	45 A induttivi / inductive	5.000	2	IP 66	- 20° C ÷ + 40°C	M16x1,5 6g
1026294 17-171-000	50	24 V	20 A induttivi / inductive	5.000	2	IP 66	- 20° C ÷ + 40°C	

PUSH BUTTON SWITCHES | per consenso avviamento for start-up consent

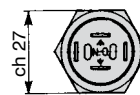
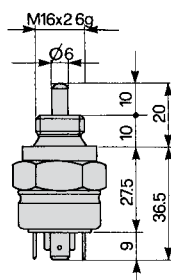
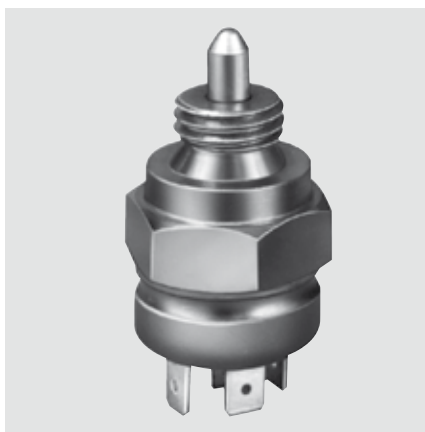

Schema Elettrico
Wiring diagram

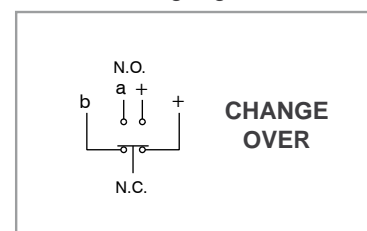

P/N	Q.ta Q.ty	TENS. NOMINALE NOMINAL VOLTAGE	CORRENTE MAX MAX CURRENT	N° CICLI N° LIFE CYCLES	N° CONTATTI N° CONTACTS	GRADO DI PROT. SEALING	TEMP. DI FUNZ. OPERATING TEMP.	FILETTATURA THREADNG
1026303	10	12 V	45 A induttivi / inductive	5.000	4	IP 66	- 20° C ÷ + 85°C	M16x2 6g
1026303 17-175-000		24 V	20 A induttivi / inductive	5.000	4	IP 66	- 20° C ÷ + 85°C	

PUSH BUTTON SWITCHES | per consenso avviamento for start-up consent

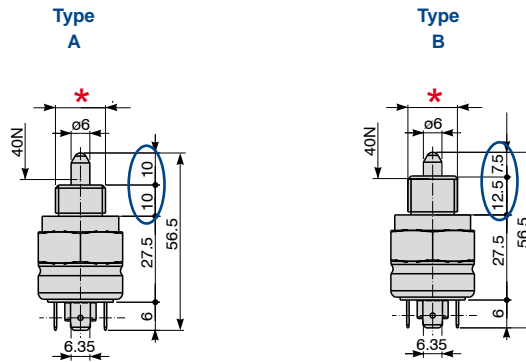

Schema Elettrico
Wiring diagram

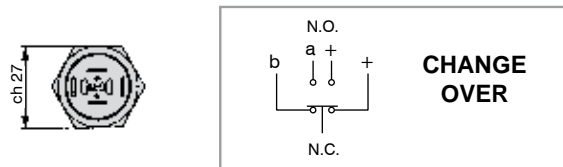

P/N	Q.ta Q.ty	TYPE	TENS. NOMINALE NOMINAL VOLTAGE	CORRENTE MAX MAX CURRENT	N° CICLI N° LIFE CYCLES	N° CONTATTI N° CONTACTS	GRADO DI PROT. SEALING	TEMP. DI FUNZ. OPERATING TEMP.	ACTUATION FORCE	* FILETTATURA THREADING
1026135 17-122-000	100	A	12 V	45 A induttivi / inductive	5.000	4	IP 66	-20° C ÷ +85° C	-	M16x1,5 6g
			24 V	20 A induttivi / inductive	5.000	4	IP 66	-20° C ÷ +85° C		
1025431 17-0286-0000	100	A	12 V	45 A induttivi / inductive	5.000	4	IP 66	-20° C ÷ +85° C	40 N	M16x1,5 6g
			24 V	20 A induttivi / inductive	5.000	4	IP 66	-20° C ÷ +85° C		
1026286 17-168-000	50	A	12 V	45 A induttivi / inductive	5.000	4	IP 66	-20° C ÷ +85° C	-	M16x2 6g
			24 V	20 A induttivi / inductive	5.000	4	IP 66	-20° C ÷ +85° C		
1026370 1026371 17-219-000	5	B	12 V	45 A induttivi / inductive	5.000	4	IP 66	-20° C ÷ +85° C	-	M16x2 6g
	100		24 V	20 A induttivi / inductive	5.000	4	IP 66	-20° C ÷ +85° C		
1025425 17-0277-0000	100	A	12 V	45 A induttivi / inductive	5.000	4	IP 66	-20° C ÷ +85° C	-	M18x1,5 6g
			24 V	20 A induttivi / inductive	5.000	4	IP 66	-20° C ÷ +85° C		

Schema Elettrico
Wiring diagram

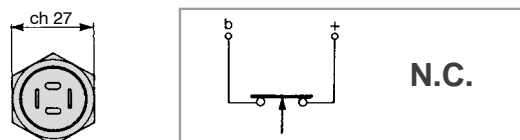

P/N	Q.ta Q.ty	TYPE	TENS. NOMINALE NOMINAL VOLTAGE	CORRENTE MAX MAX CURRENT	N° CICLI N° LIFE CYCLES	N° CONTATTI N° CONTACTS	GRADO DI PROT. SEALING	TEMP. DI FUNZ. OPERATING TEMP.	ACTUATION FORCE	* FILETTATURA THREADING
1026234 17-151-000	100	A	12 V	45 A induttivi / inductive	5.000	2	IP 66	-20° C ÷ +85° C	-	M16x1,5 6g
			24 V	20 A induttivi / inductive	5.000	2	IP 66	-20° C ÷ +85° C		
1025426 17-0278-0000	50	A	12 V	45 A induttivi / inductive	5.000	2	IP 66	-20° C ÷ +85° C	-	M18x1,5 6g
			24 V	20 A induttivi / inductive	5.000	2	IP 66	-20° C ÷ +85° C		

PUSH BUTTON SWITCHES | per consenso avviamento for start-up consent

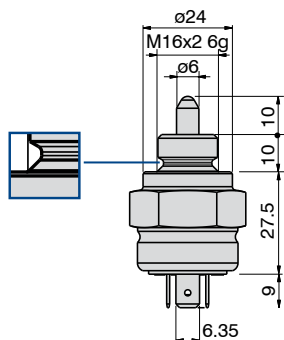

Schema Elettrico
Wiring diagram

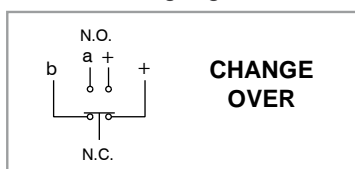
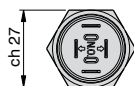

P/N	Q.ta Q.ty	TENS. NOMINALE NOMINAL VOLTAGE	CORRENTE MAX MAX CURRENT	N° CICLI N° LIFE CYCLES	N° CONTATTI N° CONTACTS	GRADO DI PROT. SEALING	TEMP. DI FUNZ. OPERATING TEMP.	FILETTATURA THREADNG
1091131	2	12 V	45 A induttivi / inductive	5.000	4	IP 66	- 40° C ÷ + 85°C	M16x2 6g
1091132	50	24 V	20 A induttivi / inductive	5.000	4	IP 66	- 40° C ÷ + 85°C	

Schema Elettrico
Wiring diagram

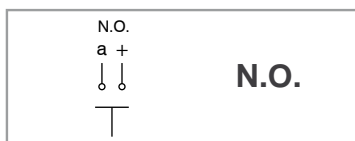
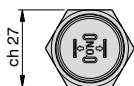

P/N	Q.ta Q.ty	TENS. NOMINALE NOMINAL VOLTAGE	CORRENTE MAX MAX CURRENT	N° CICLI N° LIFE CYCLES	N° CONTATTI N° CONTACTS	GRADO DI PROT. SEALING	TEMP. DI FUNZ. OPERATING TEMP.	FILETTATURA THREADNG
1091133	2	12 V	45 A induttivi / inductive	5.000	2	IP 66	- 40° C ÷ + 85°C	M16x2 6g
1091134	50	24 V	20 A induttivi / inductive	5.000	2	IP 66	- 40° C ÷ + 85°C	

PUSH BUTTON SWITCHES | per consenso avviamento for start-up consent

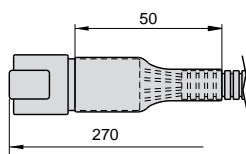
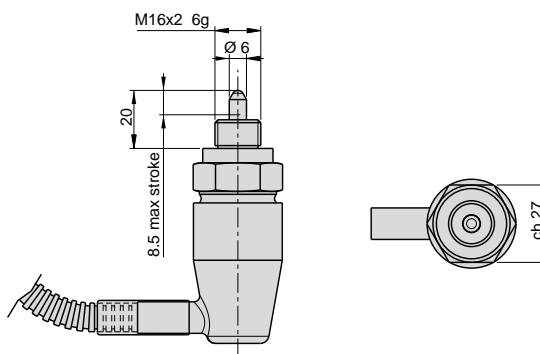

MALE CONNECTOR DEUTSCH 4 pins

Schema Elettrico
Wiring diagram

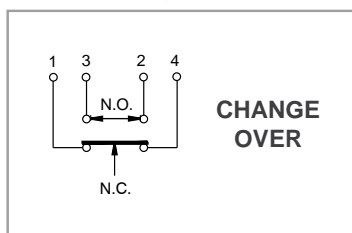

P/N	Q.ta Q.ty	TENS. NOMINALE NOMINAL VOLTAGE	CORRENTE MAX MAX CURRENT	N° CICLI N° LIFE CYCLES	N° CONTATTI N° CONTACTS	GRADO DI PROT. SEALING	TEMP. DI FUNZ. OPERATING TEMP.	FILETTATURA THREADING
1025423	5	12 V	45 A induttivi / <i>inductive</i>	5.000	4	IP 66	- 20° C ÷ + 85°C	M16x2 6g
1025424 17-0276-0000	100	24 V	20 A induttivi / <i>inductive</i>	5.000	4	IP 66	- 20° C ÷ + 85°C	

PUSH BUTTON SWITCHES

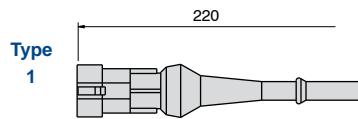
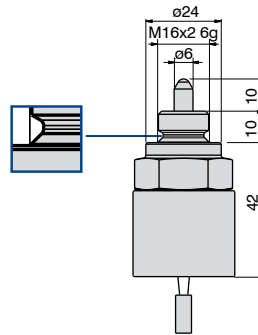

FEMALE CONNECTOR AMP S/SEAL 2 pins

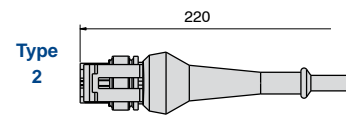

MALE CONNECTOR AMP S/SEAL 2 pins

Schema Elettrico
Wiring diagram

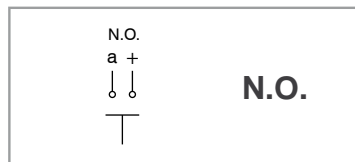

P/N	Q.ta Q.ty	TYPE	TENS. NOMINALE NOMINAL VOLTAGE	CORRENTE MAX MAX CURRENT	N° CICLI N° LIFE CYCLES	N° CONTATTI N° CONTACTS	GRADO DI PROT. SEALING	TEMP. DI FUNZ. OPERATING TEMP.	FILETTATURA THREADNG
1102787	1	1	12 V	45 A induttivi / <i>inductive</i>	5.000	2	IP 66	- 40° C ÷ + 85°C	M16x2 6g
1102788 17-0602-0000	25		24 V	20 A induttivi / <i>inductive</i>	5.000	2	IP 66	- 40° C ÷ + 85°C	
1104334	1	2	12 V	45 A induttivi / <i>inductive</i>	5.000	2	IP 66	- 40° C ÷ + 85°C	M14x2 6g
1104335 17-0605-0000	25		24 V	20 A induttivi / <i>inductive</i>	5.000	2	IP 66	- 40° C ÷ + 85°C	

PUSH BUTTON SWITCHES

NEW

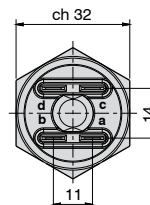
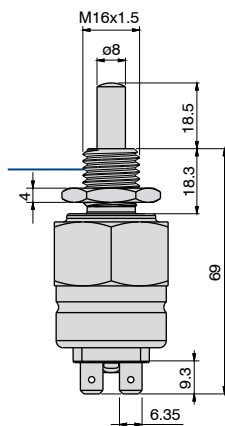

Schema Elettrico
Wiring diagram

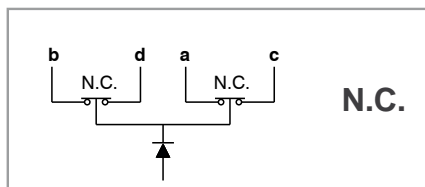

P/N	Q.ta Q.ty	TENS. NOMINALE NOMINAL VOLTAGE	CORRENTE NOMINALE NOMINAL CURRENT	N° CICLI N° LIFE CYCLES	N° CONTATTI N° CONTACTS	GRADO DI PROT. SEALING	TEMP. DI FUNZ. OPERATING TEMP.	FILETTATURA THREADING
1105521	1	12 V	1 A resistivi / resistive	75.000	4	IP 67	- 40° C ÷ + 85°C	M16x1.5
1105508	25	-	-	-	-	-	-	
17-0603-0000								

Schema Elettrico
Wiring diagram

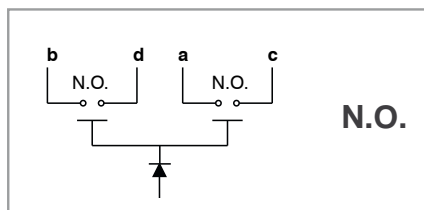

P/N	Q.ta Q.ty	TENS. NOMINALE NOMINAL VOLTAGE	CORRENTE MAX MAX CURRENT	N° CICLI N° LIFE CYCLES	N° CONTATTI N° CONTACTS	GRADO DI PROT. SEALING	TEMP. DI FUNZ. OPERATING TEMP.	FILETTATURA THREADING
1105522	1	12 V	1 A resistivi / resistive	75.000	4	IP 67	- 40° C ÷ + 85°C	M16x1.5
1105509	25	-	-	-	-	-	-	
17-0604-0000								

PUSH BUTTON SWITCHES | a sfera / ball

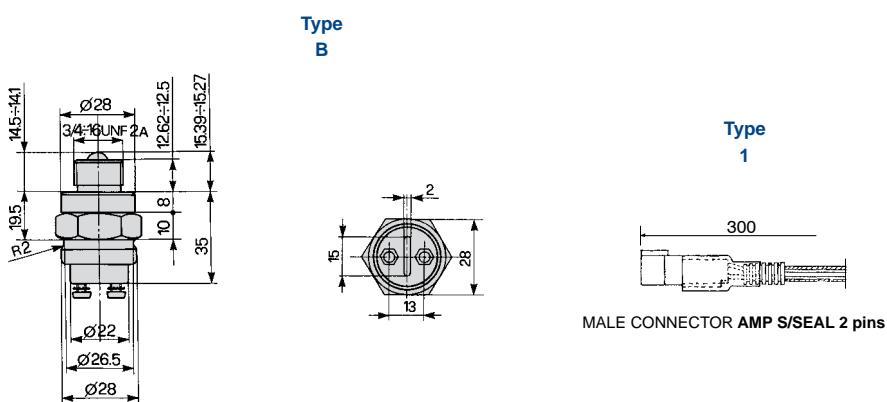
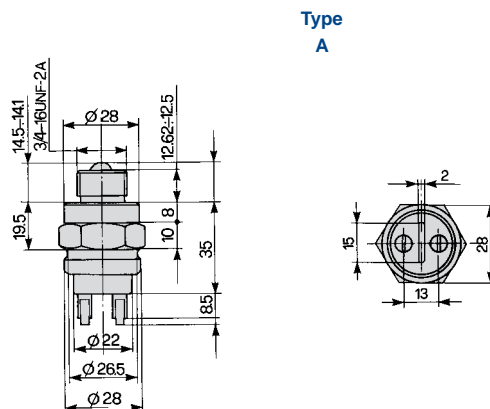

Schema Elettrico
Wiring diagram

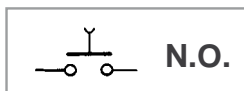

P/N	Q.ta Q.ty	TYPE	TENS. NOMINALE NOMINAL VOLTAGE	CORRENTE MAX MAX CURRENT	N° CICLI N° LIFE CYCLES	N° CONTATTI N° CONTACTS	GRADO DI PROT. SEALING	TEMP. DI FUNZ. OPERATING TEMP.	TYPE CONNESSIONE CONNECTION TYPE
1026307 17-177-000	5	A	12 V	20 A resistivi / resistive	100.000	2	IP 67	- 20° C ÷ + 40° C	-
			24 V	10 A resistivi / resistive	100.000	2	IP 67	- 20° C ÷ + 40° C	-
1026310 17-178-000	50	B	12 V	20 A resistivi / resistive	100.000	2	IP 67	- 20° C ÷ + 40° C	-
			24 V	10 A resistivi / resistive	100.000	2	IP 67	- 20° C ÷ + 40° C	-
1025593 17-0496-0000	50	B	12 V	9 A resistivi / resistive	100.000	2	IP 67	- 20° C ÷ + 40° C	1
			24 V	9 A resistivi / resistive	100.000	2	IP 67	- 20° C ÷ + 40° C	1

Schema Elettrico
Wiring diagram

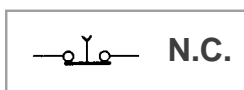

P/N	Q.ta Q.ty	TYPE	TENS. NOMINALE NOMINAL VOLTAGE	CORRENTE MAX MAX CURRENT	N° CICLI N° LIFE CYCLES	N° CONTATTI N° CONTACTS	GRADO DI PROT. SEALING	TEMP. DI FUNZ. OPERATING TEMP.	CAPPUCCHIO + CONNESSIONE CAP + CONNECTION
1026305 17-176-000	1	A	12 V	20 A resistivi / resistive	100.000	2	IP 67	- 20° C ÷ + 40° C	-
			24 V	10 A resistivi / resistive	100.000	2	IP 67	- 20° C ÷ + 40° C	-
1025592 17-0495-0000	50	B	12 V	9 A resistivi / resistive	100.000	2	IP 67	- 20° C ÷ + 40° C	1
			24 V	9 A resistivi / resistive	100.000	2	IP 67	- 20° C ÷ + 40° C	1

PUSH BUTTON SWITCHES

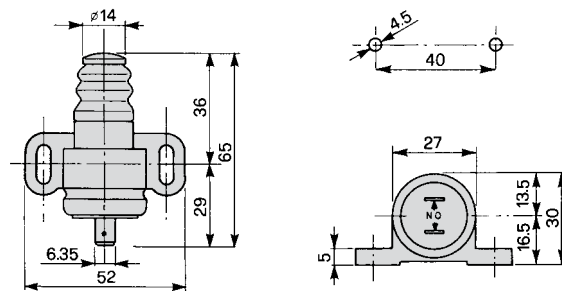

Schema Elettrico
Wiring diagram

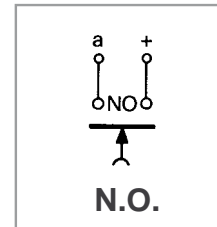

P/N	Q.ta Q.ty	TENS. NOMINALE NOMINAL VOLTAGE	CORRENTE MAX MAX CURRENT	N° CICLI N° LIFE CYCLES	N° CONTATTI N° CONTACTS	GRADO DI PROT. SEALING	TEMP. DI FUNZ. OPERATING TEMP.	CAPPUCCIO + CONNESSIONE CAP + CONNECTION
1026267	50	12 V	25 A induttivi / inductive	5.000	2	IP 67	- 20° C ÷ + 40° C	
1026268 17-161-000	84	24 V	15 A induttivi / inductive	5.000	2	IP 67	- 20° C ÷ + 40° C	
1025411 17-0262-0000	1	12 V	20 A induttivi / inductive	5.000	2	IP 67	- 20° C ÷ + 40° C	
		24 V	15 A induttivi / inductive	5.000	2	IP 67	- 20° C ÷ + 40° C	

PUSH BUTTON SWITCHES

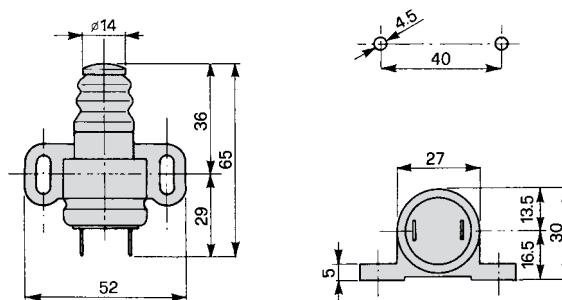

Schema Elettrico
Wiring diagram

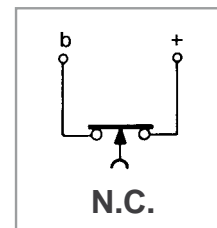

P/N	Q.ta Q.ty	TENS. NOMINALE NOMINAL VOLTAGE	CORRENTE MAX MAX CURRENT	N° CICLI N° LIFE CYCLES	N° CONTATTI N° CONTACTS	GRADO DI PROT. SEALING	TEMP. DI FUNZ. OPERATING TEMP.	NOTE
1026270 17-162-000	50	12 V	25 A induttivi / inductive	5.000	2	IP 67	- 20° C ÷ + 40° C	
		24 V	15 A induttivi / inductive	5.000	2	IP 67	- 20° C ÷ + 40° C	

PUSH BUTTON SWITCHES



Type A

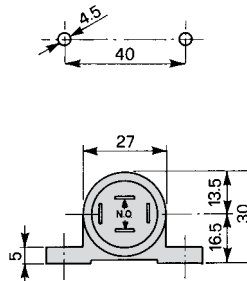
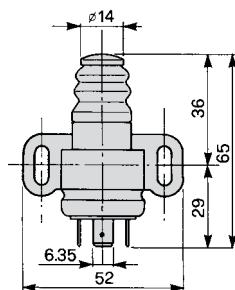

Type B

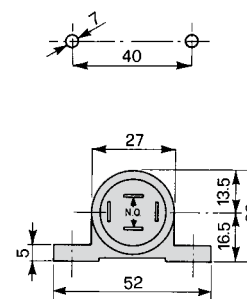
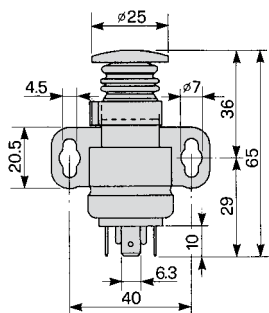

Schema Elettrico
Wiring diagram

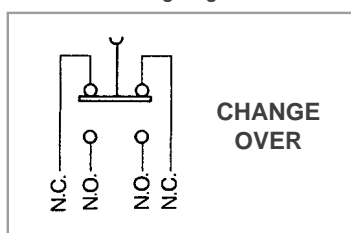

P/N	Q.ta Q.ty	TYPE	TENS. NOMINALE NOMINAL VOLTAGE	CORRENTE MAX MAX CURRENT	N° CICLI N° LIFE CYCLES	N° CONTATTI N° CONTACTS	GRADO DI PROT. SEALING	TEMP. DI FUNZ. OPERATING TEMP.	CAPPUCCIO CAP
1026264	50	A	12 V	25 A induttivi / inductive	5.000	4	IP 67	- 20° C ÷ + 40° C	
1026265 17-160-000	84		24 V	15 A induttivi / inductive	5.000	4	IP 67	- 20° C ÷ + 40° C	
1025385	50	A	12 V	25 A induttivi / inductive	5.000	4	IP 67	- 20° C ÷ + 40° C	
1025386 17-0243-0000	84		24 V	15 A induttivi / inductive	5.000	4	IP 67	- 20° C ÷ + 40° C	
1025645	1	B	12 V	25 A induttivi / inductive	5.000	4	IP 67	- 20° C ÷ + 40° C	
1025646 17-0561-0000	84		24 V	15 A induttivi / inductive	5.000	4	IP 67	- 20° C ÷ + 40° C	
1026352	5	B	12 V	30 A induttivi / inductive	5.000	4	IP 67	- 20° C ÷ + 40° C	
1026353 17-205-000	50		24 V	20 A induttivi / inductive	5.000	4	IP 67	- 20° C ÷ + 40° C	
1025387	5	B	12 V	30 A induttivi / inductive	5.000	4	IP 67	- 20° C ÷ + 40° C	
1025388 17-0244-0000	84		24 V	20 A induttivi / inductive	5.000	4	IP 67	- 20° C ÷ + 40° C	

SNAP-ACTION SWITCHES

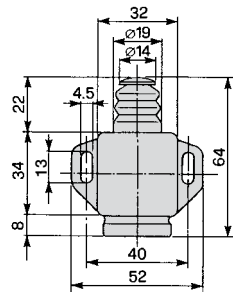

Type A

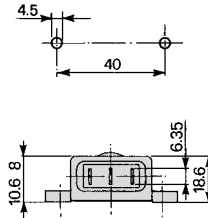

Schema Elettrico
Wiring diagram

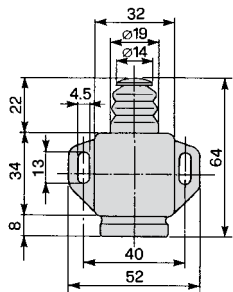
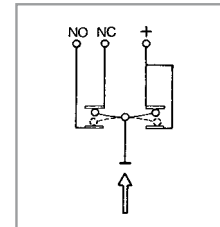

CABLE + CONNECTOR
Type B

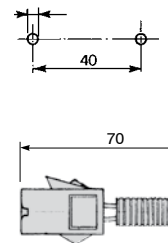

Schema Elettrico
Wiring diagram

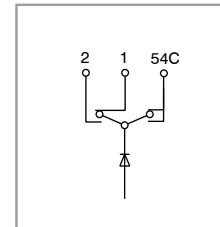

P/N	Q.ta Q.ty	TYPE	TENS. NOMINALE NOMINAL VOLTAGE	CORRENTE MAX MAX CURRENT	N° CICLI N° LIFE CYCLES	N° CONTATTI N° CONTACTS	GRADO DI PROT. SEALING	TEMP. DI FUNZ. OPERATING TEMP.	NOTE
1021514 1021515 15-110-000	10	A	12 V	12 A resistivi / resistive	100.000	3	IP 65	-20° C ÷ +85° C	
			12 V	5 A induttivi / inductive	100.000	3	IP 65	-20° C ÷ +85° C	
	300		24 V	8 A resistivi / resistive	100.000	3	IP 65	-20° C ÷ +85° C	
			24 V	3 A induttivi / inductive	100.000	3	IP 65	-20° C ÷ +85° C	
1021552 15-129-000	2	B	12 V	12 A resistivi / resistive	100.000	3	IP 65	-20° C ÷ +85° C	connettore + mastice
			12 V	5 A induttivi / inductive	100.000	3	IP 65	-20° C ÷ +85° C	
			24 V	8 A resistivi / resistive	100.000	3	IP 65	-20° C ÷ +85° C	connector + mastic
			24 V	3 A induttivi / inductive	100.000	3	IP 65	-20° C ÷ +85° C	

SNAP-ACTION SWITCHES | per indicatori d'arresto for brake lights

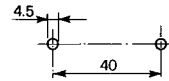
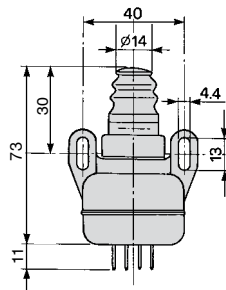

Schema Elettrico
Wiring diagram

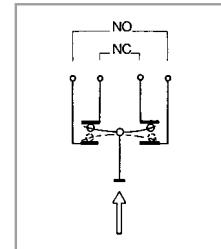

Type
A

Type
B

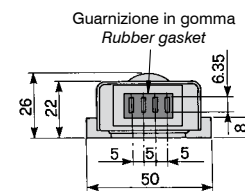
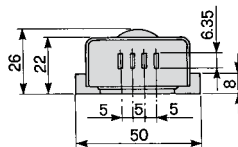

P/N	Q.ta Q.ty	TYPE	TENS. NOMINALE NOMINAL VOLTAGE	CORRENTE MAX MAX CURRENT	N° CICLI N° LIFE CYCLES	N° CONTATTI N° CONTACTS	GRADO DI PROT. SEALING	TEMP. DI FUNZ. OPERATING TEMP.	CAPPUCCIO CAP
1021530 1021531 15-117-000	5 200	A	12 V	12 A resistivi / <i>resistive</i>	100.000	4	IP 66	- 20° C ÷ + 85° C	
			12 V	5 A induttivi / <i>inductive</i>	100.000	4	IP 66	- 20° C ÷ + 85° C	
			24 V	8 A resistivi / <i>resistive</i>	100.000	4	IP 66	- 20° C ÷ + 85° C	
			24 V	3 A induttivi / <i>inductive</i>	100.000	4	IP 66	- 20° C ÷ + 85° C	
1021469 1021470 15-0160-0000	5 200	A	12 V	12 A resistivi / <i>resistive</i>	100.000	4	IP 66	- 20° C ÷ + 85° C	
			12 V	5 A induttivi / <i>inductive</i>	100.000	4	IP 66	- 20° C ÷ + 85° C	
			24 V	8 A resistivi / <i>resistive</i>	100.000	4	IP 66	- 20° C ÷ + 85° C	
			24 V	3 A induttivi / <i>inductive</i>	100.000	4	IP 66	- 20° C ÷ + 85° C	
1021474 1021475 15-0166-0000	5 200	B	12 V	12 A resistivi / <i>resistive</i>	100.000	4	IP 67	- 20° C ÷ + 85° C	
			12 V	5 A induttivi / <i>inductive</i>	100.000	4	IP 67	- 20° C ÷ + 85° C	
			24 V	8 A resistivi / <i>resistive</i>	100.000	4	IP 67	- 20° C ÷ + 85° C	
			24 V	3 A induttivi / <i>inductive</i>	100.000	4	IP 67	- 20° C ÷ + 85° C	

SNAP-ACTION SWITCHES

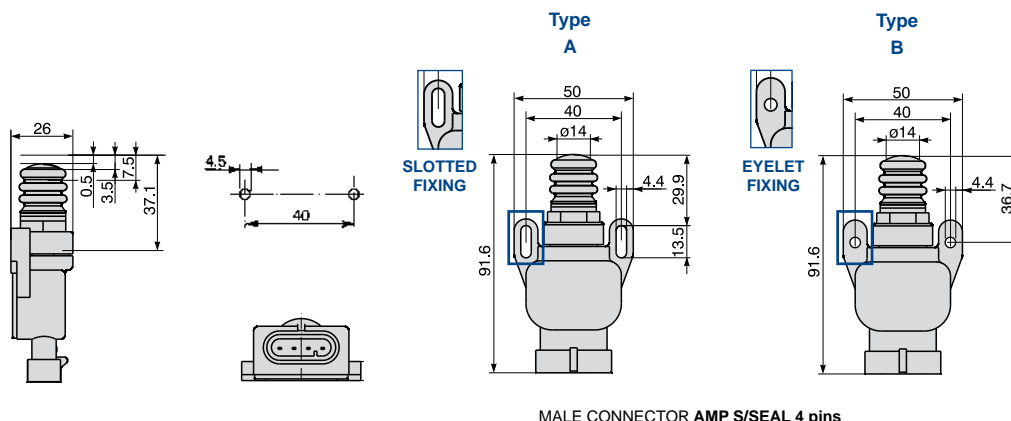

Schema Elettrico
Wiring diagram

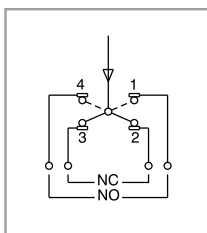

P/N	Q.ta Q.ty	TYPE	TENS. NOMINALE NOMINAL VOLTAGE	CORRENTE MAX MAX CURRENT	N° CICLI N° LIFE CYCLES	N° CONTATTI N° CONTACTS	GRADO DI PROT. SEALING	TEMP. DI FUNZ. OPERATING TEMP.	CAPPUCCIO CAP
1021477	5	A	12 V	12 A resistivi / resistive	200.000	4	IP 67	-20° C ÷ +85° C	
1021478	150		12 V	5 A induttivi / inductive	50.000	4	IP 67	-20° C ÷ +85° C	
15-0167-0000			12 V	12 A carico lampada / load lamp	40.000	4	IP 67	-20° C ÷ +85° C	
1057946	5	A	12 V	12 A resistivi / resistive	200.000	4	IP 67	-20° C ÷ +85° C	
1057947	150		12 V	5 A induttivi / inductive	50.000	4	IP 67	-20° C ÷ +85° C	
15-0190-0000			12 V	12 A carico lampada / load lamp	40.000	4	IP 67	-20° C ÷ +85° C	
1021490	5	B	12 V	12 A resistivi / resistive	200.000	4	IP 67	-20° C ÷ +85° C	
1021491	150		12 V	5 A induttivi / inductive	50.000	4	IP 67	-20° C ÷ +85° C	
15-0175-0000			12 V	12 A carico lampada / load lamp	40.000	4	IP 67	-20° C ÷ +85° C	

SNAP-ACTION SWITCHES | per indicatori d'arresto for brake lights

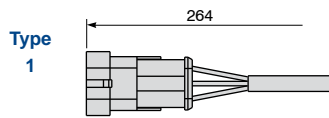
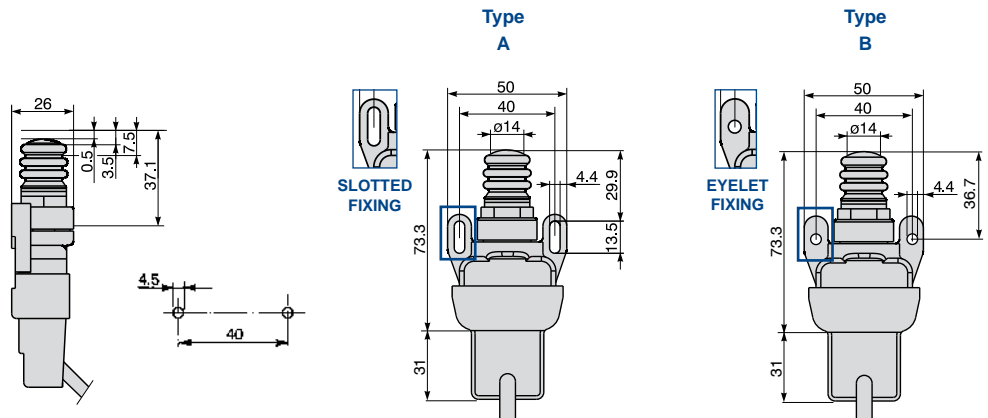

FEMALE CONNECTOR AMP S/SEAL 3 pins

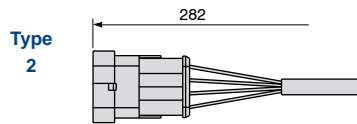

FEMALE CONNECTOR AMP S/SEAL 4 pins

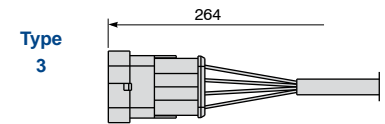

FEMALE CONNECTOR AMP S/SEAL 4 pins

Schema Elettrico Wiring diagram

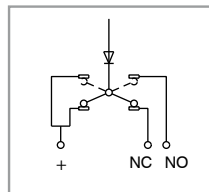

P/N	Q.ta Q.ty	TYPE	TENS. NOMINALE NOMINAL VOLTAGE	CORRENTE MAX MAX CURRENT	N° CICLI N° LIFE CYCLES	N° CONTATTI N° CONTACTS	GRADO DI PROT. SEALING	TEMP. DI FUNZ. OPERATING TEMP.	TYPE CONNESSIONE CONNECTION TYPE
1021562	10	A	12 V	12 A resistivi / resistive	100.000	3	IP 66	-20° C ÷ +85° C	1
1021563	50		12 V	5 A induttivi / inductive	100.000	3	IP 66	-20° C ÷ +85° C	

Schema Elettrico Wiring diagram

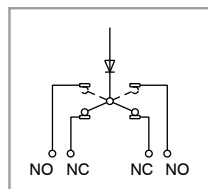

P/N	Q.ta Q.ty	TYPE	TENS. NOMINALE NOMINAL VOLTAGE	CORRENTE MAX MAX CURRENT	N° CICLI N° LIFE CYCLES	N° CONTATTI N° CONTACTS	GRADO DI PROT. SEALING	TEMP. DI FUNZ. OPERATING TEMP.	TYPE CONNESSIONE CONNECTION TYPE
1021599	2	A	12 V	12 A resistivi / resistive	100.000	4	IP 66	-20° C ÷ +85° C	2
1021600	50		12 V	5 A induttivi / inductive	100.000	4	IP 66	-20° C ÷ +85° C	
1021480	5	A	12 V	12 A resistivi / resistive	100.000	4	IP 67	-20° C ÷ +85° C	3
1021481	50		12 V	5 A induttivi / inductive	100.000	4	IP 67	-20° C ÷ +85° C	
1021492	5	B	12 V	12 A resistivi / resistive	100.000	4	IP 67	-20° C ÷ +85° C	3
1021493	50		12 V	5 A induttivi / inductive	100.000	4	IP 67	-20° C ÷ +85° C	

SNAP-ACTION SWITCHES | autoregolante self-adjusting

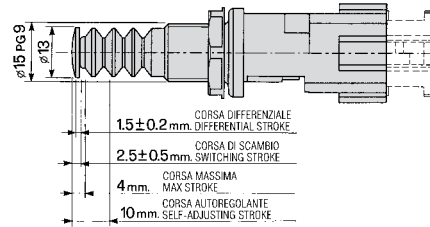

MALE CONNECTOR 4 pins

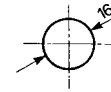
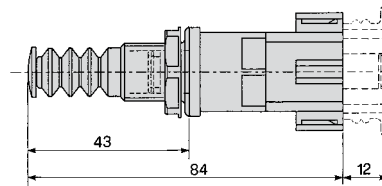
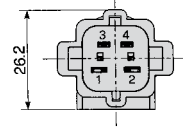

Schema Elettrico
Wiring diagram

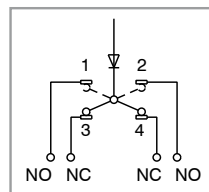

P/N	Q.ta Q.ty	TYPE	TENS. NOMINALE NOMINAL VOLTAGE	CORRENTE MAX MAX CURRENT	N° CICLI N° LIFE CYCLES	N° CONTATTI N° CONTACTS	GRADO DI PROT. SEALING	TEMP. DI FUNZ. OPERATING TEMP.	CAPPUCCIO CAP
1021597 15-153-000	10	-	12 V	8 A resistivi / resistive	-	4	IP 66	- 40° C ÷ + 85°C	-
			24 V	4 A resistivi / resistive	-	4	IP 66	- 40° C ÷ + 85°C	

SNAP-ACTION SWITCHES | autoregolante self-adjusting



MALE CONNECTOR 4 pins

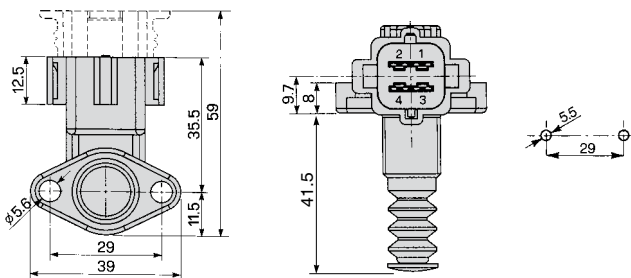

Schema Elettrico Wiring diagram

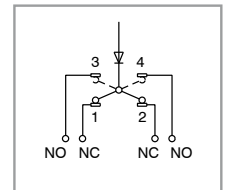

STROKE LENGTH Type A

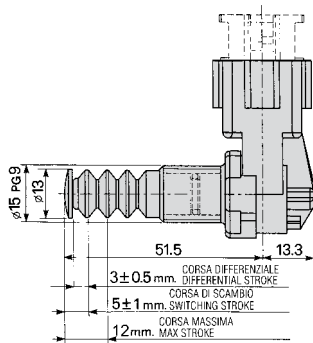

STROKE LENGTH Type B

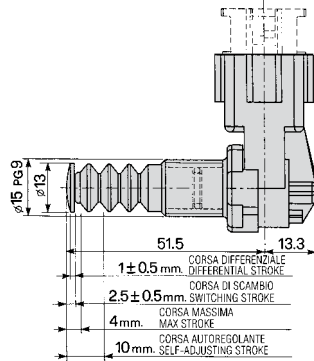

STROKE LENGTH + NUT Type C

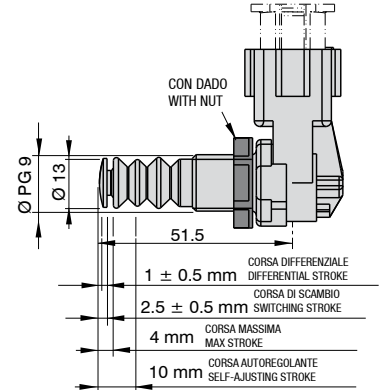

P/N	Q.ta Q.ty	TYPE	TENS. NOMINALE NOMINAL VOLTAGE	CORRENTE MAX MAX CURRENT	N° CONTATTI N° CONTACTS	GRADO DI PROT. SEALING	TEMP. DI FUNZ. OPERATING TEMP.	NOTE NOTES
1021607	10	A	12 V	8 A resistivi / resistive	4	IP 66	- 40° C ÷ + 85° C	
1021608 15-158-000	100		24 V	4 A resistivi / resistive	4	IP 66	- 40° C ÷ + 85° C	
1021486	10	A	12 V	8 A resistivi / resistive	4	IP 66	- 40° C ÷ + 85° C	Connettore con tappo di protezione Connector with protection plug
1021487 15-0173-0000	100		24 V	4 A resistivi / resistive	4	IP 66	- 40° C ÷ + 85° C	
1021592	10	B	12 V	8 A resistivi / resistive	4	IP 66	- 40° C ÷ + 85° C	
1021593 15-151-000	100		24 V	4 A resistivi / resistive	4	IP 66	- 40° C ÷ + 85° C	
1108363 15-0197-0000	10	C	12 V	8 A resistivi / resistive	4	IP 66	- 40° C ÷ + 85° C	Con dado With nut
			24 V	4 A resistivi / resistive	4	IP 66	- 40° C ÷ + 85° C	

SNAP-ACTION SWITCHES **HEAVY DUTY** | autoregolante self-adjusting

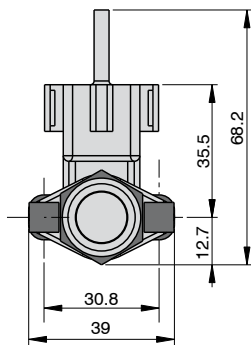

MALE CONNECTOR 4 pins

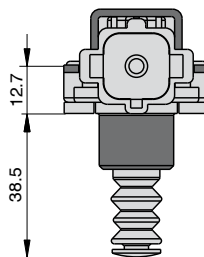

Schema Elettrico Wiring diagram

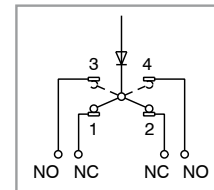

STROKE LENGTH Type A

THREADED ADAPTER WITH ZINC PLATING (corrosion resistance > 300 H)

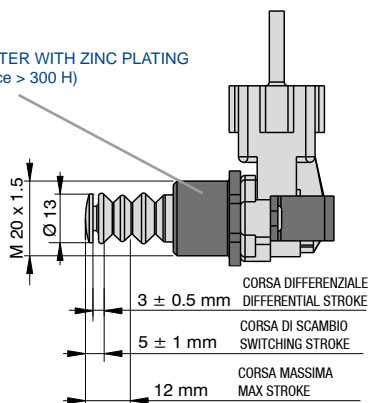

P/N	Q.ta Q. ty	TYPE	TENS. NOMINALE NOMINAL VOLTAGE	CORRENTE MAX MAX CURRENT	N° CONTATTI N° CONTACTS	GRADO DI PROT. SEALING	TEMP. DI FUNZ. OPERATING TEMP.	NOTE NOTES
1021488	10	A	12 V	8 A resistivi / resistive	4	IP 66	- 40° C ÷ + 85°C	Connettore con tappo di protezione Connector with protection plug
1021489 15-0174-0000	100		24 V	4 A resistivi / resistive	4	IP 66	- 40° C ÷ + 85°C	

FOOT DIMMER SWITCHES | STEP BY STEP



SENZA CAPPuccio - WITHOUT RUBBER BOOT

Type A

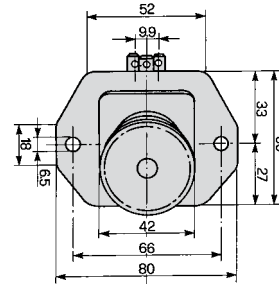
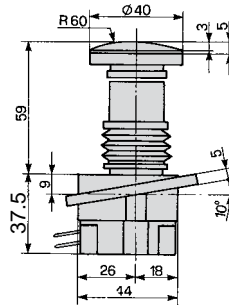

CON CAPPuccio - WITH RUBBER BOOT

Type B

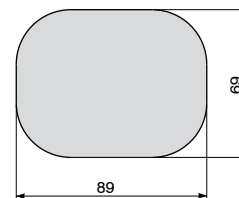
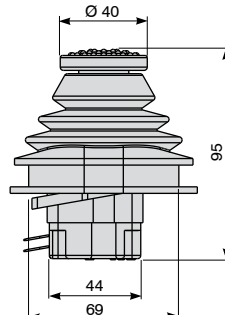

Schema Elettrico
Wiring diagram

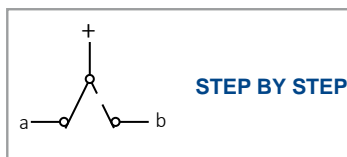

STEP BY STEP

P/N	Q.ta Q.ty	TYPE	TENS. NOMINALE NOMINAL VOLTAGE	CORRENTE MAX MAX CURRENT	N° CICLI N° LIFE CYCLES	N° CONTATTI N° CONTACTS	GRADO DI PROT. SEALING	TEMP. DI FUNZ. OPERATING TEMP.	TYPE CONNESSIONE CONNECTION TYPE
1002416	1	B	12 V	12 A resistivi / resistive	100.000	3	IP 66	- 20° C ÷ + 40° C	-
1023809	25		12 V	8 A induttivi / inductive	100.000	3	IP 66	- 20° C ÷ + 40° C	
16-182-000			24 V	8 A resistivi / resistive	100.000	3	IP 66	- 20° C ÷ + 40° C	
			24 V	5 A induttivi / inductive	100.000	3	IP 66	- 20° C ÷ + 40° C	

Con trattamento di cataforesi nera sui componenti in zama: permette un alta resistenza alla corrosione, e agli agenti atmosferici e chimici.
With black cathoresis treatment on zama components: allows high resistance to corrosion, atmospheric and chemical agents.

P/N	Q.ta Q.ty	TYPE	TENS. NOMINALE NOMINAL VOLTAGE	CORRENTE MAX MAX CURRENT	N° CICLI N° LIFE CYCLES	N° CONTATTI N° CONTACTS	GRADO DI PROT. SEALING	TEMP. DI FUNZ. OPERATING TEMP.	TYPE CONNESSIONE CONNECTION TYPE
2189428	1	A	12 V	12 A resistivi / resistive	100.000	3	IP 66	- 20° C ÷ + 40° C	-
16-0590-0100			12 V	8 A induttivi / inductive	100.000	3	IP 66	- 20° C ÷ + 40° C	
			24 V	8 A resistivi / resistive	100.000	3	IP 66	- 20° C ÷ + 40° C	
			24 V	5 A induttivi / inductive	100.000	3	IP 66	- 20° C ÷ + 40° C	
1109841	1	B	12 V	12 A resistivi / resistive	100.000	3	IP 66	- 20° C ÷ + 40° C	-
16-0590-0000			12 V	8 A induttivi / inductive	100.000	3	IP 66	- 20° C ÷ + 40° C	
			24 V	5 A induttivi / inductive	100.000	3	IP 66	- 20° C ÷ + 40° C	

FOOT DIMMER SWITCHES | MOMENTARY



SENZA CAPPuccio - WITHOUT RUBBER BOOT

Type A

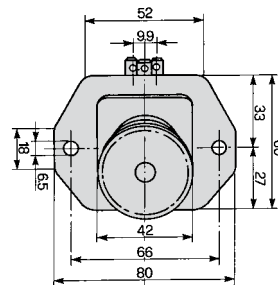
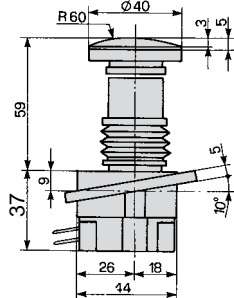

CON CAPPuccio - WITH RUBBER BOOT

Type B

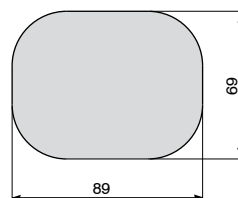
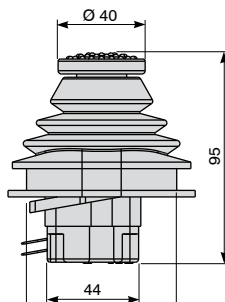

Type 1

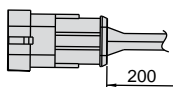

MALE CONNECTOR AMP S/SEAL 3 pins

Type 2

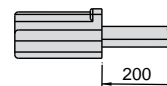

PACKARD CONNECTOR 3 pins

Schema Elettrico
Wiring diagram

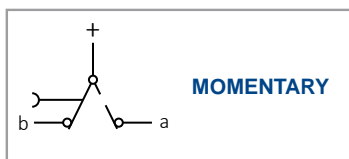

MOMENTARY

P/N	Q.ta Q.ty	TYPE	TENS. NOMINALE NOMINAL VOLTAGE	CORRENTE MAX MAX CURRENT	N° CICLI N° LIFE CYCLES	N° CONTATTI N° CONTACTS	GRADO DI PROT. SEALING	TEMP. DI FUNZ. OPERATING TEMP.	TYPE CONNESSIONE CONNECTION TYPE
1026347 1026348 17-199-100	1	A	12 V	12 A resistivi / resistive	100.000	3	IP 66	-20° C ÷ +40° C	-
			12 V	8 A induttivi / inductive	100.000	3	IP 66	-20° C ÷ +40° C	
	20		24 V	8 A resistivi / resistive	100.000	3	IP 66	-20° C ÷ +40° C	
			24 V	5 A induttivi / inductive	100.000	3	IP 66	-20° C ÷ +40° C	
1057272 17-0577-0000	1	A	12 V	12 A resistivi / resistive	100.000	3	IP 66	-20° C ÷ +40° C	1
			12 V	8 A induttivi / inductive	100.000	3	IP 66	-20° C ÷ +40° C	
			24 V	8 A resistivi / resistive	100.000	3	IP 66	-20° C ÷ +40° C	
			24 V	5 A induttivi / inductive	100.000	3	IP 66	-20° C ÷ +40° C	
1080747 1080748 17-0588-0000	1	A	12 V	12 A resistivi / resistive	100.000	3	IP 66	-20° C ÷ +40° C	2
			12 V	8 A induttivi / inductive	100.000	3	IP 66	-20° C ÷ +40° C	
	20		24 V	8 A resistivi / resistive	100.000	3	IP 66	-20° C ÷ +40° C	
			24 V	5 A induttivi / inductive	100.000	3	IP 66	-20° C ÷ +40° C	
1026345 1026346 17-199-000	1	B	12 V	12 A resistivi / resistive	100.000	3	IP 66	-20° C ÷ +40° C	-
			12 V	8 A induttivi / inductive	100.000	3	IP 66	-20° C ÷ +40° C	
	25		24 V	8 A resistivi / resistive	100.000	3	IP 66	-20° C ÷ +40° C	
			24 V	5 A induttivi / inductive	100.000	3	IP 66	-20° C ÷ +40° C	

FOOT DIMMER SWITCHES | STEP BY STEP

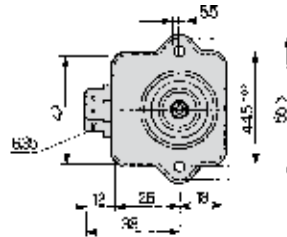
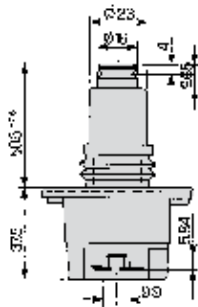

Schema Elettrico
Wiring diagram



STEP BY STEP

P/N	Q.ta Q.ty	TYPE	TENS. NOMINALE NOMINAL VOLTAGE	CORRENTE MAX MAX CURRENT	N° CICLI N° LIFE CYCLES	N° CONTATTI N° CONTACTS	GRADO DI PROT. SEALING	TEMP. DI FUNZ. OPERATING TEMP.	TYPE CONNESSIONE CONNECTION TYPE
1023805	1		12 V	12 A resistivi / resistive	100.000	3	IP 66	-20° C ÷ +40° C	
1023806	60		12 V	8 A induttivi / inductive	100.000	3	IP 66	-20° C ÷ +40° C	
16-181-000			24 V	8 A resistivi / resistive	100.000	3	IP 67	-20° C ÷ +40° C	
			24 V	5 A induttivi / inductive	100.000	3	IP 66	-20° C ÷ +40° C	

FOOT DIMMER SWITCHES | MOMENTARY

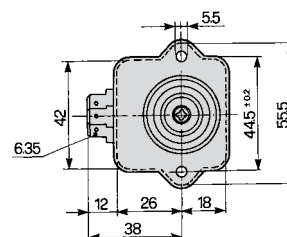
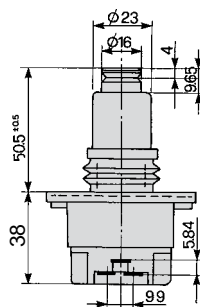

Schema Elettrico
Wiring diagram

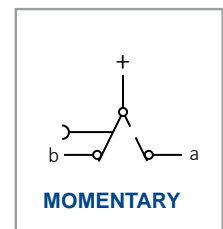

MOMENTARY

P/N	Q.ta Q.ty	TYPE	TENS. NOMINALE NOMINAL VOLTAGE	CORRENTE MAX MAX CURRENT	N° CICLI N° LIFE CYCLES	N° CONTATTI N° CONTACTS	GRADO DI PROT. SEALING	TEMP. DI FUNZ. OPERATING TEMP.	TYPE CONNESSIONE CONNECTION TYPE
1026340	1		12 V	12 A resistivi / resistive	100.000	3	IP 66	-20° C ÷ +40° C	
1026341	50		12 V	8 A induttivi / inductive	100.000	3	IP 66	-20° C ÷ +40° C	
17-194-000			24 V	8 A resistivi / resistive	100.000	3	IP 67	-20° C ÷ +40° C	
			24 V	5 A induttivi / inductive	100.000	3	IP 66	-20° C ÷ +40° C	

ACCESSORIES

Cappuccio di protezione
Protection cap



P/N	Q.ta Q.ty
1021504	10
1021505	100
15-104-005	

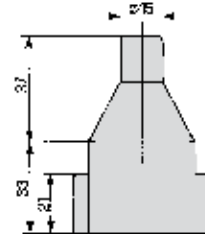
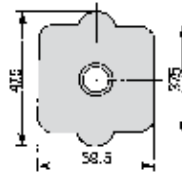

Cappuccio di protezione
Protection cap



P/N	Q.ta Q.ty
1021506	10
1021507	100
15-105-007	

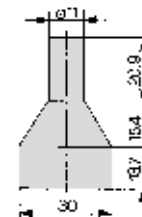
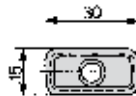

Cappuccio di protezione
Protection cap



P/N	Q.ta Q.ty
1026106	10
1026107	100
17-111-001	

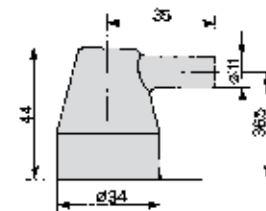
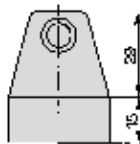

Cappuccio di protezione
Protection cap



P/N	Q.ta Q.ty
1021533	5
1021534	100
15-117-103	

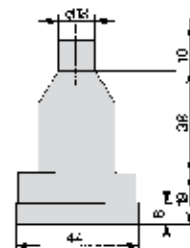
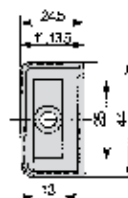

ACCESSORIES

Cappuccio di protezione
Protection cap



P/N	Q.ta Q.ty
1026136	10
1026137	100
17-122-004	

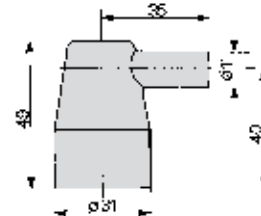
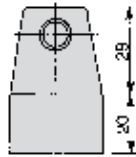

Connettore per capocorda femmina serie 6,35 mm con linguetta 4 vie
4 pins connector 6.35 mm series female terminal



P/N	Q.ta Q.ty
1030010	100
30-16-03826	

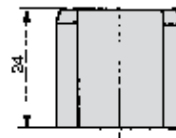
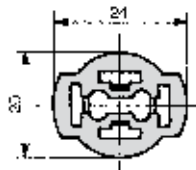

Connettore per capocorda femmina serie 6,35 mm con linguetta 4 vie
4 pins connector 6.35 mm series female terminal



P/N	Q.ta Q.ty
1030013	50
30-16-04050	

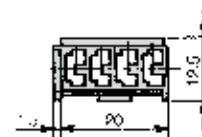
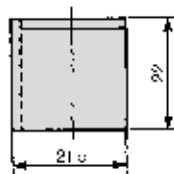

Kit di connessione femmina 4 vie con guarnizione passacavo Superseals
Connection kit 4 pins female with rubber grommet Superseals



P/N	Q.ta Q.ty
1028551	2
27-0943-0000	

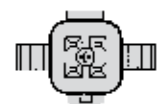
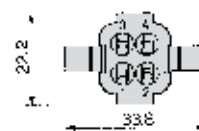

ACCESSORIES

Connettore femmina 4 vie con guarnizione passacavo Superseals
4 pins female connector with rubber grommet Superseals



P/N	Q.ta Q.ty
1030051	10
1030052	100
30-16-06497	

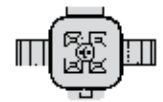
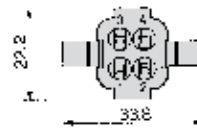
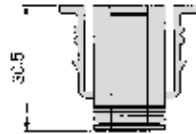

Kit di connessione maschio Superseals 2 vie
Connection kit male 2 pins Superseals



P/N	Q.ta Q.ty
1028565	1
27-0958-0000	

Kit di connessione maschio Superseals 3 vie
Connection kit male 3 pins Superseals



P/N	Q.ta Q.ty
1028518	1
27-0905-0000	

Kit di connessione maschio Superseals 4 vie
Connection kit male 4 pins Superseals



P/N	Q.ta Q.ty
1028520	1
27-0906-0000	

Kit di connessione femmina Superseals 2 vie
Connection kit female 2 pins Superseals



P/N	Q.ta Q.ty
1028566	1
27-0958-5000	

Kit di connessione femmina Superseals 3 vie
Connection kit female 3 pins Superseals



P/N	Q.ta Q.ty
1028519	1
27-0905-5000	

Kit di connessione femmina Deutsch 4 vie
Connection kit female 4 pins Deutsch



P/N	Q.ta Q.ty
1028523	1
27-0907-5000	

ACCESSORIES

Cappuccio di protezione
Protection cap



P/N	COLORE COLOR	Q.ta Q.ty
1026242 17-153-001	●	100
1026243 17-153-002	●	100
1026244 17-153-003	●	100

Leva estraibile per:
Removable handle for:
P/N **1091309** | 13-0002-0000



P/N	Q.ta Q.ty
1020367 13-002-005	10

Leva estraibile per:
Removable handle for:
P/N **1107781** - **1109493** | 13-0029-0000



P/N	Q.ta Q.ty
1020387 13-005-005	5

Leva estraibile per:
Removable handle for:
P/N **1107782** | 13-0030-0000



P/N	Q.ta Q.ty
1020391 13-006-050	10

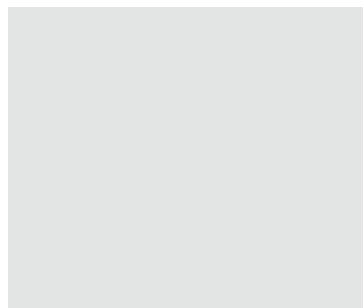

P/N	Q.ta Q.ty

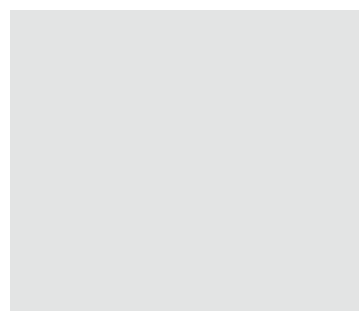

P/N	Q.ta Q.ty

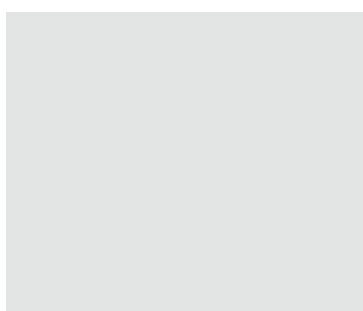

P/N	Q.ta Q.ty

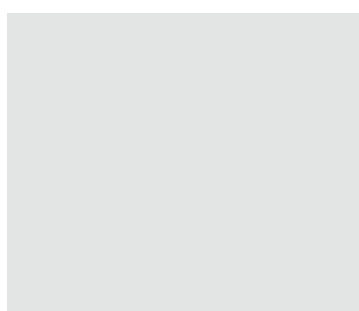

P/N	Q.ta Q.ty

pagina page	pagina page	pagina page	pagina page	pagina page	pagina page
1001884 9	1021533 60	1025404 34	1026270 46	1030266 19	
1002416 56	1021534 60	1025406 34	1026281 30	1030267 19	
1003687 24	1021536 16	1025407 34	1026286 40	1057234 31	
1020355 5	1021538 15	1025408 34	1026288 27	1057272 57	
1020357 5	1021552 48	1025410 33	1026290 32	1057946 50	
1020363 9	1021557 16	1025411 46	1026291 32	1057947 50	
1020367 63	1021562 51	1025412 25	1026293 39	1078657 35	
1020387 63	1021563 51	1025416 36	1026294 39	1078658 35	
1020391 63	1021569 17	1025417 29	1026303 39	1080747 57	
1021469 49	1021576 14	1025419 35	1026305 45	1080748 57	
1021470 49	1021579 14	1025423 42	1026307 45	1088003 34	
1021472 12	1021589 53	1025424 42	1026310 45	1091131 41	
1021474 49	1021590 53	1025425 40	1026318 31	1091132 41	
1021475 49	1021592 54	1025426 40	1026338 28	1091133 41	
1021477 50	1021593 54	1025427 25	1026340 58	1091134 41	
1021478 50	1021595 53	1025428 26	1026341 58	1091309 6	
1021479 53	1021597 52	1025431 40	1026345 57	1095276 10	
1021480 51	1021599 51	1025590 30	1026346 57	1095277 10	
1021481 51	1021600 51	1025592 45	1026347 57	1098379 23	
1021483 17	1021602 15	1025593 45	1026348 57	1102787 43	
1021484 14	1021607 54	1025645 47	1026350 32	1102788 43	
1021485 14	1021608 54	1025646 47	1026352 47	1104334 43	
1021486 54	1021631 20	1026089 24	1026353 47	1104335 43	
1021487 54	1021633 20	1026104 38	1026356 38	1105508 44	
1021488 55	1023805 58	1026105 38	1026358 26	1105509 44	
1021489 55	1023806 58	1026106 60	1026370 40	1105521 44	
1021490 50	1023809 56	1026107 60	1026371 40	1105522 44	
1021491 50	1023821 22	1026118 38	1026381 35	1107779 6	
1021492 51	1023886 22	1026131 27	1026391 37	1107780 8	
1021493 51	1023887 22	1026135 40	1026392 37	1107781 7	
1021502 13	1023898 21	1026136 61	1028518 62	1107782 7	
1021503 13	1023900 21	1026137 61	1028519 62	1108363 54	
1021504 60	1023907 23	1026139 26	1028520 62	1109493 7	
1021505 60	1023912 10	1026142 28	1028523 62	1109494 8	
1021506 60	1023938 21	1026143 28	1028551 61	1109495 6	
1021507 60	1023940 20	1026145 25	1028565 62	1109841 56	
1021512 13	1025385 47	1026151 25	1028566 62	1110414 8	
1021514 48	1025386 47	1026163 25	1030010 61	1111790 25	
1021515 48	1025387 47	1026234 40	1030013 61	1111791 25	
1021517 11	1025388 47	1026240 26	1030051 62	2007614 38	
1021518 11	1025389 36	1026241 26	1030052 62	2189428 56	
1021520 11	1025390 36	1026242 63	1030250 18		
1021523 11	1025391 34	1026243 63	1030251 18		
1021525 12	1025398 29	1026244 63	1030261 18		
1021526 12	1025400 29	1026264 47	1030262 18		
1021528 13	1025402 29	1026265 47	1030263 18		
1021530 49	1025403 29	1026267 46	1030264 19		
1021531 49	1025404 29	1026268 46	1030265 19		

pagina <i>page</i>	pagina <i>page</i>	pagina <i>page</i>	pagina <i>page</i>	pagina <i>page</i>	pagina <i>page</i>
0M562760009	15-0173-000054	17-176-00045	17-0602-000043		
13-0002-00006	15-0174-000055	17-177-00045	17-0603-000044		
13-002-00563	15-0175-000050	17-178-00045	17-0604-000044		
13-005-00563	15-0176-000051	17-186-00031	17-0605-000043		
13-006-05063	15-0190-000050	17-193-00028	17-0606-000025		
13-0013-00005	15-0191-000010	17-194-00058	27-0905-000062		
13-0014-00005	15-0197-000054	17-199-00057	27-0905-500062		
13-0017-00009	16-181-00058	17-199-10057	27-0906-000062		
13-0027-00006	16-182-00056	17-204-00032	27-0907-500062		
13-0028-00008	16-189-00022	17-205-00047	27-0943-000061		
13-0029-00007	16-193-00022	17-207-00038	27-0958-000062		
13-0030-00007	16-200-00021	17-208-00026	27-0958-500062		
13-0031-00008	16-203-00021	17-219-00040	30-16-0382661		
15-104-00013	16-211-00023	17-227-00035	30-16-0405061		
15-104-00560	16-214-00010	17-240-00037	30-16-0649762		
15-105-00760	16-234-00021	17-0243-000047	30-34-0895618		
15-107-00013	16-235-00020	17-0244-000047	30-34-0895718		
15-110-00048	16-0237-000020	17-0247-000036	30-34-1030018		
15-111-00011	16-0240-000020	17-0249-000034	30-34-1030118		
15-112-00011	16-0582-000023	17-0253-000029	30-34-1030218		
15-113-00011	16-0590-000056	17-0255-000029	30-34-1030319		
15-115-00012	16-0590-010056	17-0256-000029	30-34-1030419		
15-116-00013	17-105-00024	17-0257-000029	30-34-1030519		
15-117-00049	17-111-00038	17-0258-000034	30-34-1030619		
15-117-10360	17-111-00160	17-0259-000034	AV-17-000324		
15-119-00016	17-113-00038	17-0261-000033			
15-121-00015	17-120-00027	17-0262-000046			
15-129-00048	17-122-00040	17-0263-000025			
15-131-00016	17-122-00461	17-0268-000036			
15-133-00051	17-124-00026	17-0269-000029			
15-137-00017	17-125-00028	17-0271-000035			
15-144-00014	17-126-00025	17-0276-000042			
15-145-00014	17-130-00025	17-0277-000040			
15-150-00053	17-134-00025	17-0278-000040			
15-151-00054	17-151-00040	17-0279-000025			
15-152-00053	17-153-00026	17-0282-000034			
15-153-00052	17-153-00163	17-0283-000026			
15-154-00051	17-153-00263	17-0286-000040			
15-155-00015	17-153-00363	17-0492-000030			
15-158-00054	17-160-00047	17-0495-000045			
15-0160-000049	17-161-00046	17-0496-000045			
15-0162-000012	17-162-00046	17-0561-000047			
15-0166-000049	17-165-00030	17-0576-000031			
15-0167-000050	17-168-00040	17-0577-000057			
15-0168-000053	17-169-00027	17-0587-000035			
15-0169-000051	17-170-00032	17-0588-000057			
15-0171-000017	17-171-00039	17-0595-000041			
15-0172-000014	17-175-00039	17-0596-000041			



C.O.B.O. SpA
Via Tito Speri, 10
25024 Leno (Brescia) ITALY
Phone +39 030 90451
Fax +39 030 9045330

GERMANY



COBO Deutschland GmbH
Zum Schürmannsgraben, 12E
D-47441 - Moers
Germany
Phone: +49 (0) 2841 88238 0
info@cobogroup.net
www.cobo-deutschland.com

FRANCE



COBO France Sarl
Allée de l'Europe, 2 - Zone Coriolis
71210 - Ecuissees
France
Phone: +33 (0) 3 857 30560
info@cobogroup.net
www.cobofrance.com

NORTH AMERICA



COBO USA Ltd
West Division Street, 304
52655 - West Burlington
Iowa - Usa
Phone: +1 319 754 5585
info@cobogroup.net
www.cobointernational.com

LATIN AMERICA



COBO Components Agricolas e Industrias Ltda
Rua Dona Francisca, 8300 - Bloco 2-M
89219-600 Zona Industrial - Joinville
Santa Catarina - Brasil
Phone: +55 47 3305 0095
info@cobogroup.net
www.cobogroup.net

OCEANIA



COBO Oceania Ltd
Burnside Road, 9/93
4207 Stapylton
Brisbane Queensland
Australia
Phone: +61 (0) 7 3807 4866
info@cobogroup.net
www.cobo.com.au

SOUTH-EAST ASIA



COBO Asia Ltd
Flat/Rm 3002, 30/F,
Oxford House, 979 King's
Road, Quarry Bay
Hong Kong
Phone: +852 3511 6708 (6709)
info@cobogroup.net
www.cobogroup.net

CHINA



COBO (Guangzhou) Electronic Systems and Components Ltd
101/102 Building 7, Shi Dai Fang Zhou
30 Hua Zhou Road, Haizhu District
510220 - Guangzhou
People's Republic of China
Phone: +86 20 8922 5611
info@cobogroup.net
www.cobogroup.net

INDIA



COBO India Components & Systems Pvt Ltd
Plot no I-74, Sector 32
DLF Industrial Area
121003 - Faridabad
Haryana - India
Phone: +91 129 4871206
info@cobogroup.net
www.cobogroup.net



info@cobogroup.net | www.cobogroup.net

Le informazioni contenute nella presente informativa hanno scopo puramente indicativo.
L'Azienda si riserva senza preavviso il diritto di apportare qualsiasi modifica tecnica del prodotto.
The information published in this catalogue is purely indicative. The Company reserves the right to introduce all technological changes of the present product at any time and without prior notice.