



SWITCHES

2026

PUSH BUTTON SWITCHES



SNAP-ACTION SWITCHES



FOOT DIMMER SWITCHES





 COBO 

	pagina page
INTERRUTTORI A PULSANTE	4 - 27
PUSH BUTTON SWITCHES	
INTERRUTTORI A SCATTO RAPIDO	28 - 35
SNAP-ACTION SWITCHES	
FOOT DIMMER SWITCHES	36 - 38
COMMUTATORI A PEDALE	
ACCESSORI	40 - 43
ACCESSORIES	

PUSH BUTTON SWITCHES | avviamento motori starting engines

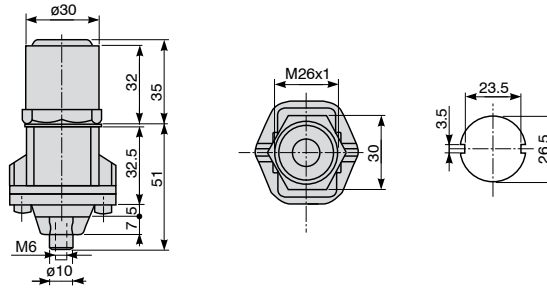

Schema Elettrico
Wiring diagram

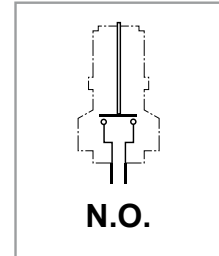

P/N	Q.ta Q.ty	TENS. NOMINALE NOMINAL VOLTAGE	CORRENTE MAX MAX CURRENT	CARICO CHIUSURA CONTATTI LOAD CONTACT CLOSURE	CARICO FINE CORSA LOAD AT END OF STROKE	GRADO DI PROT. SEALING	FILETTATURA THREADNG
1003687 AV-17-0003	1	12 V	35 A induttivi / <i>inductive</i>	18 N	80 N	IP 65	M26x1
		24 V	15 A induttivi / <i>inductive</i>	18 N	80 N	IP 65	

PUSH BUTTON SWITCHES

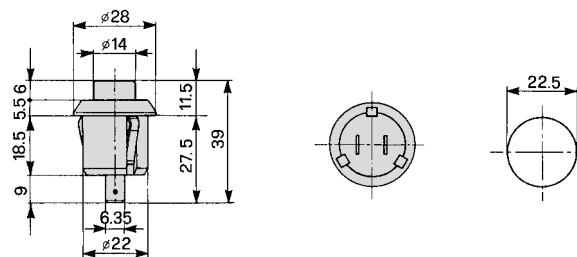

Schema Elettrico
Wiring diagram

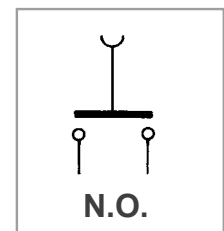

P/N	Q.ta Q.ty	TENS. NOMINALE NOMINAL VOLTAGE	CORRENTE MAX MAX CURRENT	N° CICLI N° LIFE CYCLES	N° CONTATTI N° CONTACTS	GRADO DI PROT. SEALING	TEMP. DI FUNZ. OPERATING TEMP.	COLORE CAPPUCIO CAP COLOR
1026089 17-105-000	10	12 V	25 A resistivi / <i>resistive</i>	100.000	2	IP 40	- 20° C + + 40°C	
		24 V	15 A resistivi / <i>resistive</i>	100.000	2	IP 40	- 20° C + + 40°C	

PUSH BUTTON SWITCHES

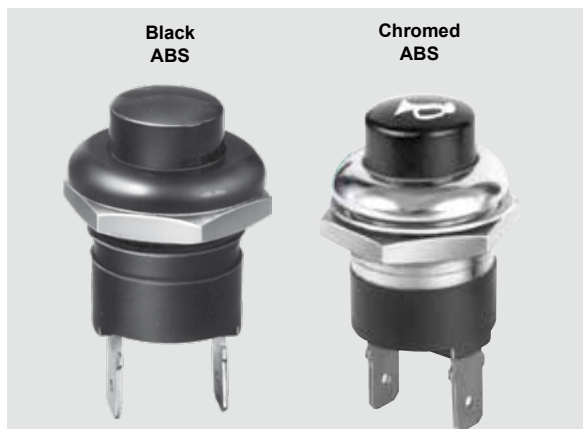

Type A

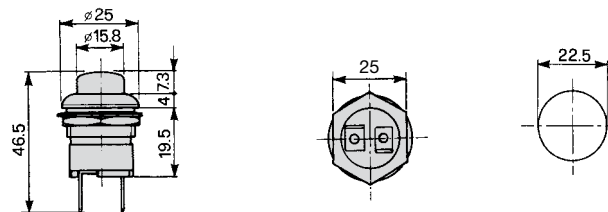

Type B

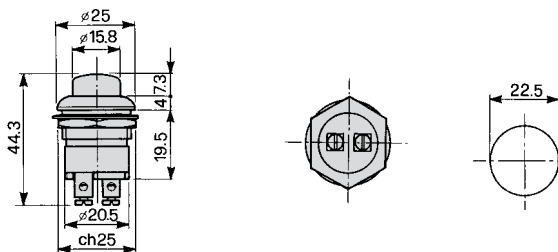

Schema Elettrico
Wiring diagram

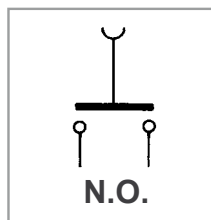



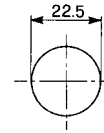
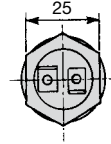
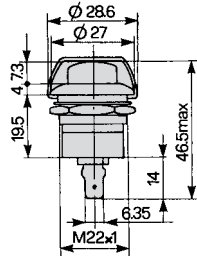

P/N	Q.ta Q.ty	TYPE	TENS. NOMINALE NOMINAL VOLTAGE	CORRENTE MAX MAX CURRENT	N° CICLI N° LIFE CYCLES	N° CONTATTI N° CONTACTS	GRADO DI PROT. SEALING	TEMP. DI FUNZ. OPERATING TEMP.	HOUSING MATERIAL	SIMBOLO ICONS
1026151 17-130-000	10	A	12 V	25 A induttivi / inductive	10.000	2	IP 40	-20° C ++ 40° C	Black ABS	-
			24 V	25 A induttivi / inductive	10.000	2	IP 40	-20° C ++ 40° C		
1026145 17-126-000	10	B	12 V	25 A induttivi / inductive	10.000	2	IP 40	-20° C ++ 40° C	Black ABS	-
			24 V	25 A induttivi / inductive	10.000	2	IP 40	-20° C ++ 40° C		
1026163 17-134-000	10	A	12 V	25 A induttivi / inductive	10.000	2	IP 40	-20° C ++ 40° C	Chromed ABS	
			24 V	25 A induttivi / inductive	10.000	2	IP 40	-20° C ++ 40° C		
1025412 17-0263-0000	200	A	12 V	25 A induttivi / inductive	10.000	2	IP 40	-20° C ++ 40° C	Black ABS	
			24 V	25 A induttivi / inductive	10.000	2	IP 40	-20° C ++ 40° C		
1025427 17-0279-0000	10	A	12 V	25 A induttivi / inductive	10.000	2	IP 40	-20° C ++ 40° C	Black ABS	
			24 V	25 A induttivi / inductive	10.000	2	IP 40	-20° C ++ 40° C		
1111790 1111791 17-0606-0000	5 50	A	12 V	25 A induttivi / inductive	10.000	2	IP 40	-20° C ++ 40° C	Black ABS	
			24 V	25 A induttivi / inductive	10.000	2	IP 40	-20° C ++ 40° C		

PUSH BUTTON SWITCHES

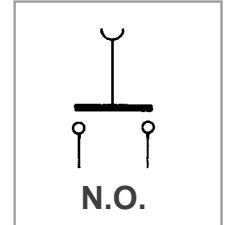

Schema Elettrico
Wiring diagram



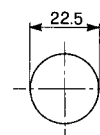
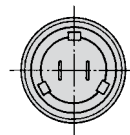
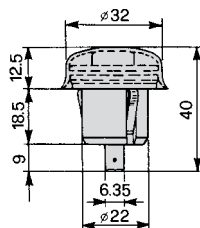

P/N	Q.ta Q.ty	TENS. NOMINALE NOMINAL VOLTAGE	CORRENTE MAX MAX CURRENT	N° CICLI N° LIFE CYCLES	N° CONTATTI N° CONTACTS	GRADO DI PROT. SEALING	TEMP. DI FUNZ. OPERATING TEMP.	COLORE CAPPUCCIO CAP COLOR
1026240 1026241 17-153-000	10 100	12 V	25 A resistivi / resistive	-	2	IP 40	- 20° C ++ 40°C	
		24 V	15 A resistivi / resistive	-	2	IP 40	- 20° C ++ 40°C	
1025428 17-0283-0000	10	12 V	25 A induttivi / inductive	-	4	IP 40	- 20° C ++ 40°C	
		24 V	15 A induttivi / inductive	-	4	IP 40	- 20° C ++ 40°C	
1026358 17-208-000	1	12 V	25 A resistivi / resistive	-	2	IP 40	- 20° C ++ 40°C	
		24 V	15 A resistivi / resistive	-	2	IP 40	- 20° C ++ 40°C	

PUSH BUTTON SWITCHES

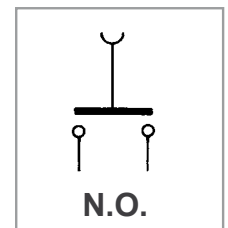

Schema Elettrico
Wiring diagram



P/N	Q.ta Q.ty	TENS. NOMINALE NOMINAL VOLTAGE	CORRENTE MAX MAX CURRENT	N° CICLI N° LIFE CYCLES	N° CONTATTI N° CONTACTS	GRADO DI PROT. SEALING	TEMP. DI FUNZ. OPERATING TEMP.	COLORE CAPPUCCIO CAP COLOR
1026139 17-124-000	5	12 V	25 A resistivi / resistive	-	2	IP 40	- 20° C ++ 40°C	
		24 V	15 A resistivi / resistive	-	2	IP 40	- 20° C ++ 40°C	

PUSH BUTTON SWITCHES

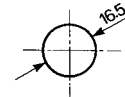
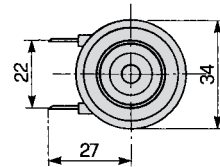
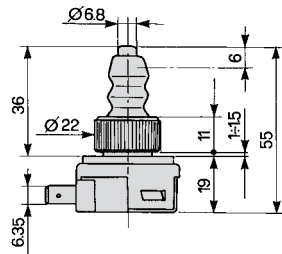

Schema Elettrico
Wiring diagram

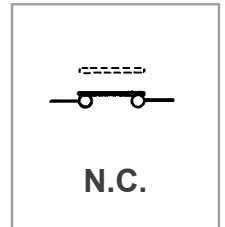

P/N	Q.ta Q.ty	TENS. NOMINALE NOMINAL VOLTAGE	CORRENTE MAX MAX CURRENT	N° CICLI N° LIFE CYCLES	N° CONTATTI N° CONTACTS	GRADO DI PROT. SEALING	TEMP. DI FUNZ. OPERATING TEMP.	NOTE
1026288 17-169-000	10	12 V	4 A resistivi / resistive	50.000	2	IP 66	- 20° C + + 40°C	
		24 V	2 A resistivi / resistive	50.000	2	IP 66	- 20° C + + 40°C	

PUSH BUTTON SWITCHES | per comando luce retromarcia for reversing light control

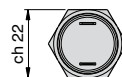
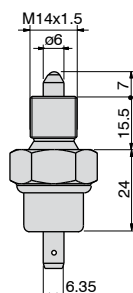

Schema Elettrico
Wiring diagram

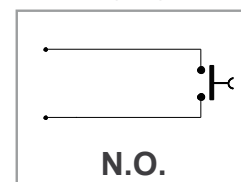

P/N	Q.ta Q.ty	TENS. NOMINALE NOMINAL VOLTAGE	CORRENTE MAX MAX CURRENT	N° CICLI N° LIFE CYCLES	N° CONTATTI N° CONTACTS	GRADO DI PROT. SEALING	TEMP. DI FUNZ. OPERATING TEMP.	FILETTATURA THREADING
1026131 17-120-000	50	12 V	8 A resistivi / resistive	100.000	2	IP 67	- 20° C + + 40°C	M14x1,5 6g
		24 V	4 A resistivi / resistive	100.000	2	IP 67	- 20° C + + 40°C	

PUSH BUTTON SWITCHES | per comando luce retromarcia

for reversing light control

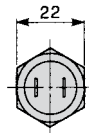
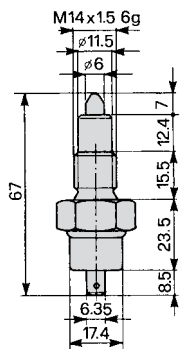

Schema Elettrico
Wiring diagram

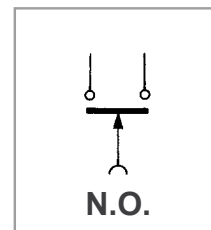

P/N	Q.ta Q.ty	TENS. NOMINALE NOMINAL VOLTAGE	CORRENTE MAX MAX CURRENT	N° CICLI N° LIFE CYCLES	N° CONTATTI N° CONTACTS	GRADO DI PROT. SEALING	TEMP. DI FUNZ. OPERATING TEMP.	FILETTATURA THREADNG
1026142	5	12 V	8 A resistivi / resistive	100.000	2	IP 67	- 20° C + + 40° C	M14x1,5 6g
1026143 17-125-000	50	24 V	4 A resistivi / resistive	100.000	2	IP 67	- 20° C + + 40° C	

PUSH BUTTON SWITCHES

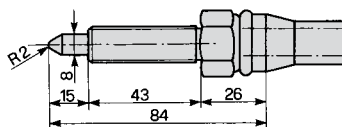
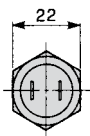

Schema Elettrico
Wiring diagram

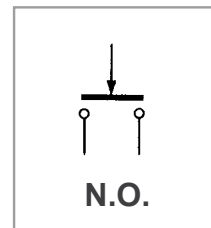

P/N	Q.ta Q.ty	TENS. NOMINALE NOMINAL VOLTAGE	CORRENTE MAX MAX CURRENT	N° CONTATTI N° CONTACTS	GRADO DI PROT. SEALING	TEMP. DI FUNZ. OPERATING TEMP.	FILETTATURA THREADNG	CONNESSIONE CONNECTION
1026338	100	12 V	6 A resistivi / resistive	2	IP 67	- 20° C + + 40° C	M14x1,5 6g	
17-193-000		24 V	3 A resistivi / resistive	2	IP 67	- 20° C + + 40° C		

PUSH BUTTON SWITCHES

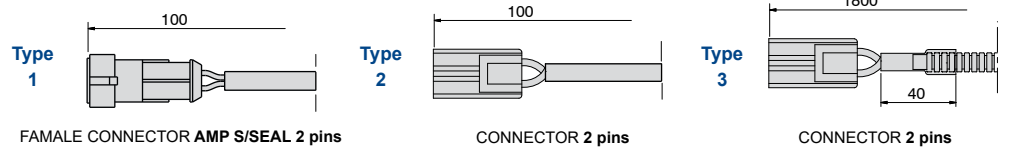
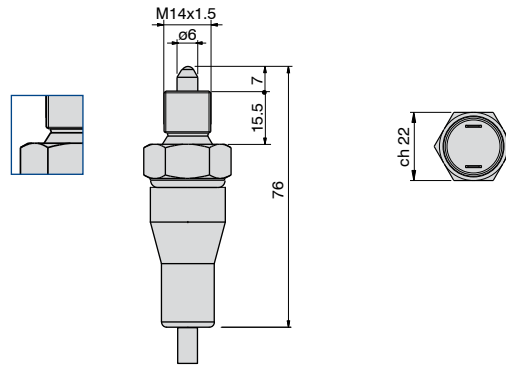

Schema Elettrico
Wiring diagram

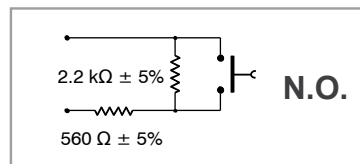

P/N	Q.ta Q.ty	TENS. NOMINALE NOMINAL VOLTAGE	CORRENTE MAX MAX CURRENT	N° CICLI N° LIFE CYCLES	N° CONTATTI N° CONTACTS	GRADO DI PROT. SEALING	TEMP. DI FUNZ. OPERATING TEMP.	TYPE	COLORE CONNETTORE COLOR CONNECTOR
1025398 17-0253-0000	40	5 V	0,5 A resistivi / resistive	200.000	2	IP 67	- 40° C ++ 105°C	1	GRIGIO - GREY AMP S/SEAL 2 pins P/N AMP 282104-2 P/N COBO 3009208
		-	-	-	-	-	-		
1025400 17-0255-0000	1	5 V	0,5 A resistivi / resistive	200.000	2	IP 67	- 40° C ++ 105°C	2	NERO - BLACK AMP 2 pins P/N AMP 344274-1 P/N COBO 30-16-06112
		-	-	-	-	-	-		
1025402 17-0256-0000	80	5 V	0,5 A resistivi / resistive	200.000	2	IP 67	- 40° C ++ 105°C	2	ROSSO - RED AMP 2 pins P/N AMP 344274-2 P/N COBO 30-16-06113
		-	-	-	-	-	-		
1025403 1025404 17-0257-0000	1 20	5 V	0,5 A resistivi / resistive	200.000	2	IP 67	- 40° C ++ 105°C	3	NERO - BLACK AMP 2 pins P/N AMP 344274-1 P/N COBO 30-16-06112
		-	-	-	-	-	-		

Schema Elettrico
Wiring diagram

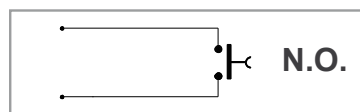

P/N	Q.ta Q.ty	TENS. NOMINALE NOMINAL VOLTAGE	CORRENTE MAX MAX CURRENT	N° CICLI N° LIFE CYCLES	N° CONTATTI N° CONTACTS	GRADO DI PROT. SEALING	TEMP. DI FUNZ. OPERATING TEMP.	TYPE	COLORE CONNETTORE COLOR CONNECTOR
1025417 17-0269-0000	20	5 V	0,5 A resistivi / resistive	200.000	2	IP 67	- 40° C ++ 105°C	3	NERO - BLACK AMP 2 pins P/N AMP 344274-1 P/N COBO 30-16-06112
		-	-	-	-	-	-		

PUSH BUTTON SWITCHES

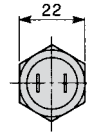
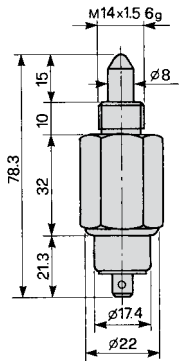
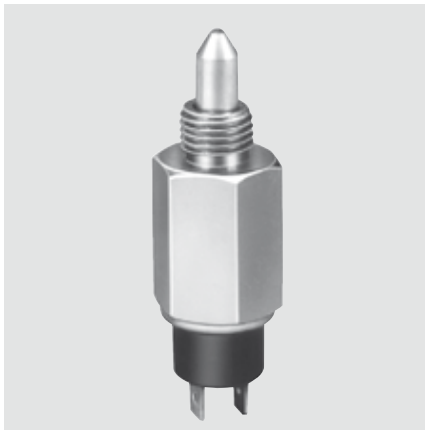

Schema Elettrico
Wiring diagram

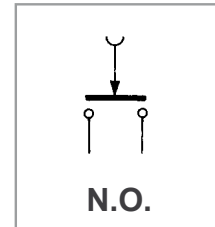

P/N	Q.ta Q.ty	TENS. NOMINALE NOMINAL VOLTAGE	CORRENTE MAX MAX CURRENT	N° CICLI N° LIFE CYCLES	N° CONTATTI N° CONTACTS	GRADO DI PROT. SEALING	TEMP. DI FUNZ. OPERATING TEMP.	FILETTATURA THREADNG
1026281 17-165-000	60	12 V	8 A resistivi / resistive	100.000	2	IP 67	- 20° C ++ 40°C	M14x1,5 6g
		24 V	4 A resistivi / resistive	100.000	2	IP 67	- 20° C ++ 40°C	

PUSH BUTTON SWITCHES

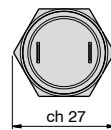
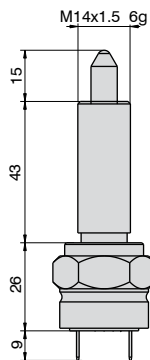

Schema Elettrico
Wiring diagram

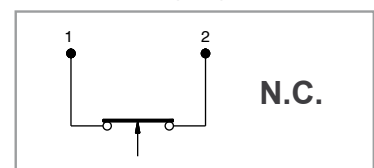

P/N	Q.ta Q.ty	TENS. NOMINALE NOMINAL VOLTAGE	CORRENTE MAX MAX CURRENT	N° CICLI N° LIFE CYCLES	N° CONTATTI N° CONTACTS	GRADO DI PROT. SEALING	TEMP. DI FUNZ. OPERATING TEMP.	FILETTATURA THREADNG
1025590 17-0492-0000	5	12 V	8 A resistivi / resistive	20.000	2	IP 65	- 40° C ++ 85°C	M14x1,5 6g
		24 V	4 A resistivi / resistive	20.000	2	IP 65	- 40° C ++ 85°C	

PUSH BUTTON SWITCHES

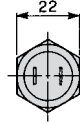
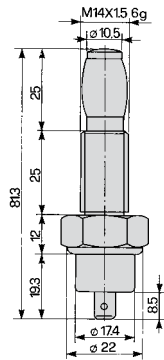

Schema Elettrico
Wiring diagram

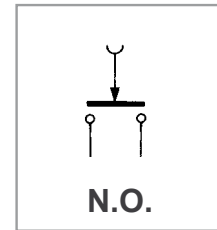

P/N	Q.ta Q.ty	TENS. NOMINALE NOMINAL VOLTAGE	CORRENTE MAX MAX CURRENT	N° CICLI N° LIFE CYCLES	N° CONTATTI N° CONTACTS	GRADO DI PROT. SEALING	TEMP. DI FUNZ. OPERATING TEMP.	FILETTATURA THREADING
1026318 17-186-000	50	12 V	8 A resistivi / resistive	-	2	IP 67	-20° C ++ 40° C	M14x1,5 6g
		24 V	4 A resistivi / resistive	-	2	IP 67	-20° C ++ 40° C	

PUSH BUTTON SWITCHES

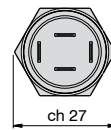
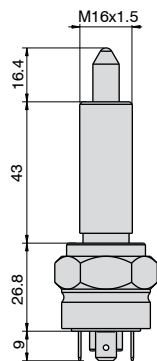

Schema Elettrico
Wiring diagram

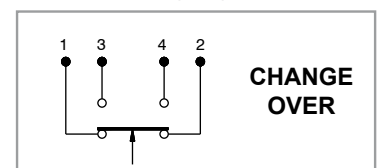

P/N	Q.ta Q.ty	TENS. NOMINALE NOMINAL VOLTAGE	CORRENTE MAX MAX CURRENT	N° CICLI N° LIFE CYCLES	N° CONTATTI N° CONTACTS	GRADO DI PROT. SEALING	TEMP. DI FUNZ. OPERATING TEMP.	FILETTATURA THREADING
1057234 17-0576-0000	1	12 V	8 A resistivi / resistive	20.000	4	IP 65	-40° C ++ 85° C	M16x1,5
		24 V	4 A resistivi / resistive	20.000	4	IP 65	-40° C ++ 85° C	

PUSH BUTTON SWITCHES | per comando luce retromarcia for reversing light control

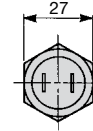
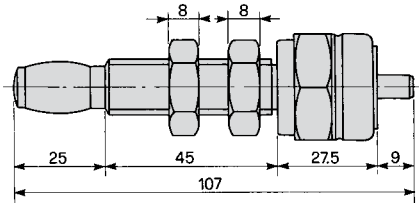

Schema Elettrico
Wiring diagram

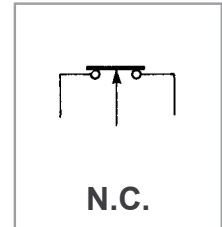

P/N	Q.ta Q.ty	TENS. NOMINALE NOMINAL VOLTAGE	CORRENTE MAX MAX CURRENT	N° CICLI N° LIFE CYCLES	N° CONTATTI N° CONTACTS	GRADO DI PROT. SEALING	TEMP. DI FUNZ. OPERATING TEMP.	FILETTATURA THREADING
1026350 17-204-000	50	12 V	10 A resistivi / resistive	-	2	IP 67	- 20° C + + 40°C	M14x1,5
		24 V	5 A resistivi / resistive	-	2	IP 67	- 20° C + + 40°C	

PUSH BUTTON SWITCHES | per consenso avviamento for start-up consent

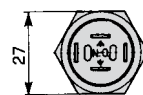
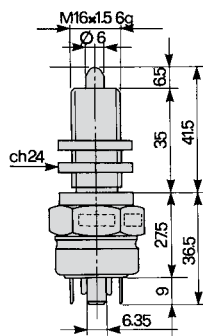

Schema Elettrico
Wiring diagram

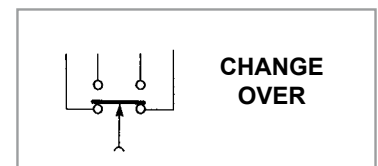

P/N	Q.ta Q.ty	TENS. NOMINALE NOMINAL VOLTAGE	CORRENTE MAX MAX CURRENT	N° CICLI N° LIFE CYCLES	N° CONTATTI N° CONTACTS	GRADO DI PROT. SEALING	TEMP. DI FUNZ. OPERATING TEMP.	FILETTATURA THREADING
1026290	5	12 V	45 A induttivi / inductive	5.000	4	IP 66	- 20° C + + 40°C	M16x1,5 6g
1026291 17-170-000	50	24 V	20 A induttivi / inductive	5.000	4	IP 66	- 20° C + + 40°C	

PUSH BUTTON SWITCHES

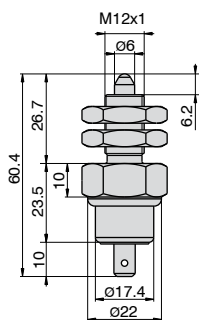

Schema Elettrico
Wiring diagram

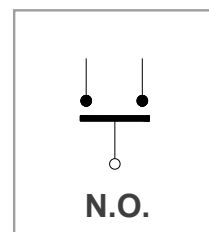

P/N	Q.ta Q.ty	TENS. NOMINALE NOMINAL VOLTAGE	CORRENTE MAX MAX CURRENT	N° CICLI N° LIFE CYCLES	N° CONTATTI N° CONTACTS	GRADO DI PROT. SEALING	TEMP. DI FUNZ. OPERATING TEMP.	FILETTATURA THREADNG
1025410 17-0261-0000	50	12 V	8 A resistivi / resistive	100.000	2	IP 67	- 40° C + + 120°C	M12x1
		24 V	4 A resistivi / resistive	100.000	2	IP 67	- 40° C + + 120°C	

PUSH BUTTON SWITCHES

CON CONTATTI ARGENTATI - WITH SILVER CONTACTS



FEMALE CONNECTOR
AMP S/SEAL 2 pins

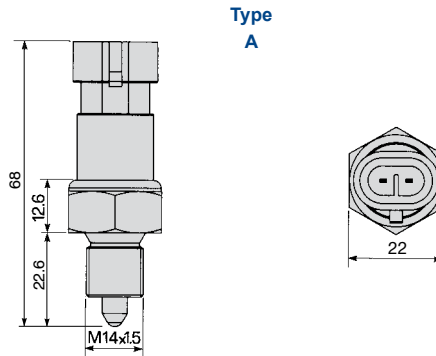

CON CONTATTI DORATI - WITH GOLD-PLATED CONTACTS





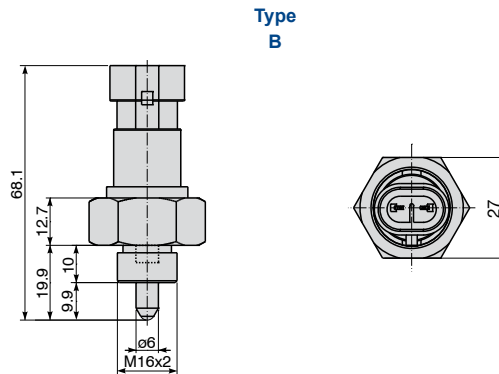



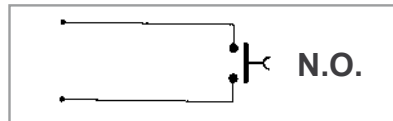

FEMALE CONNECTOR
AMP S/SEAL 2 pins



Schema Elettrico
Wiring diagram



P/N	Q.ta Q.ty	TYPE	TENS. NOMINALE NOMINAL VOLTAGE	CORRENTE MAX MAX CURRENT	N° CICLI N° LIFE CYCLES	N° CONTATTI N° CONTACTS	GRADO DI PROT. SEALING	TEMP. DI FUNZ. OPERATING TEMP.	COLORE Basetta TERMINAL BORAD COLOR
1025404 1025406 17-0258-0000	20 100	A	12 V	8 A resistivi / resistive	100.000	2	IP 67	- 40° C ++ 120°C	
			24 V	4 A resistivi / resistive	100.000	2	IP 67	- 40° C ++ 120°C	
1025407 1025408 17-0259-0000	5 100	A	12 V	8 A resistivi / resistive	100.000	2	IP 67	- 40° C ++ 120°C	
			24 V	4 A resistivi / resistive	100.000	2	IP 67	- 40° C ++ 120°C	
1088003 17-0282-0000	50	B	12 V	8 A resistivi / resistive	200.000	2	IP 66	- 40° C ++ 85°C	
			24 V	4 A resistivi / resistive	200.000	2	IP 66	- 40° C ++ 85°C	
1025391 17-0249-0000	100	A	12 V	8 A resistivi / resistive	100.000	2	IP 67	- 40° C ++ 120°C	
			24 V	4 A resistivi / resistive	100.000	2	IP 67	- 40° C ++ 120°C	

PUSH BUTTON SWITCHES

CON CONTATTI ARGENTATI - WITH SILVER CONTACTS



FEMALE CONNECTOR
AMP S/SEAL 2 pins

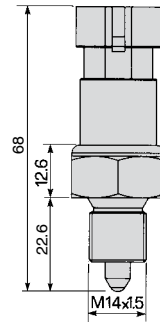

Type
A

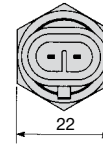

CON CONTATTI DORATI - WITH GOLD-PLATED CONTACTS



FEMALE CONNECTOR
AMP S/SEAL 2 pins

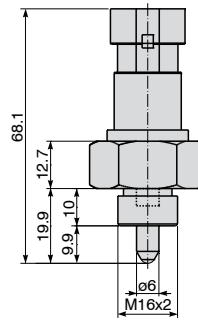

Type
B

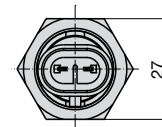

Schema Elettrico
Wiring diagram

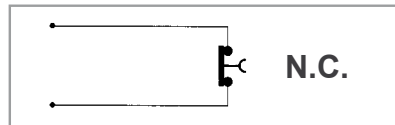

P/N	Q.ta Q.ty	TYPE	TENS. NOMINALE NOMINAL VOLTAGE	CORRENTE MAX MAX CURRENT	N° CICLI N° LIFE CYCLES	N° CONTATTI N° CONTACTS	GRADO DI PROT. SEALING	TEMP. DI FUNZ. OPERATING TEMP.	COLORE BASETTA TERMINAL BORAD COLOR
1026381 17-227-000	100	A	12 V	8 A resistivi / resistive	100.000	2	IP 67	- 40° C ++ 120°C	
			24 V	4 A resistivi / resistive	100.000	2	IP 67	- 40° C ++ 120°C	
1025419 17-0271-0000	1	B	12 V	8 A resistivi / resistive	200.000	2	IP 66	- 40° C ++ 85°C	
			24 V	4 A resistivi / resistive	200.000	2	IP 66	- 40° C ++ 85°C	

Schema Elettrico
Wiring diagram

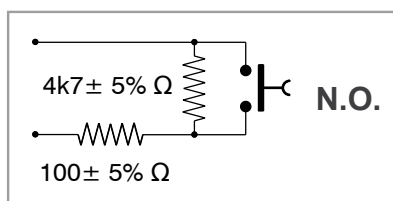

P/N	Q.ta Q.ty	TYPE	TENS. NOMINALE NOMINAL VOLTAGE	CORRENTE MAX MAX CURRENT	N° CICLI N° LIFE CYCLES	N° CONTATTI N° CONTACTS	GRADO DI PROT. SEALING	TEMP. DI FUNZ. OPERATING TEMP.	COLORE BASETTA TERMINAL BORAD COLOR
1078657 1078658 17-0587-0000	1	A	12 V	8 A resistivi / resistive	100.000	2	IP 67	- 40° C ++ 120°C	
	100		24 V	4 A resistivi / resistive	100.000	2	IP 67	- 40° C ++ 120°C	

PUSH BUTTON SWITCHES

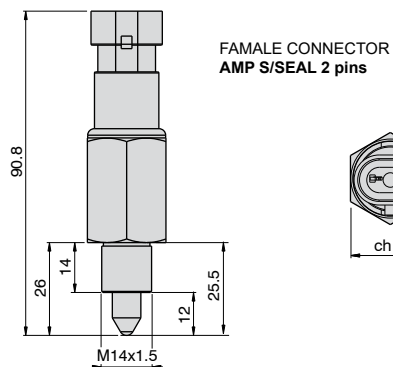

Schema Elettrico
Wiring diagram

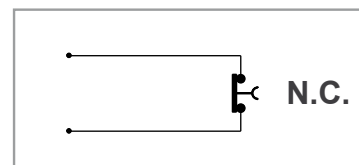

P/N	Q.ta Q.ty	TENS. NOMINALE NOMINAL VOLTAGE	CORRENTE MAX MAX CURRENT	N° CICLI N° LIFE CYCLES	N° CONTATTI N° CONTACTS	GRADO DI PROT. SEALING	TEMP. DI FUNZ. OPERATING TEMP.	FILETTATURA THREADNG
1025389	5	12 V	8 A resistivi / resistive	10.000	2	IP 66	- 40° C ++ 120°C	M14x1.5
1025390 17-0247-0000	50	24 V	4 A resistivi / resistive	10.000	2	IP 66	- 40° C ++ 120°C	

PUSH BUTTON SWITCHES

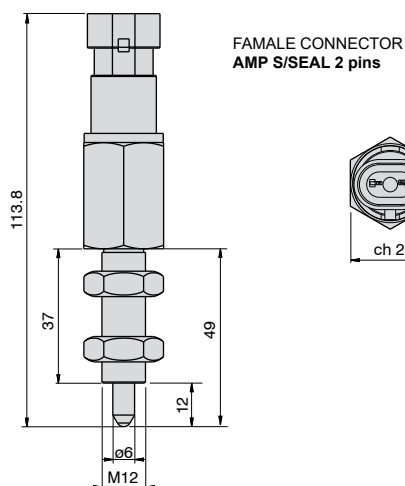

Schema Elettrico
Wiring diagram

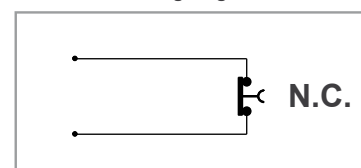

P/N	Q.ta Q.ty	TENS. NOMINALE NOMINAL VOLTAGE	CORRENTE MAX MAX CURRENT	N° CICLI N° LIFE CYCLES	N° CONTATTI N° CONTACTS	GRADO DI PROT. SEALING	TEMP. DI FUNZ. OPERATING TEMP.	FILETTATURA THREADNG
1025416	50	12 V	8 A resistivi / resistive	10.000	2	IP 66	- 40° C ++ 120°C	M12
17-0268-0000		24 V	4 A resistivi / resistive	10.000	2	IP 66	- 40° C ++ 120°C	

PUSH BUTTON SWITCHES

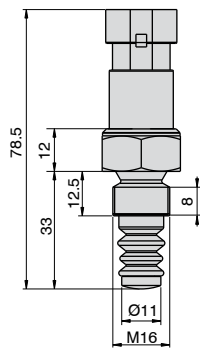

FEMALE CONNECTOR
AMP S/SEAL 2 pins



Schema Elettrico
Wiring diagram

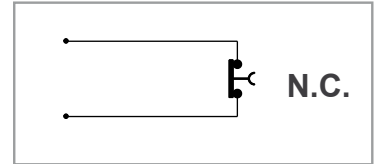

P/N	Q.ta Q.ty	TENS. NOMINALE NOMINAL VOLTAGE	CORRENTE MAX MAX CURRENT	N° CICLI N° LIFE CYCLES	N° CONTATTI N° CONTACTS	GRADO DI PROT. SEALING	TEMP. DI FUNZ. OPERATING TEMP.	FILETTATURA THREADNG
1026391	1	12 V	8 A resistivi / resistive	100.000	2	IP 66	- 40° C + + 120°C	M16
1026392 17-240-000	50	24 V	4 A resistivi / resistive	100.000	2	IP 66	- 40° C + + 120°C	

PUSH BUTTON SWITCHES | per consenso avviamento for start-up consent

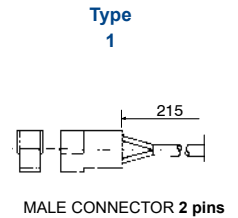
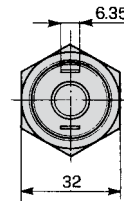
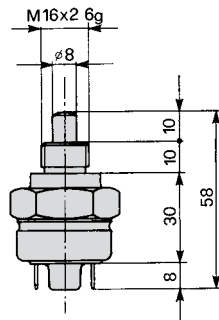

Schema Elettrico
Wiring diagram

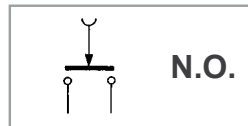

P/N	Q.ta Q.ty	TENS. NOMINALE NOMINAL VOLTAGE	CORRENTE MAX MAX CURRENT	N° CICLI N° LIFE CYCLES	N° CONTATTI N° CONTACTS	GRADO DI PROT. SEALING	TEMP. DI FUNZ. OPERATING TEMP.	FILETTATURA THREADNG	TYPE CONNESSIONE CONNECTION TYPE
1026104	5	12 V	45 A induttivi / inductive	5.000	2	IP 66	- 20° C ++ 40°C	M16x2 6g	-
1026105 17-111-000	50	24 V	20 A induttivi / inductive	5.000	2	IP 66	- 20° C ++ 40°C		
									-

Schema Elettrico
Wiring diagram

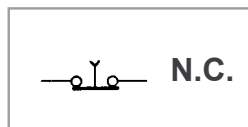

P/N	Q.ta Q.ty	TENS. NOMINALE NOMINAL VOLTAGE	CORRENTE MAX MAX CURRENT	N° CICLI N° LIFE CYCLES	N° CONTATTI N° CONTACTS	GRADO DI PROT. SEALING	TEMP. DI FUNZ. OPERATING TEMP.	FILETTATURA THREADNG	TYPE CONNESSIONE CONNECTION TYPE
2007614	5	12 V	45 A induttivi / inductive	5.000	2	IP 66	- 20° C ++ 40°C	M16x2 6g	-
1026118 17-113-000	50	24 V	20 A induttivi / inductive	5.000	2	IP 66	- 20° C ++ 40°C		
1026356 17-207-000	1	12 V	45 A induttivi / inductive	5.000	2	IP 66	- 20° C ++ 40°C	M16x2 6g	1
		24 V	20 A induttivi / inductive	5.000	2	IP 66	- 20° C ++ 40°C		

PUSH BUTTON SWITCHES

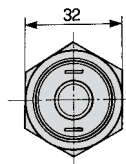
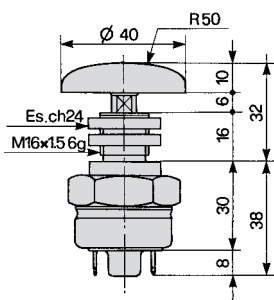

Schema Elettrico
Wiring diagram

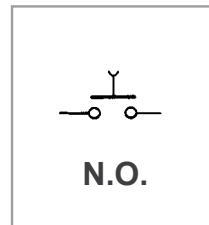

P/N	Q.ta Q.ty	TENS. NOMINALE NOMINAL VOLTAGE	CORRENTE MAX MAX CURRENT	N° CICLI N° LIFE CYCLES	N° CONTATTI N° CONTACTS	GRADO DI PROT. SEALING	TEMP. DI FUNZ. OPERATING TEMP.	FILETTATURA THREADING
1026293	5	12 V	45 A induttivi / inductive	5.000	2	IP 66	- 20° C + + 40°C	M16x1,5 6g
1026294 17-171-000	50	24 V	20 A induttivi / inductive	5.000	2	IP 66	- 20° C + + 40°C	

PUSH BUTTON SWITCHES | per consenso avviamento for start-up consent

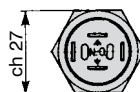
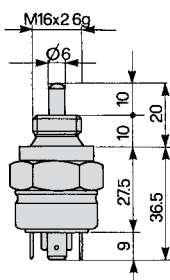
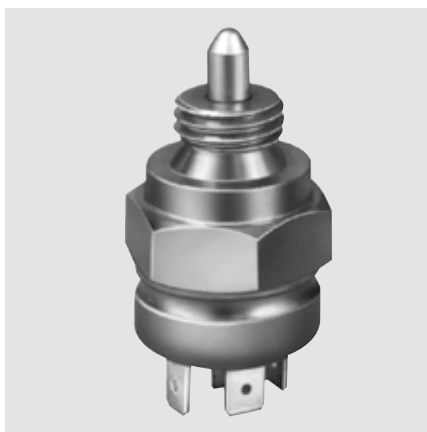

Schema Elettrico
Wiring diagram

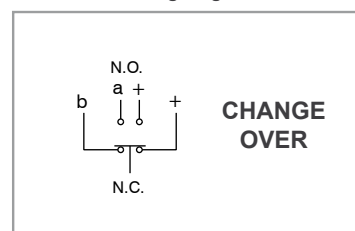

P/N	Q.ta Q.ty	TENS. NOMINALE NOMINAL VOLTAGE	CORRENTE MAX MAX CURRENT	N° CICLI N° LIFE CYCLES	N° CONTATTI N° CONTACTS	GRADO DI PROT. SEALING	TEMP. DI FUNZ. OPERATING TEMP.	FILETTATURA THREADING
1026303	10	12 V	45 A induttivi / inductive	5.000	4	IP 66	- 20° C + + 85°C	M16x2 6g
17-175-000		24 V	20 A induttivi / inductive	5.000	4	IP 66	- 20° C + + 85°C	

PUSH BUTTON SWITCHES | per consenso avviamento for start-up consent

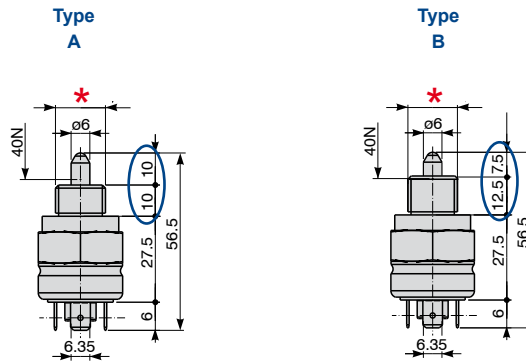

Schema Elettrico
Wiring diagram

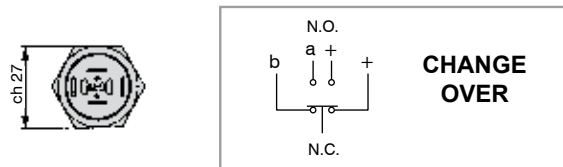

P/N	Q.ta Q.ty	TYPE	TENS. NOMINALE NOMINAL VOLTAGE	CORRENTE MAX MAX CURRENT	N° CICLI N° LIFE CYCLES	N° CONTATTI N° CONTACTS	GRADO DI PROT. SEALING	TEMP. DI FUNZ. OPERATING TEMP.	ACTUATION FORCE	* FILETTATURA THREADING
1026135 17-122-000	100	A	12 V	45 A induttivi / inductive	5.000	4	IP 66	-20° C ++ 85° C	-	M16x1,5 6g
			24 V	20 A induttivi / inductive	5.000	4	IP 66	-20° C ++ 85° C		
1025431 17-0286-0000	100	A	12 V	45 A induttivi / inductive	5.000	4	IP 66	-20° C ++ 85° C	40 N	M16x1,5 6g
			24 V	20 A induttivi / inductive	5.000	4	IP 66	-20° C ++ 85° C		
1026286 17-168-000	50	A	12 V	45 A induttivi / inductive	5.000	4	IP 66	-20° C ++ 85° C	-	M16x2 6g
			24 V	20 A induttivi / inductive	5.000	4	IP 66	-20° C ++ 85° C		
1026370 1026371 17-219-000	5	B	12 V	45 A induttivi / inductive	5.000	4	IP 66	-20° C ++ 85° C	-	M16x2 6g
	100		24 V	20 A induttivi / inductive	5.000	4	IP 66	-20° C ++ 85° C		
1025425 17-0277-0000	100	A	12 V	45 A induttivi / inductive	5.000	4	IP 66	-20° C ++ 85° C	-	M18x1,5 6g
			24 V	20 A induttivi / inductive	5.000	4	IP 66	-20° C ++ 85° C		

Schema Elettrico
Wiring diagram

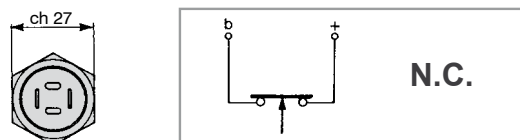

P/N	Q.ta Q.ty	TYPE	TENS. NOMINALE NOMINAL VOLTAGE	CORRENTE MAX MAX CURRENT	N° CICLI N° LIFE CYCLES	N° CONTATTI N° CONTACTS	GRADO DI PROT. SEALING	TEMP. DI FUNZ. OPERATING TEMP.	ACTUATION FORCE	* FILETTATURA THREADING
1026234 17-151-000	100	A	12 V	45 A induttivi / inductive	5.000	2	IP 66	-20° C ++ 85° C	-	M16x1,5 6g
			24 V	20 A induttivi / inductive	5.000	2	IP 66	-20° C ++ 85° C		
1025426 17-0278-0000	50	A	12 V	45 A induttivi / inductive	5.000	2	IP 66	-20° C ++ 85° C	-	M18x1,5 6g
			24 V	20 A induttivi / inductive	5.000	2	IP 66	-20° C ++ 85° C		

PUSH BUTTON SWITCHES | per consenso avviamento for start-up consent

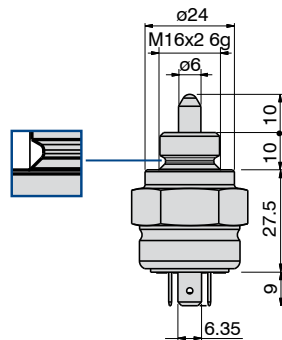

Schema Elettrico
Wiring diagram

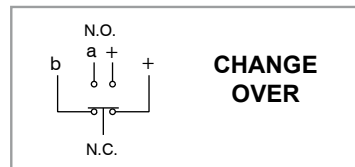
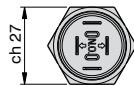

P/N	Q.ta Q.ty	TENS. NOMINALE NOMINAL VOLTAGE	CORRENTE MAX MAX CURRENT	N° CICLI N° LIFE CYCLES	N° CONTATTI N° CONTACTS	GRADO DI PROT. SEALING	TEMP. DI FUNZ. OPERATING TEMP.	FILETTATURA THREADNG
1091131	2	12 V	45 A induttivi / inductive	5.000	4	IP 66	- 40° C + + 85°C	M16x2 6g
1091132 17-0595-0000	50	24 V	20 A induttivi / inductive	5.000	4	IP 66	- 40° C + + 85°C	

Schema Elettrico
Wiring diagram

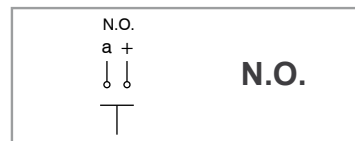
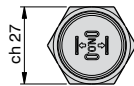

P/N	Q.ta Q.ty	TENS. NOMINALE NOMINAL VOLTAGE	CORRENTE MAX MAX CURRENT	N° CICLI N° LIFE CYCLES	N° CONTATTI N° CONTACTS	GRADO DI PROT. SEALING	TEMP. DI FUNZ. OPERATING TEMP.	FILETTATURA THREADNG
1091133	2	12 V	45 A induttivi / inductive	5.000	2	IP 66	- 40° C + + 85°C	M16x2 6g
1091134 17-0596-0000	50	24 V	20 A induttivi / inductive	5.000	2	IP 66	- 40° C + + 85°C	

PUSH BUTTON SWITCHES | per consenso avviamento for start-up consent

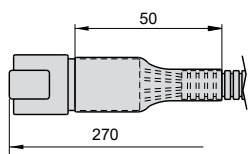
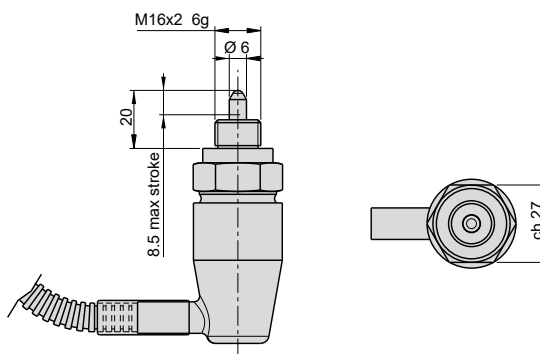

MALE CONNECTOR DEUTSCH 4 pins

Schema Elettrico
Wiring diagram

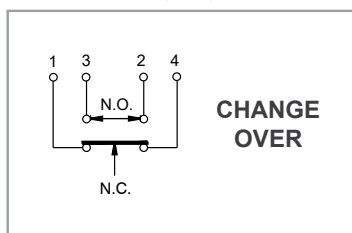

P/N	Q.ta Q.ty	TENS. NOMINALE NOMINAL VOLTAGE	CORRENTE MAX MAX CURRENT	N° CICLI N° LIFE CYCLES	N° CONTATTI N° CONTACTS	GRADO DI PROT. SEALING	TEMP. DI FUNZ. OPERATING TEMP.	FILETTATURA THREADING
1025423	5	12 V	45 A induttivi / <i>inductive</i>	5.000	4	IP 66	- 20° C + + 85°C	M16x2 6g
1025424 17-0276-0000	100	24 V	20 A induttivi / <i>inductive</i>	5.000	4	IP 66	- 20° C + + 85°C	

PUSH BUTTON SWITCHES

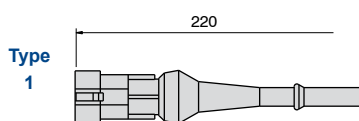
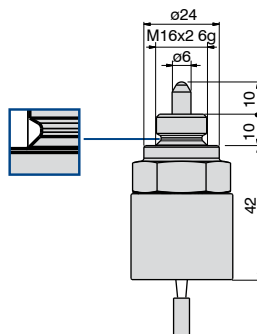

Type 1
FEMALE CONNECTOR AMP S/SEAL 2 pins

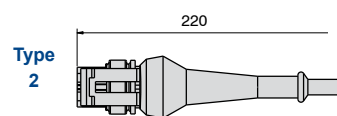

Type 2
MALE CONNECTOR AMP S/SEAL 2 pins

Schema Elettrico
Wiring diagram

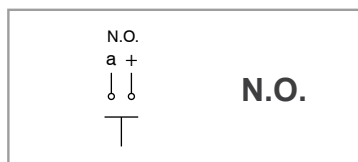

P/N	Q.ta Q.ty	TYPE	TENS. NOMINALE NOMINAL VOLTAGE	CORRENTE MAX MAX CURRENT	N° CICLI N° LIFE CYCLES	N° CONTATTI N° CONTACTS	GRADO DI PROT. SEALING	TEMP. DI FUNZ. OPERATING TEMP.	FILETTATURA THREADNG
1102787	1	1	12 V	45 A induttivi / <i>inductive</i>	5.000	2	IP 66	- 40° C + + 85°C	M16x2 6g
1102788 17-0602-0000	25		24 V	20 A induttivi / <i>inductive</i>	5.000	2	IP 66	- 40° C + + 85°C	
1104334	1	2	12 V	45 A induttivi / <i>inductive</i>	5.000	2	IP 66	- 40° C + + 85°C	M14x2 6g
1104335 17-0605-0000	25		24 V	20 A induttivi / <i>inductive</i>	5.000	2	IP 66	- 40° C + + 85°C	

PUSH BUTTON SWITCHES

NEW

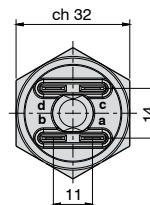
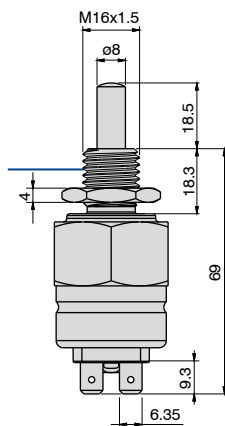

Schema Elettrico
Wiring diagram

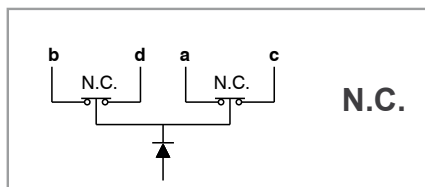

P/N	Q.ta Q.ty	TENS. NOMINALE NOMINAL VOLTAGE	CORRENTE NOMINALE NOMINAL CURRENT	N° CICLI N° LIFE CYCLES	N° CONTATTI N° CONTACTS	GRADO DI PROT. SEALING	TEMP. DI FUNZ. OPERATING TEMP.	FILETTATURA THREADING
1105521	1	12 V	1 A resistivi / resistive	75.000	4	IP 67	- 40° C + + 85°C	M16x1.5
1105508 17-0603-0000	25	-	-	-	-	-	-	

Schema Elettrico
Wiring diagram

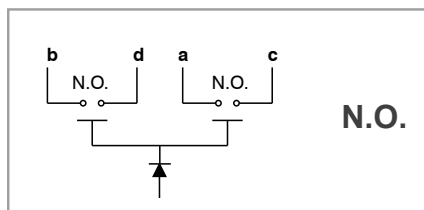

P/N	Q.ta Q.ty	TENS. NOMINALE NOMINAL VOLTAGE	CORRENTE MAX MAX CURRENT	N° CICLI N° LIFE CYCLES	N° CONTATTI N° CONTACTS	GRADO DI PROT. SEALING	TEMP. DI FUNZ. OPERATING TEMP.	FILETTATURA THREADING
1105522	1	12 V	1 A resistivi / resistive	75.000	4	IP 67	- 40° C + + 85°C	M16x1.5
1105509 17-0604-0000	25	-	-	-	-	-	-	

PUSH BUTTON SWITCHES | a sfera / ball

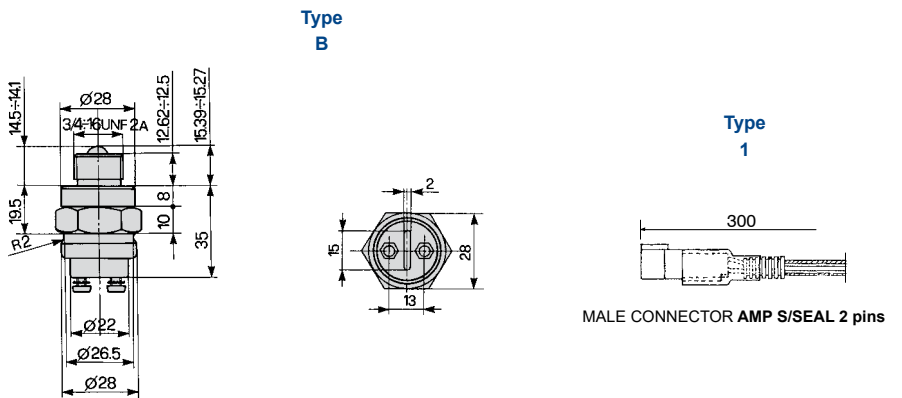
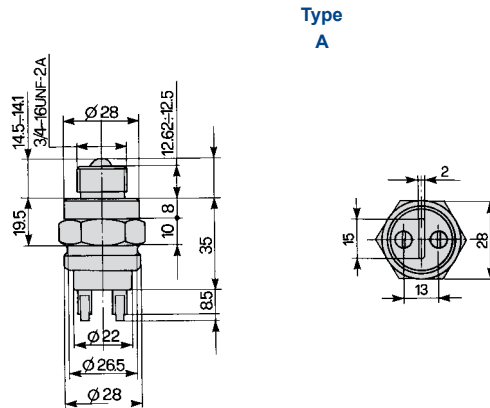

Schema Elettrico
Wiring diagram

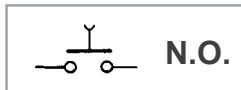

P/N	Q.ta Q.ty	TYPE	TENS. NOMINALE NOMINAL VOLTAGE	CORRENTE MAX MAX CURRENT	N° CICLI N° LIFE CYCLES	N° CONTATTI N° CONTACTS	GRADO DI PROT. SEALING	TEMP. DI FUNZ. OPERATING TEMP.	TYPE CONNESSIONE CONNECTION TYPE
1026307 17-177-000	5	A	12 V	20 A resistivi / resistive	100.000	2	IP 67	- 20° C ++ 40° C	-
			24 V	10 A resistivi / resistive	100.000	2	IP 67	- 20° C ++ 40° C	-
1026310 17-178-000	50	B	12 V	20 A resistivi / resistive	100.000	2	IP 67	- 20° C ++ 40° C	-
			24 V	10 A resistivi / resistive	100.000	2	IP 67	- 20° C ++ 40° C	-
1025593 17-0496-0000	50	B	12 V	9 A resistivi / resistive	100.000	2	IP 67	- 20° C ++ 40° C	1
			24 V	9 A resistivi / resistive	100.000	2	IP 67	- 20° C ++ 40° C	1

Schema Elettrico
Wiring diagram

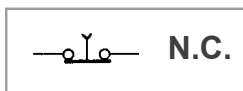

P/N	Q.ta Q.ty	TYPE	TENS. NOMINALE NOMINAL VOLTAGE	CORRENTE MAX MAX CURRENT	N° CICLI N° LIFE CYCLES	N° CONTATTI N° CONTACTS	GRADO DI PROT. SEALING	TEMP. DI FUNZ. OPERATING TEMP.	CAPPUCCHIO + CONNESSIONE CAP + CONNECTION
1026305 17-176-000	1	A	12 V	20 A resistivi / resistive	100.000	2	IP 67	- 20° C ++ 40° C	-
			24 V	10 A resistivi / resistive	100.000	2	IP 67	- 20° C ++ 40° C	-
1025592 17-0495-0000	50	B	12 V	9 A resistivi / resistive	100.000	2	IP 67	- 20° C ++ 40° C	1
			24 V	9 A resistivi / resistive	100.000	2	IP 67	- 20° C ++ 40° C	1

PUSH BUTTON SWITCHES

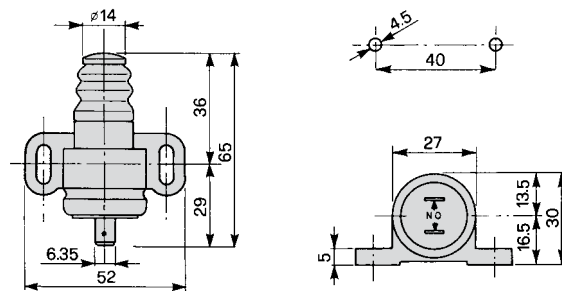

Schema Elettrico
Wiring diagram

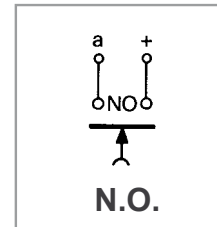

P/N	Q.ta Q.ty	TENS. NOMINALE NOMINAL VOLTAGE	CORRENTE MAX MAX CURRENT	N° CICLI N° LIFE CYCLES	N° CONTATTI N° CONTACTS	GRADO DI PROT. SEALING	TEMP. DI FUNZ. OPERATING TEMP.	CAPPUCCIO + CONNESSIONE CAP + CONNECTION
1026267	50	12 V	25 A induttivi / inductive	5.000	2	IP 67	- 20° C ++ 40° C	
1026268 17-161-000	84	24 V	15 A induttivi / inductive	5.000	2	IP 67	- 20° C ++ 40° C	
1025411 17-0262-0000	1	12 V	20 A induttivi / inductive	5.000	2	IP 67	- 20° C ++ 40° C	
		24 V	15 A induttivi / inductive	5.000	2	IP 67	- 20° C ++ 40° C	

PUSH BUTTON SWITCHES

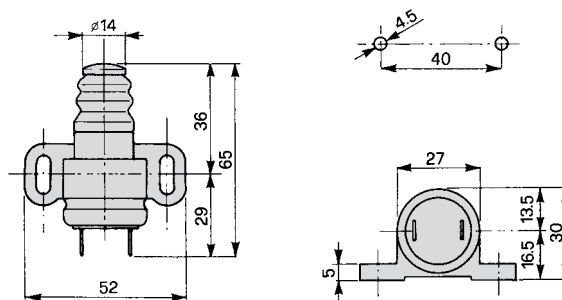

Schema Elettrico
Wiring diagram

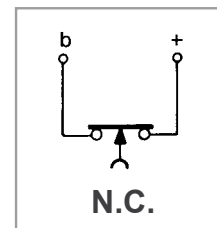

P/N	Q.ta Q.ty	TENS. NOMINALE NOMINAL VOLTAGE	CORRENTE MAX MAX CURRENT	N° CICLI N° LIFE CYCLES	N° CONTATTI N° CONTACTS	GRADO DI PROT. SEALING	TEMP. DI FUNZ. OPERATING TEMP.	NOTE
1026270 17-162-000	50	12 V	25 A induttivi / inductive	5.000	2	IP 67	- 20° C ++ 40° C	
		24 V	15 A induttivi / inductive	5.000	2	IP 67	- 20° C ++ 40° C	

PUSH BUTTON SWITCHES



Type A

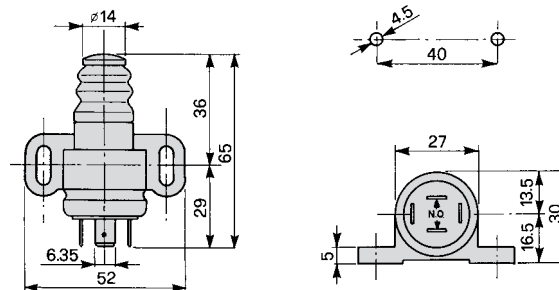

Type B

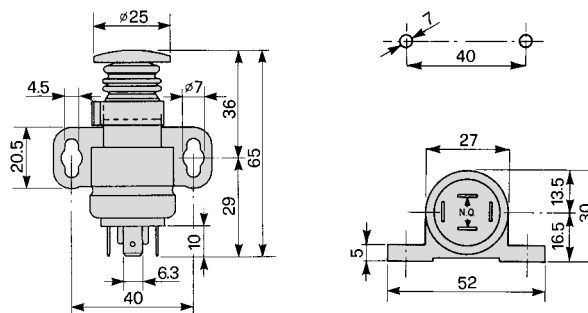

Schema Elettrico
Wiring diagram

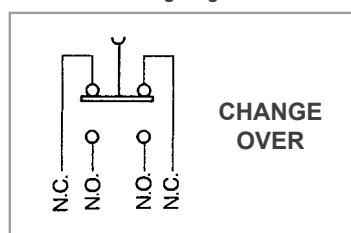

P/N	Q.ta Q.ty	TYPE	TENS. NOMINALE NOMINAL VOLTAGE	CORRENTE MAX MAX CURRENT	N° CICLI N° LIFE CYCLES	N° CONTATTI N° CONTACTS	GRADO DI PROT. SEALING	TEMP. DI FUNZ. OPERATING TEMP.	CAPPUCCIO CAP
1026264	50	A	12 V	25 A induttivi / inductive	5.000	4	IP 67	- 20° C ++ 40° C	
1026265 17-160-000	84		24 V	15 A induttivi / inductive	5.000	4	IP 67	- 20° C ++ 40° C	
1025385	50	A	12 V	25 A induttivi / inductive	5.000	4	IP 67	- 20° C ++ 40° C	
1025386 17-0243-0000	84		24 V	15 A induttivi / inductive	5.000	4	IP 67	- 20° C ++ 40° C	
1025645	1	B	12 V	25 A induttivi / inductive	5.000	4	IP 67	- 20° C ++ 40° C	
1025646 17-0561-0000	84		24 V	15 A induttivi / inductive	5.000	4	IP 67	- 20° C ++ 40° C	
1026352	5	B	12 V	30 A induttivi / inductive	5.000	4	IP 67	- 20° C ++ 40° C	
1026353 17-205-000	50		24 V	20 A induttivi / inductive	5.000	4	IP 67	- 20° C ++ 40° C	
1025387	5	B	12 V	30 A induttivi / inductive	5.000	4	IP 67	- 20° C ++ 40° C	
1025388 17-0244-0000	84		24 V	20 A induttivi / inductive	5.000	4	IP 67	- 20° C ++ 40° C	

SNAP-ACTION SWITCHES

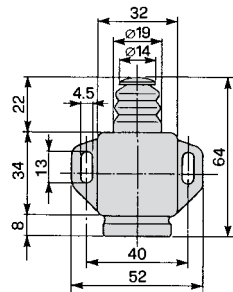

Type A

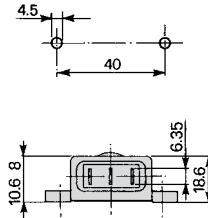

Schema Elettrico
Wiring diagram

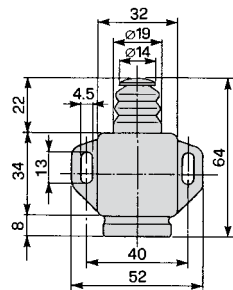
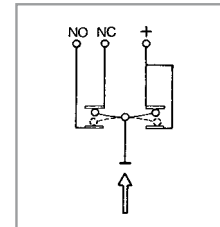

CABLE + CONNECTOR
Type B

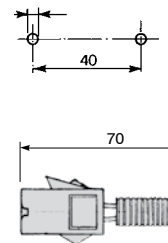

Schema Elettrico
Wiring diagram

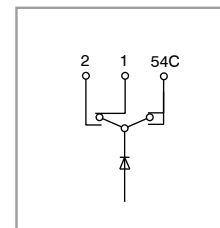

P/N	Q.ta Q.ty	TYPE	TENS. NOMINALE NOMINAL VOLTAGE	CORRENTE MAX MAX CURRENT	N° CICLI N° LIFE CYCLES	N° CONTATTI N° CONTACTS	GRADO DI PROT. SEALING	TEMP. DI FUNZ. OPERATING TEMP.	NOTE
1021514 1021515 15-110-000	10	A	12 V	12 A resistivi / resistive	100.000	3	IP 65	-20° C ++ 85° C	-
			12 V	5 A induttivi / inductive	100.000	3	IP 65	-20° C ++ 85° C	
	300		24 V	8 A resistivi / resistive	100.000	3	IP 65	-20° C ++ 85° C	
			24 V	3 A induttivi / inductive	100.000	3	IP 65	-20° C ++ 85° C	
1021552 15-129-000	2	B	12 V	12 A resistivi / resistive	100.000	3	IP 65	-20° C ++ 85° C	connettore + mastice
			12 V	5 A induttivi / inductive	100.000	3	IP 65	-20° C ++ 85° C	
			24 V	8 A resistivi / resistive	100.000	3	IP 65	-20° C ++ 85° C	connector + mastic
			24 V	3 A induttivi / inductive	100.000	3	IP 65	-20° C ++ 85° C	

SNAP-ACTION SWITCHES | per indicatori d'arresto for brake lights

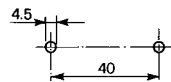
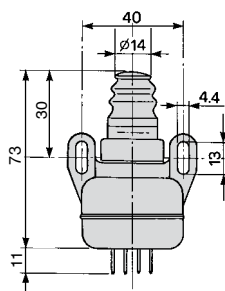

Schema Elettrico
Wiring diagram

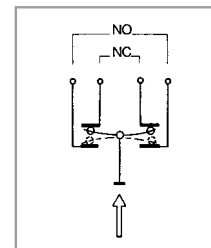

Type
A

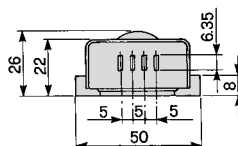

Type
B

Guarnizione in gomma
Rubber gasket

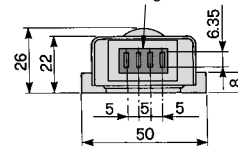

P/N	Q.ta Q.ty	TYPE	TENS. NOMINALE NOMINAL VOLTAGE	CORRENTE MAX MAX CURRENT	N° CICLI N° LIFE CYCLES	N° CONTATTI N° CONTACTS	GRADO DI PROT. SEALING	TEMP. DI FUNZ. OPERATING TEMP.	CAPPUCCIO CAP
1021530 1021531 15-117-000	5 200	A	12 V	12 A resistivi / resistive	100.000	4	IP 66	-20° C + +85° C	
			12 V	5 A induttivi / inductive	100.000	4	IP 66	-20° C + +85° C	
			24 V	8 A resistivi / resistive	100.000	4	IP 66	-20° C + +85° C	
			24 V	3 A induttivi / inductive	100.000	4	IP 66	-20° C + +85° C	
1021469 1021470 15-0160-0000	5 200	A	12 V	12 A resistivi / resistive	100.000	4	IP 66	-20° C + +85° C	
			12 V	5 A induttivi / inductive	100.000	4	IP 66	-20° C + +85° C	
			24 V	8 A resistivi / resistive	100.000	4	IP 66	-20° C + +85° C	
			24 V	3 A induttivi / inductive	100.000	4	IP 66	-20° C + +85° C	
1021474 1021475 15-0166-0000	5 200	B	12 V	12 A resistivi / resistive	100.000	4	IP 67	-20° C + +85° C	
			12 V	5 A induttivi / inductive	100.000	4	IP 67	-20° C + +85° C	
			24 V	8 A resistivi / resistive	100.000	4	IP 67	-20° C + +85° C	
			24 V	3 A induttivi / inductive	100.000	4	IP 67	-20° C + +85° C	

SNAP-ACTION SWITCHES

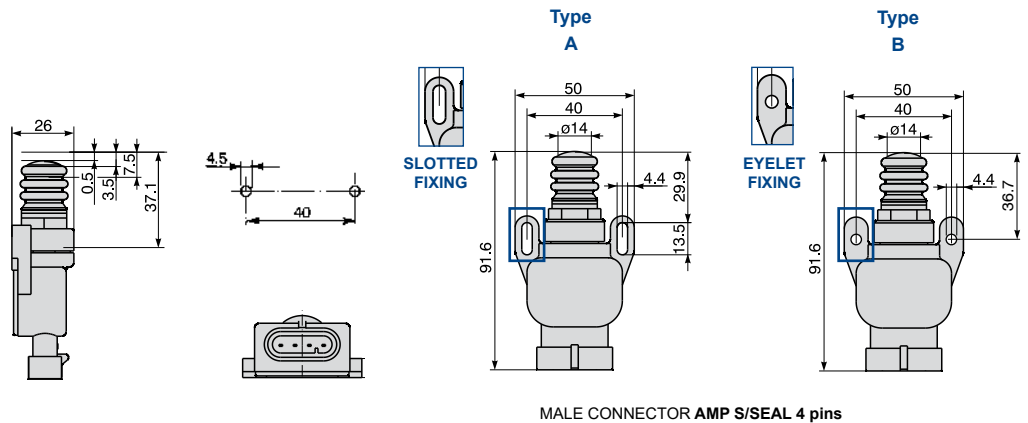

MALE CONNECTOR AMP S/SEAL 4 pins

Schema Elettrico
Wiring diagram

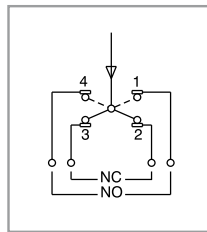

P/N	Q.ta Q.ty	TYPE	TENS. NOMINALE NOMINAL VOLTAGE	CORRENTE MAX MAX CURRENT	N° CICLI N° LIFE CYCLES	N° CONTATTI N° CONTACTS	GRADO DI PROT. SEALING	TEMP. DI FUNZ. OPERATING TEMP.	CAPPUCCIO CAP
1021477	5	A	12 V	12 A resistivi / resistive	200.000	4	IP 67	-20° C ++ 85°C	
1021478	150		12 V	5 A induttivi / inductive	50.000	4	IP 67	-20° C ++ 85°C	
15-0167-0000			12 V	12 A carico lampada / load lamp	40.000	4	IP 67	-20° C ++ 85°C	
1057946	5	A	12 V	12 A resistivi / resistive	200.000	4	IP 67	-20° C ++ 85°C	
1057947	150		12 V	5 A induttivi / inductive	50.000	4	IP 67	-20° C ++ 85°C	
15-0190-0000			12 V	12 A carico lampada / load lamp	40.000	4	IP 67	-20° C ++ 85°C	
1021490	5	B	12 V	12 A resistivi / resistive	200.000	4	IP 67	-20° C ++ 85°C	
1021491	150		12 V	5 A induttivi / inductive	50.000	4	IP 67	-20° C ++ 85°C	
15-0175-0000			12 V	12 A carico lampada / load lamp	40.000	4	IP 67	-20° C ++ 85°C	

SNAP-ACTION SWITCHES | per indicatori d'arresto for brake lights

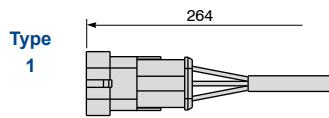
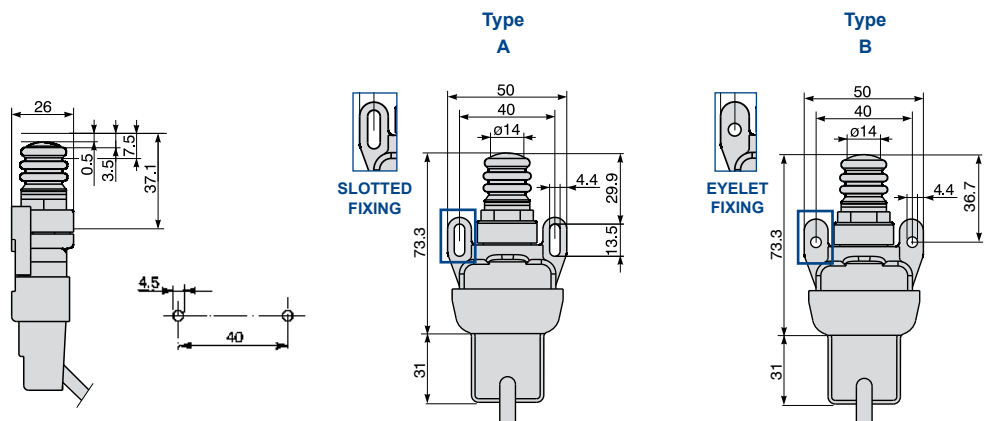

FEMALE CONNECTOR AMP S/SEAL 3 pins

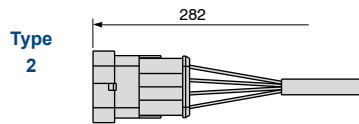

FEMALE CONNECTOR AMP S/SEAL 4 pins

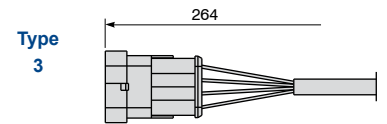

FEMALE CONNECTOR AMP S/SEAL 4 pins

Schema Elettrico Wiring diagram

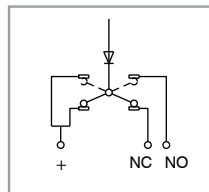

P/N	Q.ta Q.ty	TYPE	TENS. NOMINALE NOMINAL VOLTAGE	CORRENTE MAX MAX CURRENT	N° CICLI N° LIFE CYCLES	N° CONTATTI N° CONTACTS	GRADO DI PROT. SEALING	TEMP. DI FUNZ. OPERATING TEMP.	TYPE CONNESSIONE CONNECTION TYPE
1021562	10	A	12 V	12 A resistivi / <i>resistive</i>	100.000	3	IP 66	- 20° C ++ 85°C	1
1021563	50		12 V	5 A induttivi / <i>inductive</i>	100.000	3	IP 66	- 20° C ++ 85°C	
15-133-000									

Schema Elettrico Wiring diagram

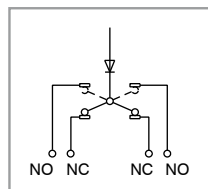

P/N	Q.ta Q.ty	TYPE	TENS. NOMINALE NOMINAL VOLTAGE	CORRENTE MAX MAX CURRENT	N° CICLI N° LIFE CYCLES	N° CONTATTI N° CONTACTS	GRADO DI PROT. SEALING	TEMP. DI FUNZ. OPERATING TEMP.	TYPE CONNESSIONE CONNECTION TYPE
1021599	2	A	12 V	12 A resistivi / <i>resistive</i>	100.000	4	IP 66	- 20° C ++ 85°C	2
1021600	50		12 V	5 A induttivi / <i>inductive</i>	100.000	4	IP 66	- 20° C ++ 85°C	
15-154-000									
1021480	5	A	12 V	12 A resistivi / <i>resistive</i>	100.000	4	IP 67	- 20° C ++ 85°C	3
1021481	50		12 V	5 A induttivi / <i>inductive</i>	100.000	4	IP 67	- 20° C ++ 85°C	
15-0169-0000									
1021492	5	B	12 V	12 A resistivi / <i>resistive</i>	100.000	4	IP 67	- 20° C ++ 85°C	3
1021493	50		12 V	5 A induttivi / <i>inductive</i>	100.000	4	IP 67	- 20° C ++ 85°C	
15-0176-0000									

SNAP-ACTION SWITCHES | autoregolante self-adjusting

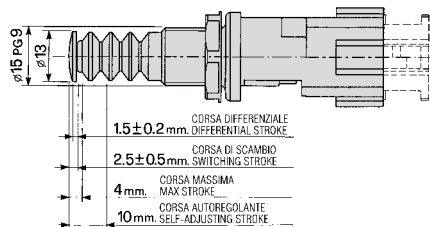

MALE CONNECTOR 4 pins

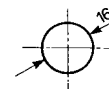
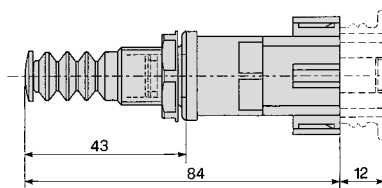
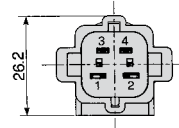

Schema Elettrico
Wiring diagram

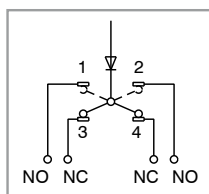

P/N	Q.ta Q.ty	TYPE	TENS. NOMINALE NOMINAL VOLTAGE	CORRENTE MAX MAX CURRENT	N° CICLI N° LIFE CYCLES	N° CONTATTI N° CONTACTS	GRADO DI PROT. SEALING	TEMP. DI FUNZ. OPERATING TEMP.	CAPPUCCIO CAP
1021597 15-153-000	10	-	12 V	8 A resistivi / resistive	-	4	IP 66	- 40° C + + 85° C	-
			24 V	4 A resistivi / resistive	-	4	IP 66	- 40° C + + 85° C	

SNAP-ACTION SWITCHES | autoregolante self-adjusting



MALE CONNECTOR 4 pins

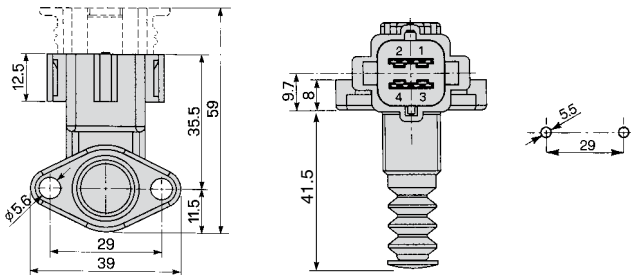

Schema Elettrico Wiring diagram

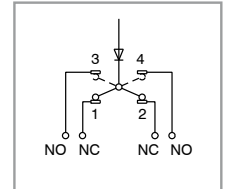

STROKE LENGTH Type A

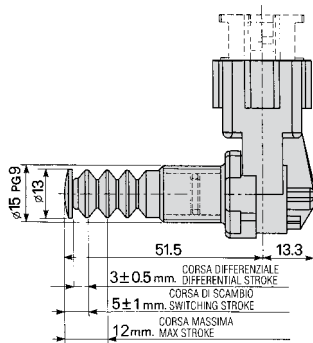

STROKE LENGTH Type B

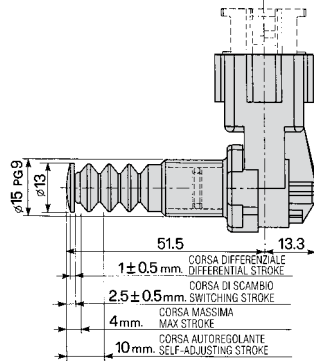

STROKE LENGTH + NUT Type C

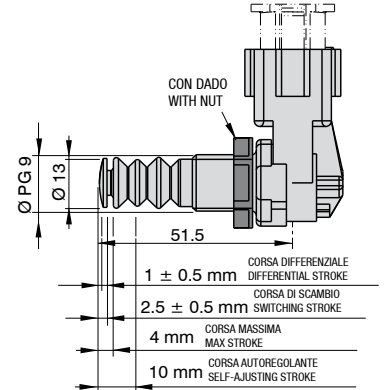

P/N	Q.ta Q.ty	TYPE	TENS. NOMINALE NOMINAL VOLTAGE	CORRENTE MAX MAX CURRENT	N° CONTATTI N° CONTACTS	GRADO DI PROT. SEALING	TEMP. DI FUNZ. OPERATING TEMP.	NOTE NOTES
1021607	10	A	12 V	8 A resistivi / resistive	4	IP 66	- 40° C + + 85°C	
1021608 15-158-000	100		24 V	4 A resistivi / resistive	4	IP 66	- 40° C + + 85°C	
1021486	10	A	12 V	8 A resistivi / resistive	4	IP 66	- 40° C + + 85°C	Connettore con tappo di protezione Connector with protection plug
1021487 15-0173-0000	100		24 V	4 A resistivi / resistive	4	IP 66	- 40° C + + 85°C	
1021592	10	B	12 V	8 A resistivi / resistive	4	IP 66	- 40° C + + 85°C	
1021593 15-151-000	100		24 V	4 A resistivi / resistive	4	IP 66	- 40° C + + 85°C	
1108363 15-0197-0000	10	C	12 V	8 A resistivi / resistive	4	IP 66	- 40° C + + 85°C	Con dado With nut
			24 V	4 A resistivi / resistive	4	IP 66	- 40° C + + 85°C	

SNAP-ACTION SWITCHES **HEAVY DUTY** | autoregolante self-adjusting

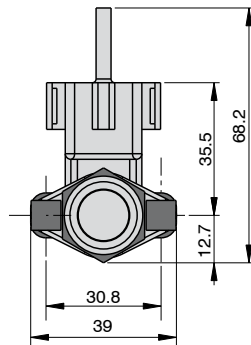

MALE CONNECTOR 4 pins

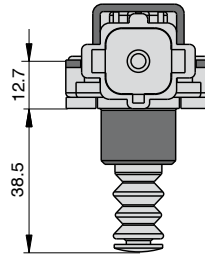

Schema Elettrico
Wiring diagram

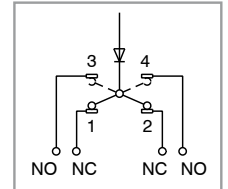

STROKE LENGTH
Type A

THREADED ADAPTER WITH ZINC PLATING
(corrosion resistance > 300 H)

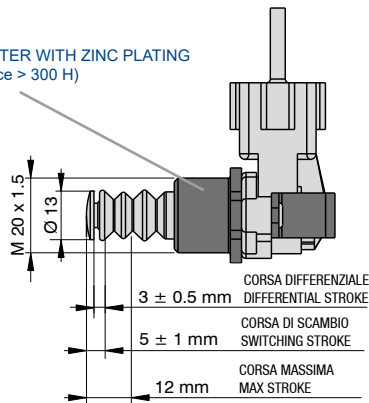

P/N	Q.ta Q.ty	TYPE	TENS. NOMINALE NOMINAL VOLTAGE	CORRENTE MAX MAX CURRENT	N° CONTATTI N° CONTACTS	GRADO DI PROT. SEALING	TEMP. DI FUNZ. OPERATING TEMP.	NOTE NOTES
1021488	10	A	12 V	8 A resistivi / resistive	4	IP 66	- 40° C ++ 85°C	Connettore con tappo di protezione Connector with protection plug
1021489 15-0174-0000	100		24 V	4 A resistivi / resistive	4	IP 66	- 40° C ++ 85°C	

FOOT DIMMER SWITCHES | STEP BY STEP



SENZA CAPPuccio - WITHOUT RUBBER BOOT

Type A

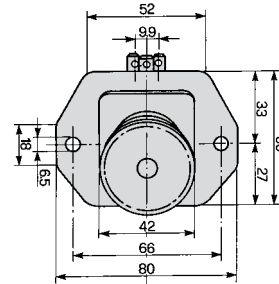
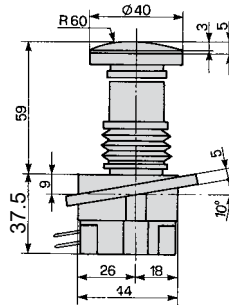

CON CAPPuccio - WITH RUBBER BOOT

Type B

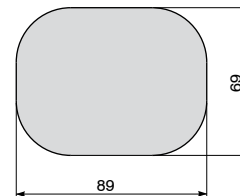
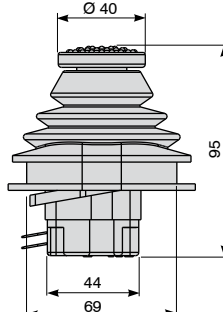

Schema Elettrico
Wiring diagram

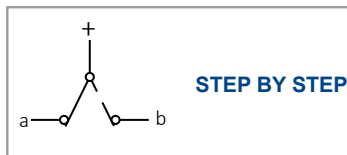

STEP BY STEP

P/N	Q.ta Q.ty	TYPE	TENS. NOMINALE NOMINAL VOLTAGE	CORRENTE MAX MAX CURRENT	N° CICLI N° LIFE CYCLES	N° CONTATTI N° CONTACTS	GRADO DI PROT. SEALING	TEMP. DI FUNZ. OPERATING TEMP.	TYPE CONNESSIONE CONNECTION TYPE
1002416	1	B	12 V	12 A resistivi / resistive	100.000	3	IP 66	-20° C ++ 40° C	-
1023809	25		12 V	8 A induttivi / inductive	100.000	3	IP 66	-20° C ++ 40° C	
16-182-000			24 V	8 A resistivi / resistive	100.000	3	IP 66	-20° C ++ 40° C	
			24 V	5 A induttivi / inductive	100.000	3	IP 66	-20° C ++ 40° C	

Con trattamento di cataforesi nera sui componenti in zama: permette un'alta resistenza alla corrosione, e agli agenti atmosferici e chimici.
With black cathaphoresis treatment on zama components: allows high resistance to corrosion, atmospheric and chemical agents.

P/N	Q.ta Q.ty	TYPE	TENS. NOMINALE NOMINAL VOLTAGE	CORRENTE MAX MAX CURRENT	N° CICLI N° LIFE CYCLES	N° CONTATTI N° CONTACTS	GRADO DI PROT. SEALING	TEMP. DI FUNZ. OPERATING TEMP.	TYPE CONNESSIONE CONNECTION TYPE
2189428 16-0590-0100	1	A	12 V	12 A resistivi / resistive	100.000	3	IP 66	-20° C ++ 40° C	-
			12 V	8 A induttivi / inductive	100.000	3	IP 66	-20° C ++ 40° C	
			24 V	8 A resistivi / resistive	100.000	3	IP 66	-20° C ++ 40° C	
			24 V	5 A induttivi / inductive	100.000	3	IP 66	-20° C ++ 40° C	
1109841 16-0590-0000	1	B	12 V	12 A resistivi / resistive	100.000	3	IP 66	-20° C ++ 40° C	-
			12 V	8 A induttivi / inductive	100.000	3	IP 66	-20° C ++ 40° C	
			24 V	5 A induttivi / inductive	100.000	3	IP 66	-20° C ++ 40° C	

FOOT DIMMER SWITCHES | MOMENTARY



SENZA CAPPuccio - WITHOUT RUBBER BOOT

Type A

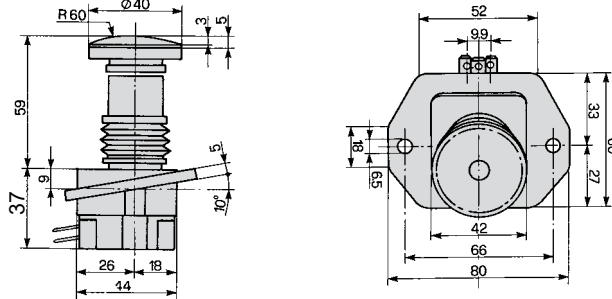

CON CAPPuccio - WITH RUBBER BOOT

Type B

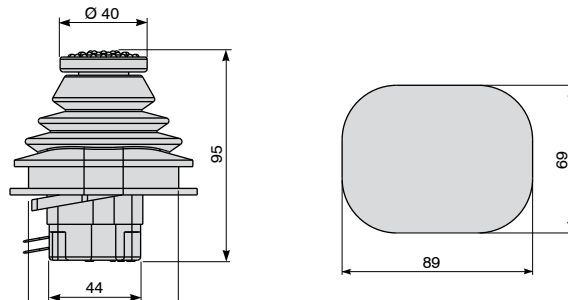

Type 1

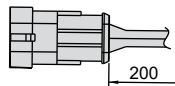

MALE CONNECTOR AMP S/SEAL 3 pins

Type 2

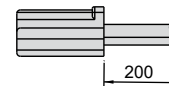

PACKARD CONNECTOR 3 pins

Schema Elettrico
Wiring diagram

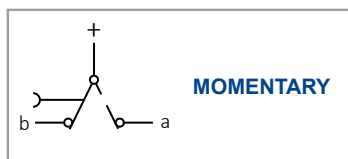

P/N	Q.ta Q.ty	TYPE	TENS. NOMINALE NOMINAL VOLTAGE	CORRENTE MAX MAX CURRENT	N° CICLI N° LIFE CYCLES	N° CONTATTI N° CONTACTS	GRADO DI PROT. SEALING	TEMP. DI FUNZ. OPERATING TEMP.	TYPE CONNESSIONE CONNECTION TYPE
1026347 1026348 17-199-100	1	A	12 V	12 A resistivi / resistive	100.000	3	IP 66	-20° C ++ 40° C	-
			12 V	8 A induttivi / inductive	100.000	3	IP 66	-20° C ++ 40° C	
	20		24 V	8 A resistivi / resistive	100.000	3	IP 66	-20° C ++ 40° C	
			24 V	5 A induttivi / inductive	100.000	3	IP 66	-20° C ++ 40° C	
1057272 17-0577-0000	1	A	12 V	12 A resistivi / resistive	100.000	3	IP 66	-20° C ++ 40° C	1
			12 V	8 A induttivi / inductive	100.000	3	IP 66	-20° C ++ 40° C	
			24 V	8 A resistivi / resistive	100.000	3	IP 66	-20° C ++ 40° C	
			24 V	5 A induttivi / inductive	100.000	3	IP 66	-20° C ++ 40° C	
1080747 1080748 17-0588-0000	1	A	12 V	12 A resistivi / resistive	100.000	3	IP 66	-20° C ++ 40° C	2
			12 V	8 A induttivi / inductive	100.000	3	IP 66	-20° C ++ 40° C	
	20		24 V	8 A resistivi / resistive	100.000	3	IP 66	-20° C ++ 40° C	
			24 V	5 A induttivi / inductive	100.000	3	IP 66	-20° C ++ 40° C	
1026345 1026346 17-199-000	1	B	12 V	12 A resistivi / resistive	100.000	3	IP 66	-20° C ++ 40° C	-
			12 V	8 A induttivi / inductive	100.000	3	IP 66	-20° C ++ 40° C	
	25		24 V	8 A resistivi / resistive	100.000	3	IP 66	-20° C ++ 40° C	
			24 V	5 A induttivi / inductive	100.000	3	IP 66	-20° C ++ 40° C	

FOOT DIMMER SWITCHES | STEP BY STEP

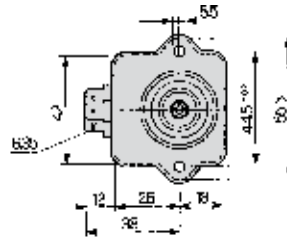
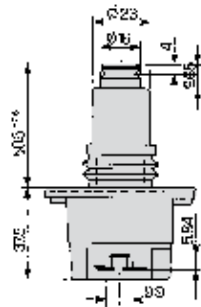

Schema Elettrico
Wiring diagram



STEP BY STEP

P/N	Q.ta Q.ty	TYPE	TENS. NOMINALE NOMINAL VOLTAGE	CORRENTE MAX MAX CURRENT	N° CICLI N° LIFE CYCLES	N° CONTATTI N° CONTACTS	GRADO DI PROT. SEALING	TEMP. DI FUNZ. OPERATING TEMP.	TYPE CONNESSIONE CONNECTION TYPE
1023805	1		12 V	12 A resistivi / resistive	100.000	3	IP 66	- 20° C ++ 40°C	
1023806	60		12 V	8 A induttivi / inductive	100.000	3	IP 66	- 20° C ++ 40°C	
16-181-000			24 V	8 A resistivi / resistive	100.000	3	IP 67	- 20° C ++ 40°C	
			24 V	5 A induttivi / inductive	100.000	3	IP 66	- 20° C ++ 40°C	

FOOT DIMMER SWITCHES | MOMENTARY

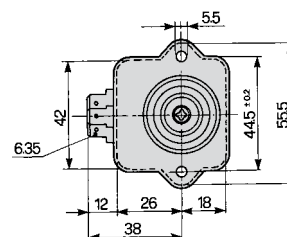
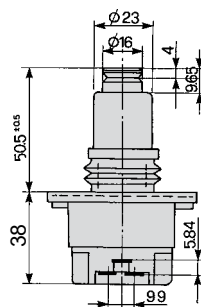

Schema Elettrico
Wiring diagram

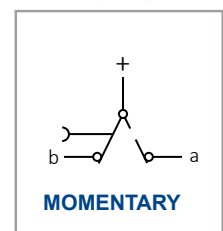

MOMENTARY

P/N	Q.ta Q.ty	TYPE	TENS. NOMINALE NOMINAL VOLTAGE	CORRENTE MAX MAX CURRENT	N° CICLI N° LIFE CYCLES	N° CONTATTI N° CONTACTS	GRADO DI PROT. SEALING	TEMP. DI FUNZ. OPERATING TEMP.	TYPE CONNESSIONE CONNECTION TYPE
1026340	1		12 V	12 A resistivi / resistive	100.000	3	IP 66	- 20° C ++ 40°C	
1026341	50		12 V	8 A induttivi / inductive	100.000	3	IP 66	- 20° C ++ 40°C	
17-194-000			24 V	8 A resistivi / resistive	100.000	3	IP 67	- 20° C ++ 40°C	
			24 V	5 A induttivi / inductive	100.000	3	IP 66	- 20° C ++ 40°C	

ACCESSORIES

Cappuccio di protezione
Protection cap



P/N	Q.ta Q.ty
1021504	10
1021505	100
15-104-005	

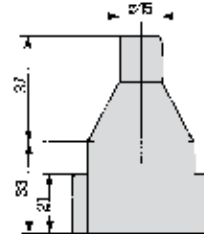
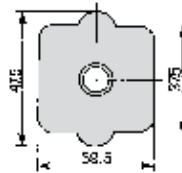

Cappuccio di protezione
Protection cap



P/N	Q.ta Q.ty
1021506	10
1021507	100
15-105-007	

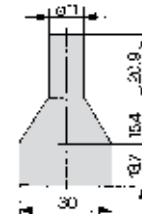
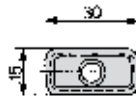

Cappuccio di protezione
Protection cap



P/N	Q.ta Q.ty
1026106	10
1026107	100
17-111-001	

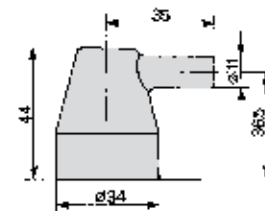
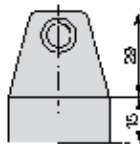

Cappuccio di protezione
Protection cap



P/N	Q.ta Q.ty
1021533	5
1021534	100
15-117-103	

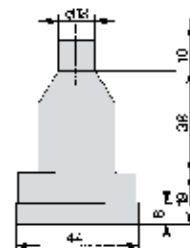
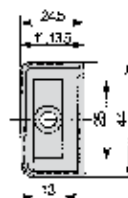

ACCESSORIES

Cappuccio di protezione
Protection cap



P/N	Q.ta Q.ty
1026136	10
1026137	100
17-122-004	

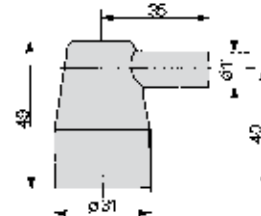
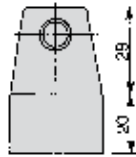

Connettore per capocorda femmina serie 6,35 mm con linguetta 4 vie
4 pins connector 6.35 mm series female terminal



P/N	Q.ta Q.ty
1030010	100
30-16-03826	

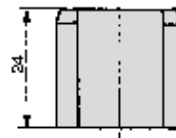
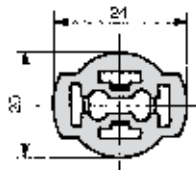

Connettore per capocorda femmina serie 6,35 mm con linguetta 4 vie
4 pins connector 6.35 mm series female terminal



P/N	Q.ta Q.ty
1030013	50
30-16-04050	

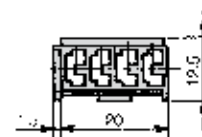
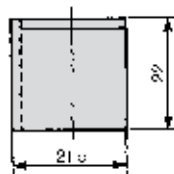

Kit di connessione femmina 4 vie con guarnizione passacavo Superseals
Connection kit 4 pins female with rubber grommet Superseals



P/N	Q.ta Q.ty
1028551	2
27-0943-0000	

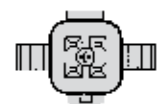
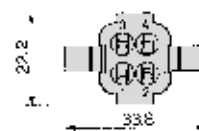

ACCESSORIES

Connettore femmina 4 vie con guarnizione passacavo Superseals
4 pins female connector with rubber grommet Superseals



P/N	Q.ta Q.ty
1030051	10
1030052	100
30-16-06497	

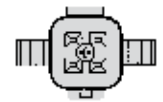
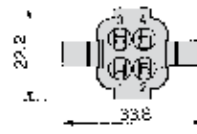
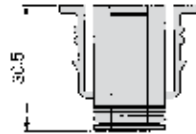

Kit di connessione maschio Superseals 2 vie
Connection kit male 2 pins Superseals



P/N	Q.ta Q.ty
1028565	1
27-0958-0000	

Kit di connessione maschio Superseals 3 vie
Connection kit male 3 pins Superseals



P/N	Q.ta Q.ty
1028518	1
27-0905-0000	

Kit di connessione maschio Superseals 4 vie
Connection kit male 4 pins Superseals



P/N	Q.ta Q.ty
1028520	1
27-0906-0000	

Kit di connessione femmina Superseals 2 vie
Connection kit female 2 pins Superseals



P/N	Q.ta Q.ty
1028566	1
27-0958-5000	

Kit di connessione femmina Superseals 3 vie
Connection kit female 3 pins Superseals



P/N	Q.ta Q.ty
1028519	1
27-0905-5000	



Kit di connessione femmina Deutsch 4 vie
Connection kit female 4 pins Deutsch



P/N	Q.ta Q.ty
1028523	1
27-0907-5000	

Cappuccio di protezione
Protection cap



P/N	COLORE COLOR	Q.ta Q.ty
1026242 17-153-001		100
1026243 17-153-002		100
1026244 17-153-003		100

pagina page	pagina page	pagina page	pagina page	pagina page	pagina page
100241636	102538827	10262406	103005142		
10036874	102538916	10262416	103005242		
102146929	102539016	1026242 43	105723411		
102147029	102539114	1026243 43	105727237		
102147429	10253989	1026244 43	105794630		
102147529	10254009	102626427	105794730		
102147730	10254029	102626527	107865715		
102147830	10254039	102626726	107865815		
102147933	10254049	102626826	108074737		
102148031	102540414	102627026	108074837		
102148131	102540614	102628110	108800314		
102148634	102540714	102628620	109113121		
102148734	102540814	10262887	109113221		
102148835	102541013	102629012	109113321		
102148935	102541126	102629112	109113421		
102149030	10254125	102629319	110278723		
102149130	102541616	102629419	110278823		
102149231	10254179	102630319	110433423		
102149331	102541915	102630525	110433523		
102150440	102542322	102630725	110550824		
102150540	102542422	102631025	110550924		
102150640	102542520	102631811	110552124		
102150740	102542620	10263388	110552224		
102151428	10254275	102634038	110836334		
102151528	10254286	102634138	110984136		
102153029	102543120	102634537	11117905		
102153129	102559010	102634637	11117915		
102153340	102559225	102634737	200761418		
102153440	102559325	102634837	218942836		
102155228	102564527	102635012			
102156231	102564627	102635227			
102156331	10260894	102635327			
102158933	102610418	102635618			
102159033	102610518	10263586			
102159234	102610640	102637020			
102159334	102610740	102637120			
102159533	102611818	102638115			
102159732	10261317	102639117			
102159931	102613520	102639217			
102160031	102613641	102851842			
102160734	102613741	102851942			
102160834	10261396	102852042			
102380538	10261428	102852342			
102380638	10261438	102855141			
102380936	10261455	102856542			
102538527	10261515	102856642			
102538627	10261635	103001041			
102538727	102623420	103001341			

<i>pagina</i> <i>page</i>	<i>pagina</i> <i>page</i>	<i>pagina</i> <i>page</i>	<i>pagina</i> <i>page</i>	<i>pagina</i> <i>page</i>	<i>pagina</i> <i>page</i>
15-104-005	40	17-165-000	10	17-0576-0000	11
15-105-007	40	17-168-000	20	17-0577-0000	37
15-110-000	28	17-169-000	7	17-0587-0000	15
15-117-000	29	17-170-000	12	17-0588-0000	37
15-117-103	40	17-171-000	19	17-0595-0000	21
15-129-000	28	17-175-000	19	17-0596-0000	21
15-133-000	31	17-176-000	25	17-0602-0000	23
15-150-000	33	17-177-000	25	17-0603-0000	24
15-151-000	34	17-178-000	25	17-0604-0000	24
15-152-000	33	17-186-000	11	17-0605-0000	23
15-153-000	32	17-193-000	8	17-0606-0000	5
15-154-000	31	17-194-000	38	27-0905-0000	42
15-158-000	34	17-199-000	37	27-0905-5000	42
15-0160-0000	29	17-199-100	37	27-0906-0000	42
15-0166-0000	29	17-204-000	12	27-0907-5000	42
15-0167-0000	30	17-205-000	27	27-0943-0000	41
15-0168-0000	33	17-207-000	18	27-0958-0000	42
15-0169-0000	31	17-208-000	6	27-0958-5000	42
15-0173-0000	34	17-219-000	20	30-16-03826	41
15-0174-0000	35	17-227-000	15	30-16-04050	41
15-0175-0000	30	17-240-000	17	30-16-06497	42
15-0176-0000	31	17-0243-0000	27	AV-17-0003	4
15-0190-0000	30	17-0244-0000	27		
15-0197-0000	34	17-0247-0000	16		
16-181-000	38	17-0249-0000	14		
16-182-000	36	17-0253-0000	9		
16-0590-0000	36	17-0255-0000	9		
16-0590-0100	36	17-0256-0000	9		
17-105-000	4	17-0257-0000	9		
17-111-000	18	17-0258-0000	14		
17-111-001	40	17-0259-0000	14		
17-113-000	18	17-0261-0000	13		
17-120-000	7	17-0262-0000	26		
17-122-000	20	17-0263-0000	5		
17-122-004	41	17-0268-0000	16		
17-124-000	6	17-0269-0000	9		
17-125-000	8	17-0271-0000	15		
17-126-000	5	17-0276-0000	22		
17-130-000	5	17-0277-0000	20		
17-134-000	5	17-0278-0000	20		
17-151-000	20	17-0279-0000	5		
17-153-000	6	17-0282-0000	14		
17-153-001	43	17-0283-0000	6		
17-153-002	43	17-0286-0000	20		
17-153-003	43	17-0492-0000	10		
17-160-000	27	17-0495-0000	25		
17-161-000	26	17-0496-0000	25		
17-162-000	26	17-0561-0000	27		



C.O.B.O. SpA
Via Tito Speri, 10
25024 Leno (Brescia) ITALY
Phone +39 030 90451
Fax +39 030 9045330

GERMANY



COBO DEUTSCHLAND GmbH
Zum Schürmannsgraben, 12E
D-47441 - Moers
Germany
Phone: +49 (0) 2841 88238 0
Fax: +49 (0) 2841 88238 23
E-mail: info@cobogroup.net
Web Site: www.cobo-deutschland.com

FRANCE



COBO FRANCE Sarl
Allée de l'Europe, 2 - Zone Coriolis
71210 - Ecuisses
France
Phone: +33 (0) 3 857 30560
Fax: +33 (0) 3 857 85606
E-mail: info@cobogroup.net
Web Site: www.cobofrance.com

NORTH AMERICA



COBO USA Ltd
West Division Street, 304
52655 - West Burlington
Iowa - Usa
Phone: +1 319 754 5585
Fax: +1 319 754 8724
E-mail: info@cobogroup.net
Web Site: www.cobointernational.com

LATIN AMERICA



COBO COMPONENTES AGR. E IND. Ltda
Rua Dona Francisca, 8300 - Bloco 2-M
89219-600 Zona Industrial - Joinville
Santa Catarina - Brasil
Phone: +55 47 3305 0095
E-mail: info@cobogroup.net
Web Site: www.cobogroup.net

OCEANIA



COBO OCEANIA Ltd
Maiella Street, 4/12
4207 Stapylton - Brisbane
Queensland - Australia
Phone: +61 (0) 7 3807 4866
Fax: +61 (0) 7 3807 6780
E-mail: info@cobogroup.net
Web Site: www.cobo.com.au

SOUTH-EAST ASIA



COBO ASIA Ltd
Wai Yip Street, 133
11/F, 12/F and Roof Floor - Kwun Tong
Hong Kong
Phone: +852 3511 6708 (6709)
E-mail: info@cobogroup.net
Web Site: www.cobogroup.net

CHINA



COBO GUANGZHOU Ltd
101/102 Building 7, Shi Dai Fang Zhou
30 Hua Zhou Road, Haizhu District
510220 - Guangzhou
People's Republic of China
Phone: +86 20 8922 5611
Fax: +86 20 8922 5635
E-mail: info@cobogroup.net
Web Site: www.cobogroup.net

INDIA



COBO INDIA Ltd
Plot no I-74, Sector 32
DLF Industrial Area
121003 - Faridabad
Haryana - India
Phone: +91 129 4871206
Email: info@cobogroup.net
Web Site: www.cobogroup.net



info@cobogroup.net | www.cobogroup.net

Le informazioni contenute nella presente informativa hanno scopo puramente indicativo.
L'Azienda si riserva senza preavviso il diritto di apportare qualsiasi modifica tecnica del prodotto.
The information published in this catalogue is purely indicative. The Company reserves the right to introduce all technological changes of the present product at any time and without prior notice.