

FTL2 LINEAR DISPLACEMENT SENSOR

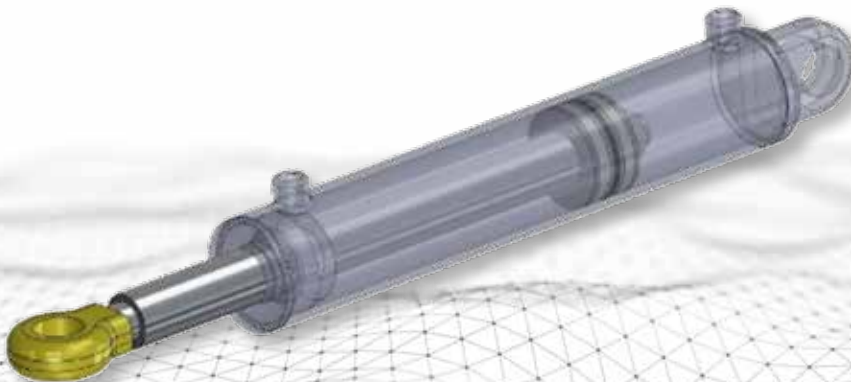

*Wear free magnetic technology.
CANbus for effective system integration.
Embedded diagnostic.*



FTL2 Linear sensor family allows effectively measure displacement of cylinders. Extremely compact housing allows minimal impact over cylinder redesign, improving overall total cost of system. Robust design makes this device an optimal solution on multiple off-highway applications. Smart logic, together with CANbus communication, allows flexible solutions with and without external ECU active management.

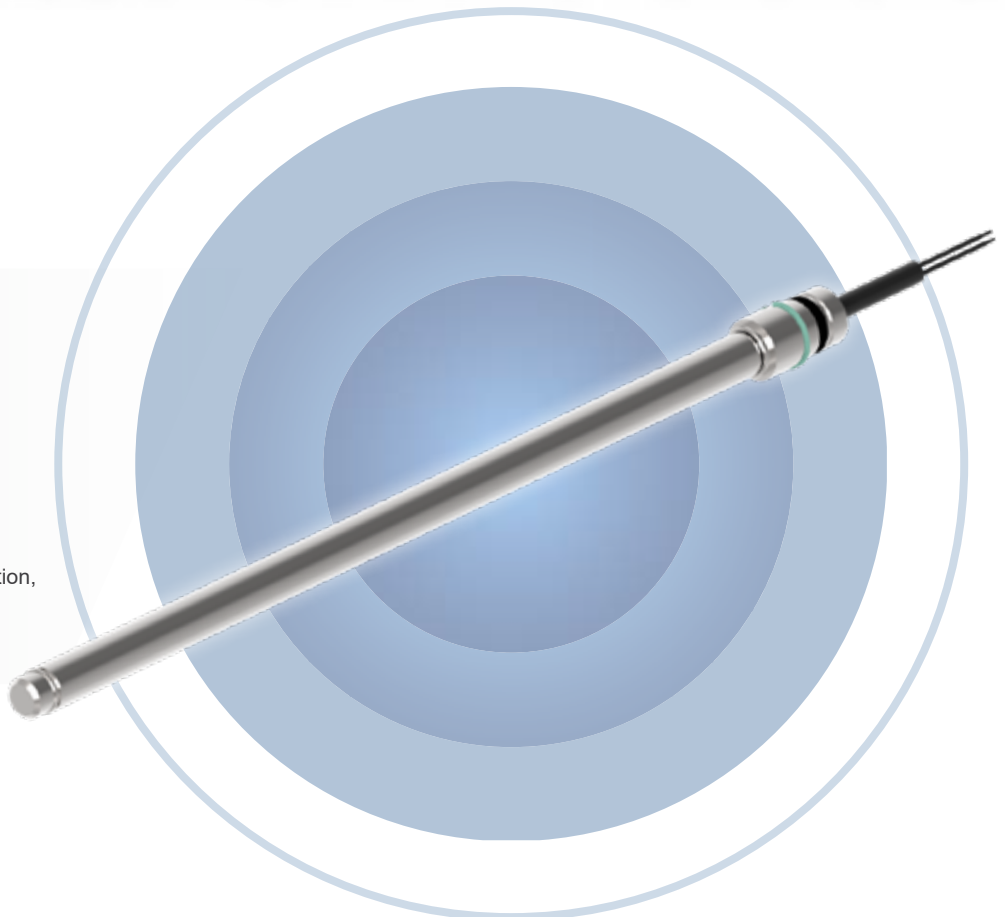

KEY VALUES



Shock proof



Magnetic technology

CAN

CANbus



IP68 protection class



Wide temperature range

Description

P/N

FTL2 570mm

1110456

Default Parameters:

ID node: 0x1F

Baud rate: 125kbps



FTL2 - (136mm STROKE)



FTL2 - (570mm STROKE)

APPLICATIONS



Material Handling
and Lifting Technology



Agricultural Machinery



Construction Equipment

TECHNICAL DATA

Measurement Range	up to 700mm
Supply voltage	+9-36Vdc.
Output signal	CANopen / CAN J1939
Resolution	up to 1mm
Working temperature	-40°C ... +105°C
Vibrations	20g between 10 Hz ... 2000 Hz IEC 60068-2-6.
Shock	Pulse on 3 axes; 50g 11 ms IEC 60068-2-27.
Electromagnetic compatibility	2014/30/EU Electromagnetic Compatibility (EMC).
Protection and immunity	Protected against reverse polarity and short circuit
IP Protection Level	IP68

All performance data are values resulting from qualification tests on specific configuration sample production batch.
Final product configuration, actual application and respect of installation recommendation may impact on some performance data.
Where not differently indicated, data refer to Tamb condition test environment.

DIMENSIONS

FTL2 - (136mm STROKE)

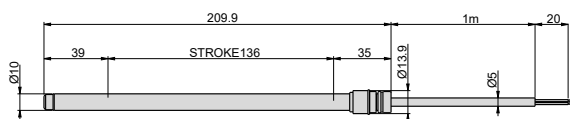

END CAP MOUNTING DETAIL

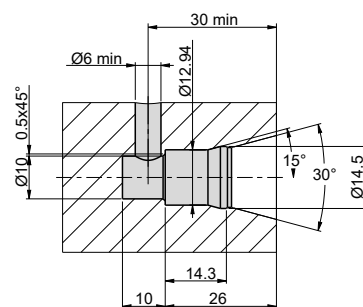

FTL2 - (570mm STROKE)

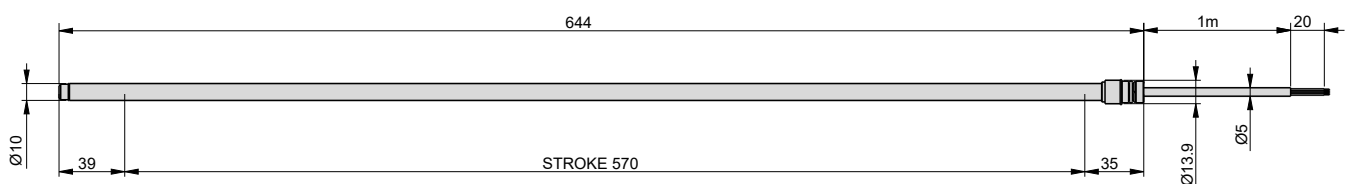

ORDERING KEY

FAMILY	SUBFAMILY	CASE MATERIAL	CONNECTOR	CHANNEL 1 RANGE (±)	CHANNEL 2 RANGE (±) AND VERSE	SUPPLY VOLTAGE	OUTPUT TYPE	SPECIAL / CUSTOM FEATURE / SW / CUSTOMER	MANUAL ZERO HALL PEN	FACTORY LINEARITY TABLE SUPPLIED	ACCESSORIES / MAGNET TYPE	PROJECT REVISION
LINEAR	2 in cylinder hall	S Steel	14 free cable 1m, 4 wires	L570 Linear 570mm	0NOT Single channel FTL	H 12-24Vdc nominal	051 CANopen standard	000 standard	0 not available (standard)	0 not supplied (standard)	000 not present	1
							061 CAN J1939				001 Magnet type 01	

EXAMPLE OF RESULTING ORDERING CODE

FTL2.A.14.L570.0NOT.H.051.000.0.0.000.1

Further possibilities available, some options are mutually exclusive, please contact our team for more details.